

Image may differ from product. See technical specification for details.

SY 504 M

Pillow block housing for insert bearings, cast iron, ISO standards

Pillow (plummer) block housings are designed to accommodate an insert bearing. The cast iron housings are strong, stiff and cost-effective. They are suitable for most applications and can be bolted directly to a support surface.

- Accommodate heavy loads in different directions
- High degree of stiffness
- Narrow design

Overview

Dimensions

Spherical seating diameter	47 mm
Centre height (pillow block)	33.3 mm
Housing overall width	32 mm
Centre distance between bolt holes	97 mm

Logistics

Product net weight	0.424 kg
eClass code	23-05-08-02
UNSPSC code	31171536

Properties

Housing type	Pillow block
Number of bolt holes for fasteners	2
Fastening bolt hole type	Plain
Material, housing	Cast iron
Coating	Without
Relubrication hole	With
Grease fitting	With

Technical specification

Material

Cast iron

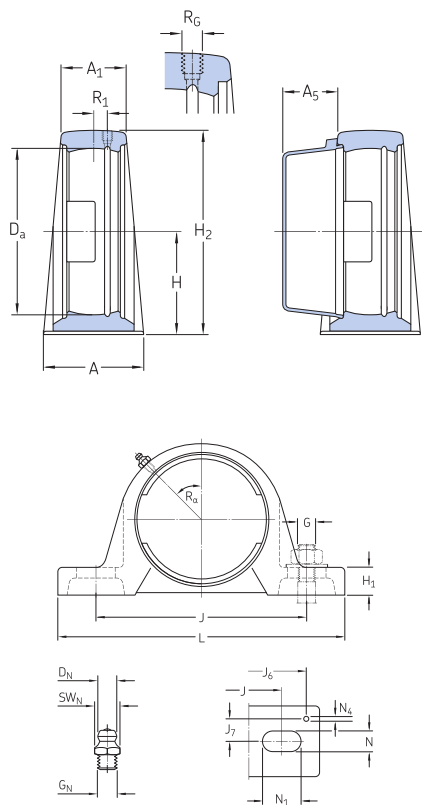

Dimensions

Da	47 mm	Diameter of spherical seat
A	32 mm	Base width
A ₁	21 mm	Top width
A ₅	20.5 mm	Standout of end cover
H	33.3 mm	Height of spherical seat centre
H ₁	14 mm	Foot height
H ₂	64.5 mm	Overall height
J	97 mm	Distance between attachment bolts
J	max. 106 mm	Distance between attachment bolts
J	min. 88 mm	Distance between attachment bolts
L	127 mm	Overall length
N	11.5 mm	Width of attachment bolt hole
N ₁	20.5 mm	Length of attachment bolt hole

THREADED HOLE

R _G	1/4-28 UNF	Housing thread for the grease fitting
R ₁	2 mm	Axial position of the housing thread
R _a	45 °	Angular position of the housing thread

GREASE FITTING

D _N	6.5 mm	Diameter of head sphere of grease fitting
SW _N	7 mm	Hexagonal key size for the grease fitting

	G _N	1/4-28 SAE-LT	Thread of the grease fitting
--	----------------	---------------	------------------------------

DOWEL PINS

J ₆	118 mm	Distance between dowel pins
J ₇	11.5 mm	Axial offset of dowel pins
N ₄	2 mm	Recommended diameter for dowel pins

Mass

Mass housing	0.41 kg
--------------	---------

Mounting information

Recommended diameter for attachment bolts, mm	G	10 mm
Recommended diameter for attachment bolts, inch	G	0.375 in

Associated products

End cover	↗ ECY 204
-----------	---

Compatible products

Recommended product

End cover for bearing units	ECY 204
-----------------------------	-------------------------