

Switching probe

SKS-215 002 180 A 1502 E

Item SKS-215-0082



GO TO PRODUCT

ingun[®]

Partner for Future Technology

- For a wide range of applications: performs components detection check, is a switch for detecting closed/open states, and a signal transmitter for process control
- The electrical connection is ensured by installation using a receptacle
- Designed as normally open (NO), i.e. The circuit is closed when actuated

INGUN SELECTION

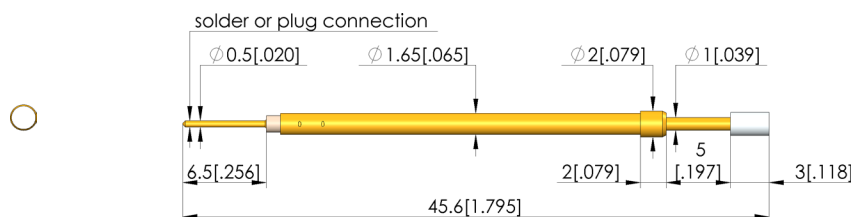
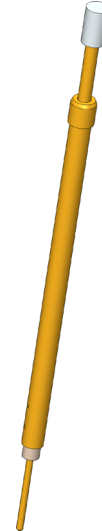

General data

Product group:	Switching probes
Sub-product group:	SKS (pressed-in)
Series:	SKS-215 E quick-exchange / plug system
Grid:	2.54 mm [100 mil]
Contacting from:	Presence check
Magnetic:	Yes
Installation type:	Plug-in
Quick-exchange system:	Yes
Type of test probe connection:	Plug
Adjustable installation height:	No
Non-rotating:	No
Compatible connector(s):	SE-415
Compatible receptacle(s):	KS-215, KS-215 S
Min. temperature:	- 40 °C [- 104 °F]
Max. temperature:	+ 80 °C [+ 176 °F]
RoHS-compliant:	RoHS-3;6c

Electrical data

Current load capacity / rated current:	3 A
--	-----

Mechanical data

Total length:	45.6 mm [1.79 in]
Barrel diameter:	1.65 mm [.064 in]
Maximum stroke:	5 mm [.196 in]
Spring pre-load:	0.25 N [.899 ozf]
Collar height:	02
Switch path:	1.5 mm [.059 in]
Switching point:	8.5 mm [.334 in]
Spring force at switching point:	0.45 N [1.61 ozf]

Tip style data

Tip style:	002 flat, contact surface insulated
Tip diameter:	1.8 mm [.070 in]
Tip style surface:	A gold
Tip style material:	0 plastic

INGUN Prüfmittelbau GmbH

Max-Stromeyer-Straße 162
78467, Constance, Germany
Phone +49 7531 8105-0
Customer hotline +49 7531 8105-888
Fax +49 7531 8105-65
info@ingun.com



Prices and delivery times on request.
Technical changes reserved. 04/24_GB

Learn more about
Test probes



ingun.com