

# Switching probe

## SKS-115 002 300 A 3002 M

Item SKS-115-0012



GO TO PRODUCT

**ingun**<sup>®</sup>

Partner for Future Technology

- For a wide range of applications: performs components detection check, is a switch for detecting closed/open states, and a signal transmitter for process control
- Various collar heights are available on the receptacles to adjust the installation height
- The installation height can be varied, and the position of the switching point can be precisely adjusted via the probe's thread. The SKS is secured in the correct position by crimp point in the KS.
- The electrical connection is ensured by installation using a receptacle

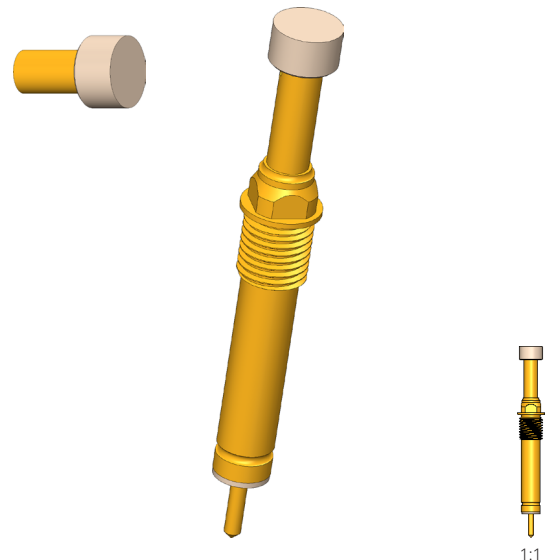

1:1

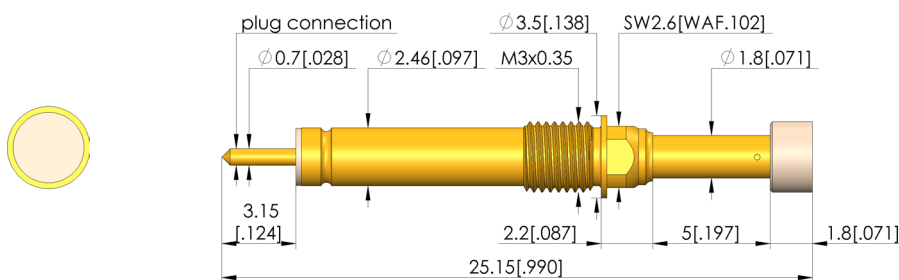

### General data

Product group:  
Sub-product group:  
Series:  
Grid:  
Contacting from:  
Magnetic:  
Installation type:  
Quick-exchange system:  
Adjustable installation height:  
Non-rotating:  
Screw-in torque:  
Compatible receptacle(s):  
Min. temperature:  
Max. temperature:  
RoHS-compliant:

Switching probes  
SKS (screwed-in)  
SKS-115 M screw-in  
4 mm [157 mil]  
Presence check  
Yes  
Screw-in  
Yes  
No  
No  
3 - 5 cNm [.265 - .442 lbf·in]  
KS-115 M  
- 40 °C [- 104 °F]  
+ 80 °C [+ 176 °F]  
RoHS-3;6c

### Mechanical data

Total length:  
Barrel diameter:  
Maximum stroke:  
Spring pre-load:  
Collar height:  
Switch path:  
Switching point:  
Spring force at switching point:

25.15 mm [.990 in]  
2.46 mm [.096 in]  
5 mm [.196 in]  
0.84 N [3.02 ozf]  
02  
1.7 mm [.066 in]  
7.3 mm [.287 in]  
1.44 N [5.17 ozf]

### Tip style data

Tip style:  
Tip diameter:  
Tip style surface:  
Tip style material:

002 flat, contact surface insulated  
3 mm [.118 in]  
A gold  
0 plastic

### Electrical data

Current load capacity / rated current: 3 A

### INGUN Prüfmittelbau GmbH

Max-Stromeyer-Straße 162  
78467, Constance, Germany  
Phone +49 7531 8105-0  
Customer hotline +49 7531 8105-888  
Fax +49 7531 8105-65  
info@ingun.com



Prices and delivery times on request.  
Technical changes reserved. 04/24\_GB

Learn more about  
Test probes



ingun.com