

PANEL MOUNTING
MAX. PANEL THICKNESS 8.0mm

Ø14.90
[.587 in]
Ø22.00
[.866 in]

▲ RAISED FLAT ACTUATOR
POLISHED STAINLESS STEEL

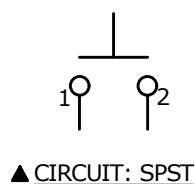

SWITCH FUNCTION	
POS. 1	POS. 2
OFF	(ON)
OPEN	1-2

(ON) = MOMENTARY

NOTE:

1. ALL DIMENSIONS IN MM [INCH]
2. GENERAL TOLERANCE: X.X = ± 0.4
X.XX = ± 0.25
3. TERMINAL NOS. FOR REF. ONLY
- ▲ 4. FUNCTION: SPST
- ▲ 5. RATING: 2A @ 36VDC
6. CONTACT RESISTANCE: 50mΩ MAX. @ 1A 12VDC
7. INSULATION RESISTANCE: 1,000MΩ @ 500VDC
8. DIELECTRIC STRENGTH: 2,000VAC MIN. FOR 1 MINUTE
9. ELECTRICAL LIFE: 200,000 CYCLES
10. CONTACT MATERIAL: SILVER PLATED COPPER
11. OPERATING TEMPERATURE: -20°C TO 55°C
12. INGRESS PROTECTION: IP65
13. ▲ DENOTES CRITICAL PARAMETER
- ▲ 14. HARDWARE INCLUDED: HEX NUT AND O-RING (NOT SHOWN)

3.60 ± .50
[.142 ± .020 in]

2.00
[.079 in]

M19x1.0

1

2

11.30
[.445 in]

▲ 18.00 ± .50
[.709 ± .020 in]

▲ BODY FINISH
POLISHED STAINLESS STEEL

▲ 25.30 ± .50
[.996 ± .020 in]

.50
[.020 in]

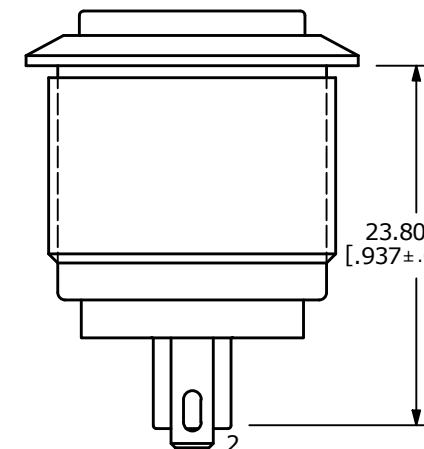

23.80 ± .50
[.937 ± .020 in]

2.80
[.110 in]



E-SWITCH®

OBJECT ID
000002351

C	23593	UPDATED RATING TO 2A @ 36VDC	10/5/18	MJR
B	20339	CORRECT TEMP RATING AND CONVERT	12/14/11	BMA
REV	PCR NO	DESCRIPTION	DATE	BY

THE INFORMATION CONTAINED IN THIS DOCUMENT IS PROPRIETARY TO
E-SWITCH AND IS NOT TO BE COPIED OR TRANSFERRED

TITLE PV1H240SS

SCALE
2:1

DATE
12/14/2011

DR
MW

DWG
52-PV1H240SS

REV
C