

Radio-frequency probe

HFS-110 306 115 A 3002 A

Item HFS-110-0020



GO TO PRODUCT

ingun[®]

Partner for Future Technology

- Test probe for low frequency range or four-pole (kelvin) measurement
- For simple, price-sensitive applications
- Up to 700 mhz
- Interface plug: SE-110
- Receptacle: KS-110

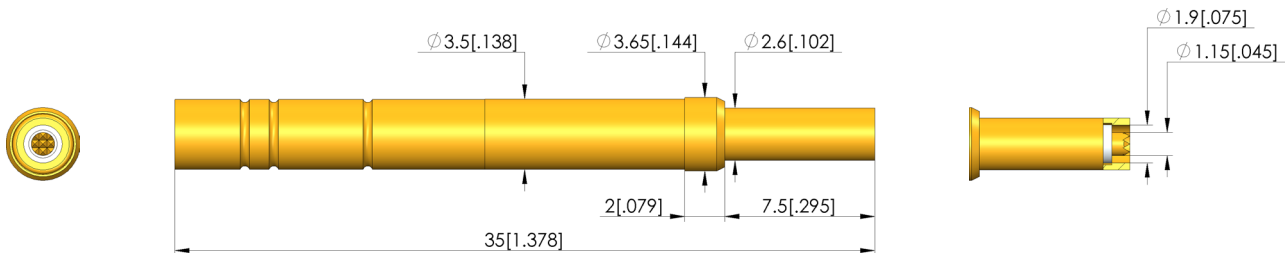
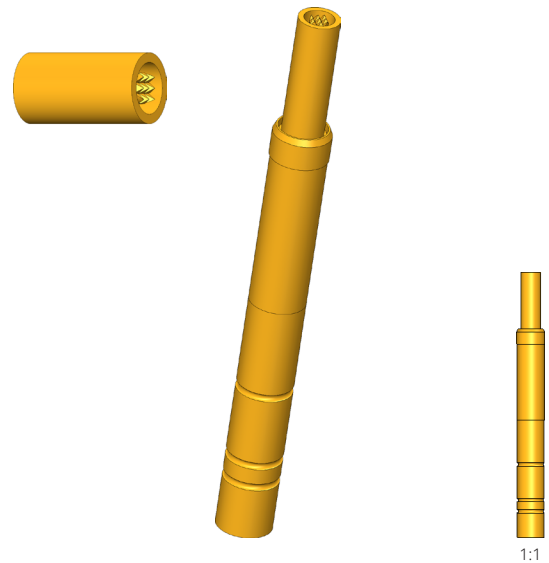

General data

Product group:	Dps dipole test probe
Series:	HFS-110
Sub-series:	HFS-110 A connection for connector
Grid:	4.5 mm [177 mil]
DUT / contact:	PCB coax, closed
Installation type:	Plug-in
Floating mount:	No
Non-rotating:	No
Continuous plunger:	No
Interface of compatible assembly:	SE-110 cable-plug assembly for HFS-110
Compatible assembly interface gender :	M signal conductor male / pin
KS sub-series:	KS-110, screw-in version
Min. temperature:	- 40 °C [- 104 °F]
Max. temperature:	+ 80 °C [+ 176 °F]
RoHS-compliant:	RoHS-3;6c

Outer conductor data

Outer conductor tip style:	02 flat
Outer conductor tip style diameter:	2.6 mm [.102 in]
Spring force of entire outer conductor at working stroke:	3 N [10.7 ozf]
Outer conductor working stroke:	4 mm [.157 in]
Outer conductor maximum stroke:	5 mm [.196 in]
Exchangeable outer conductor:	No
Outer conductor max. current load capacity:	3 A

Inner conductor data

Inner conductor tip style:	06 serrated
Inner conductor tip style diameter:	1.15 mm [.045 in]
Inner conductor tip style material:	3 CuBe
Inner conductor tip style surface:	A gold
Number of inner conductors:	1
Exchangeable inner conductor:	No
Inner conductor working stroke:	4 mm [.157 in]
Spring force of each inner conductor at working stroke:	1.5 N [5.39 ozf]
Inner conductor maximum stroke:	5 mm [.196 in]
Inner conductor max. current load capacity:	3 A

Radio-frequency probe HFS-110 306 115 A 3002 A

Item HFS-110-0020



GO TO PRODUCT

ingun[®]

Partner for Future Technology

Electrical data

Frequency range up to:
Impedance:
Dielectric strength:

0.7 GHz
50 Ohm
1.1 kV

Mechanical data

Total spring force at working stroke:
Total length:
Barrel diameter:
Installation height without receptacle:

4.5 N [16.1 ozf]
35 mm [1.37 in]
3.5 mm [.137 in]
9.5 mm [.374 in]

INGUN Prüfmittelbau GmbH

Max-Stromeyer-Straße 162
78467, Constance, Germany
Phone +49 7531 8105-0
Customer hotline +49 7531 8105-888
Fax +49 7531 8105-65
info@ingun.com



Prices and delivery times on request.
Technical changes reserved. 04/24_GB

Learn more about
Test probes

