

Spring-loaded test probe

GKS-113 302 300 A 3002 M

Item GKS-113-0327



GO TO PRODUCT

ingun[®]

Partner for Future Technology

- Screw-in test probes for applications with possible vibrations or unwanted side and axial forces (migration of the test probe out of the receptacle is reliably prevented)
- The screw-in test probe is securely installed in the KS using a torque screwdriver and bit tool. The required screw-in torque is applied via a square post on the receptacle.
- Stainless steel versions for temperatures from -100 °C up to +200 °C available

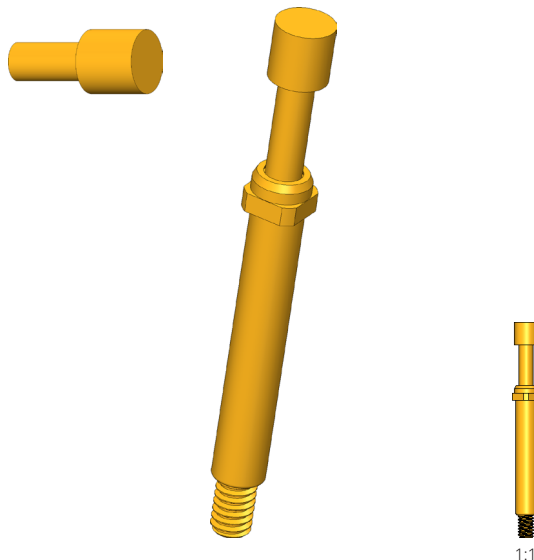

1:1

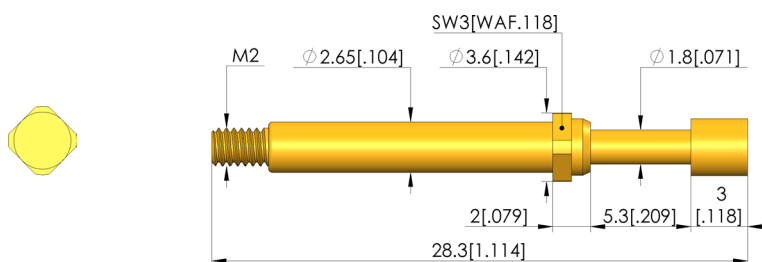

General data

| | |
|---------------------------------|----------------------------------|
| Product group: | Screw-in test probe |
| Sub-product group: | Screw-in test probe |
| Series: | GKS-113 M screw-in |
| Grid: | 4 mm [157 mil] |
| Contacting from: | Pin, Pfoften, Bead, Flachkontakt |
| Magnetic: | Yes |
| Installation type: | Screw-in |
| Quick-exchange system: | Yes |
| Adjustable installation height: | No |
| Non-rotating: | No |
| Screw-in torque: | 10 - 20 cNm [.885 - 1.77 lbf-in] |
| Compatible receptacle(s): | KS-113 M |
| Min. temperature: | - 40 °C [- 104 °F] |
| Max. temperature: | + 80 °C [+ 176 °F] |
| RoHS-compliant: | RoHS-3;6c |

Electrical data

| | |
|--|----------|
| Current load capacity / rated current: | 8 A |
| Typical resistance (Ri): | <30 mOhm |

Mechanical data

| | |
|---------------------------------|-------------------|
| Total length: | 28.3 mm [1.11 in] |
| Barrel diameter: | 2.65 mm [.104 in] |
| Maximum stroke: | 5.3 mm [.208 in] |
| Spring pre-load: | 0.8 N [2.87 ozf] |
| Collar height: | 02 |
| Spring force at working stroke: | 3 N [10.7 ozf] |
| Recommended working stroke: | 4 mm [.157 in] |

Tip style data

| | |
|---------------------|----------------|
| Tip style: | 02 flat |
| Tip diameter: | 3 mm [.118 in] |
| Tip style surface: | A gold |
| Tip style material: | 3 CuBe |

SCREW-IN TEST PROBE

Spring-loaded test probe

GKS-113 302 300 A 3002 M

Item GKS-113-0327



ingun[®]

Partner for Future Technology

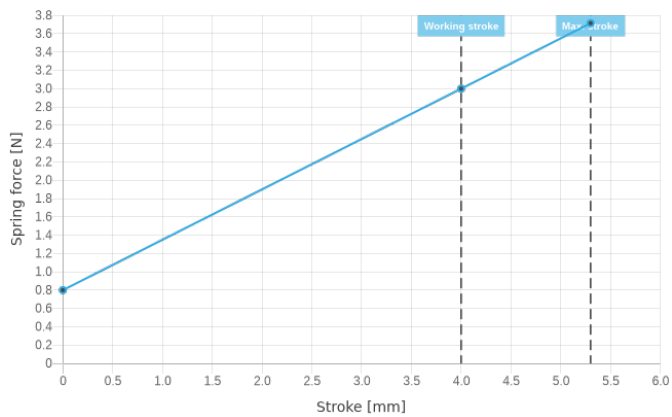

INGUN Prüfmittelbau GmbH

Max-Stromeyer-Straße 162
78467, Constance, Germany
Phone +49 7531 8105-0
Customer hotline +49 7531 8105-888
Fax +49 7531 8105-65
info@ingun.com



Prices and delivery times on request.
Technical changes reserved. 03/24_GB

Learn more about
Screw-in test probe



SCREW-IN TEST PROBE

ingun.com