

Spring-loaded test probe

GKS-103 103 400 A 3002 M

Item GKS-103-0241



ingun®

Partner for Future Technology

General data

Product group	Screw-in test probe
Sub-product group	Screw-in test probe
Series	GKS-103 M screw-in
Grid	4.5 mm [177 mil]
Contacting from	Pin, Post
Magnetic	Yes
Installation type	Screw-in
Quick-exchange system	Yes
Adjustable installation height	No
Non-rotating	No
Screw-in torque	10 - 20 cNm [.885 - 1.77 lbf-in]
Compatible receptacle(s)	KS-103 M, KS-500 M
Min. temperature	- 40 °C [- 104 °F]
Max. temperature	+ 80 °C [+ 176 °F]
RoHS-compliant	RoHS-3;6c

Electrical data

Current load capacity / rated current	5 A
Typical resistance (Ri)	<30 mOhm

Mechanical data

Total length	32.3 mm [1.27 in]
Barrel diameter	3 mm [.118 in]
Maximum stroke	6 mm [.236 in]
Spring pre-load	1.22 N [4.38 ozf]
Collar height	02
Spring force at working stroke	3 N [10.7 ozf]
Recommended working stroke	4.8 mm [.188 in]

Tip style data

Tip style	03 inverse cone
Tip diameter	4 mm [.157 in]
Tip style surface	A gold
Tip style material	1 brass

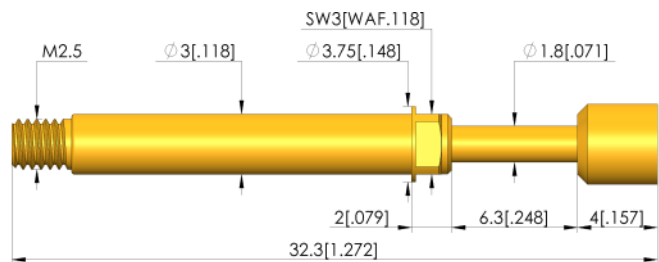
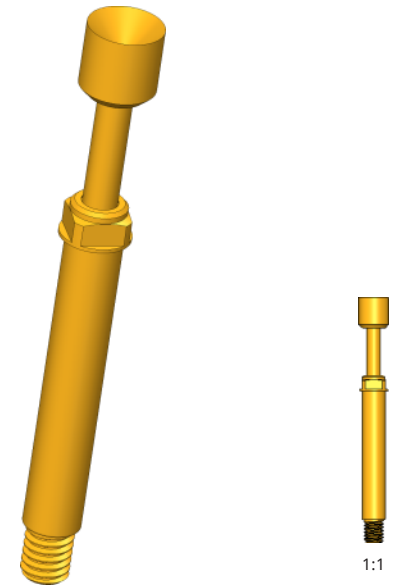

Spring-loaded test probe

GKS-103 103 400 A 3002 M

Item GKS-103-0241



ingun[®]
Partner for Future Technology

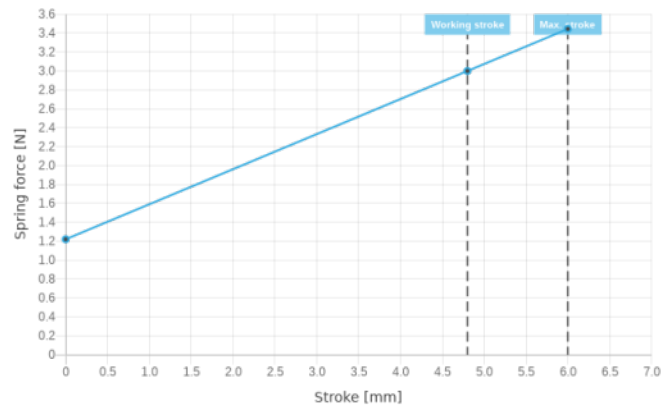
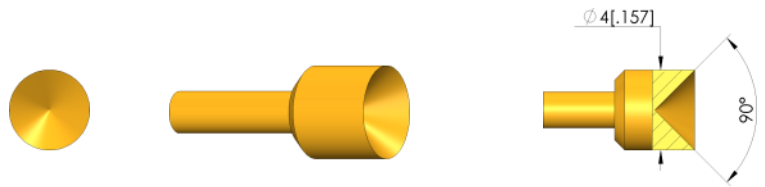

INGUN Prüfmittelbau GmbH

Max-Stromeyer-Straße 162
78467, Constance, Germany
Phone +49 7531 8105-0
Customer hotline +49 7531 8105-888
Fax +49 7531 8105-65
info@ingun.com



Prices and delivery times on request.
Technical changes reserved. 10/23 EN

Learn more about
Screw-in test probe



SCREW-IN TEST PROBE