

KEMET, FLLE2-PV, EMI/RFI Filters, Noise Suppression, 1.2 kV, 400 A, 300x130x100mm

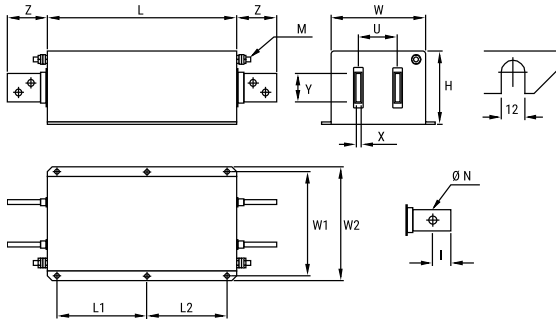

### Dimensions

<b>L</b>	300mm NOM
<b>W</b>	130mm NOM
<b>H</b>	100mm NOM
<b>L1</b>	130mm NOM
<b>L2</b>	110mm NOM
<b>W1</b>	165mm NOM
<b>W2</b>	180mm NOM
<b>U</b>	70mm NOM
<b>X</b>	6mm NOM
<b>Y</b>	25mm NOM
<b>Z</b>	58mm NOM
<b>I</b>	15mm NOM
<b>N</b>	10.5mm NOM
<b>M (Earth)</b>	Threaded Studs M10
<b>Lead</b>	Threaded Studs M10

### Packaging Specifications

<b>Packaging:</b>	Bulk
<b>Packaging Quantity:</b>	1
<b>Weight:</b>	7 kg

### General Information

<b>Series:</b>	FLLE2-PV
<b>Style:</b>	Chassis Mount
<b>Description:</b>	EMI Filter, Without Y Capacitor
<b>Features:</b>	Single Phase, Photovoltaic Applications
<b>RoHS:</b>	Yes
<b>Qualifications:</b>	IEC/EN 60939, UL 1283
<b>Lead:</b>	Threaded Studs M10

### Specifications

<b>Voltage DC:</b>	1200 VDC
<b>Ripple Current:</b>	400 A (50°C)
<b>Rated Temperature:</b>	55°C
<b>Temperature Range:</b>	-40/+100°C
<b>Climate Category:</b>	40/100/21
<b>Test Voltage DC (P to P):</b>	3000 VDC
<b>Test Voltage DC (P to E):</b>	3600 VDC
<b>Voltage:</b>	1200 VDC, 3000 VDC (Test P to P), 3600 VDC (Test P to E)
<b>Power Loss:</b>	15 W (25°C 50 Hz)