

# BS5-P Series

## INSTRUCTION MANUAL

## Autonics

Follow Autonics website for the latest information.

**Warning** Failure to follow instructions may result in serious injury or death.

- ⚠ Caution** Failure to follow instructions may result in injury or product damage.

• Unit: mm, For the detailed drawings, follow the Autonics website.

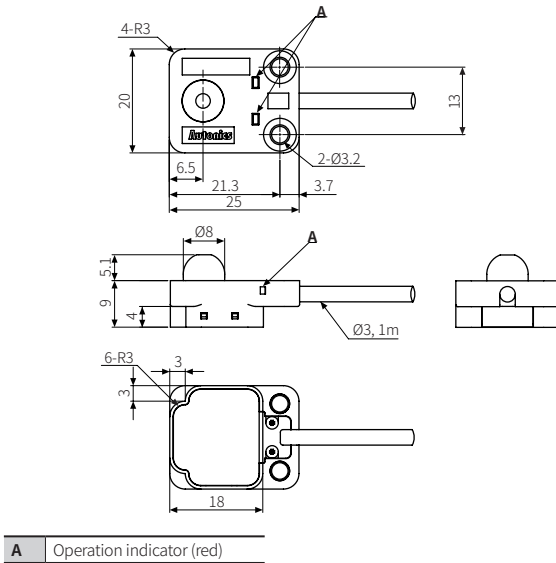

<b>Power supply</b>	12-24 VDC= $\pm 10\%$ (ripple P-P: $\leq 10\%$ )
<b>Current consumption</b>	$\leq 35$ mA
<b>Control output</b>	NPN open collector output / PNP open collector output model
<b>Load voltage</b>	$\leq 26.4$ VDC=
<b>Load current</b>	$\leq 50$ mA
<b>Residual voltage</b>	NPN: $\leq 1.5$ VDC=, PNP: $\leq 1.5$ VDC=
<b>Protection circuit</b>	Reverse power protection circuit, output short overcurrent protection circuit
<b>Insulation resistance</b>	$\geq 20$ M $\Omega$ (250 VDC= megger)
<b>Noise immunity</b>	$\geq 240$ VDC= the square wave noise (pulse width: 1 $\mu$ s) by the noise simulator
<b>Dielectric strength</b>	1,000 VAC~ at 50/60 Hz for 1 min
<b>Vibration</b>	1.5 mm double amplitude at 10 to 55 Hz frequency in each X, Y, Z direction for 2 hours
<b>Shock</b>	500 m/s <sup>2</sup> ( $\approx 50$ G) in each X, Y, Z direction for 3 times
<b>Mechanical life cycle</b>	$\geq 5,000,000$ operations (1 operation = stop position - operation limit position - stop position)
<b>Ambient illumination (receiver)</b>	Fluorescent lamp: $\leq 1,000$ lx
<b>Ambient temperature</b>	-20 to 55 °C, storage: -25 to 70 °C (no freezing or condensation)
<b>Ambient humidity</b>	35 to 85 %RH, storage: 35 to 85 %RH (no freezing or condensation)
<b>Protection rating</b>	IP40 (IEC standard)
<b>Connection method</b>	Cable type
<b>Cable spec.</b>	$\varnothing 3$ mm, 4-wire, 1 m
<b>Wire spec.</b>	Refer to the specifications below depending on the models.
BSS-P1M□-□-□	AWG26 (0.08 mm, 30-core), insulator outer diameter: $\varnothing 0.93$ mm
BSS-P1M□-□-□-U	AWG26 (0.08 mm, 28-core), insulator outer diameter: $\varnothing 0.9$ mm
<b>Material</b>	Refer to the specifications below depending on the models.
BSS-P1M□-□-□	Case: PC + G, button: POM, sleeve: SUS304
BSS-P1M□-□-□-U	Case: PC, button: POM, sleeve: SUS304