

Pushbutton Ø 22 mm silver contact

82-6572.2000



<https://eao.com/p/82-6572.2000>

Your product:



82-6572.2000

Pushbutton Ø 22 mm silver contact

FRONT

Front bezel shape:	flush
Front bezel material:	Aluminium

MOUNTING

Mounting cut-out:	Ø 22 mm
-------------------	---------

OPERATING-/INDICATION PART

Lens shape:	convex
Lens material:	Aluminium
Lens optics:	opaque
Lens illumination:	non illuminative
Lens colour:	Nature

ELECTRICAL CHARACTERISTICS

Electric strength:	1500 VAC, 50 Hz 1 minute between life terminals and ground
Rated Operational Voltage Ue:	250 VAC
Contacts:	1 C
Switching voltage and switching current:	

according to IEC 60947-5-1 (Silver contacts)	
Service categorie AC-15	
Voltage	Current
24 VAC	1 A
35 VAC	1 A (M12 version)
110 VAC	1 A
220 VAC	0.5 A
Switch rating DC service categorie DC-13 (Silver contacts)	
Voltage	Current
24 VDC	0.7 A
35 VDC	0.5 A (M12 version)
110 VDC	0.2 A
220 VDC	0.1 A

according to UL 508 (Silver contacts)	
cosφ 0,75 ... 0,8	
Voltage	Current
120 VAC	5 A
240 VAC	3 A
24 VAC	1 A

Thermal current Ith:	5 A
Pollution degree:	2, according to EN IEC 60947-1
Rated insulation voltage Ui:	250 V
Electrical lifetime:	50 000 cycles of operation

MECHANICAL CHARATERISTIC

Operating force:	4 N ... 7 N
Switching action:	Maintained
Terminal:	Screw terminal
Operating Travel:	ca. 3 mm
Switching system:	Snap-action switching element
Weight:	0.019 kg
Contact material:	Silver
Mechanical lifetime:	500 000 cycles of operation
Tightening torque:	0.5 ... 0.6 Nm, Screw terminal 0.1 Nm

AMBIENT CONDITION

Climate resistance:	Damp heat, 21 days according to IEC 60512-11
Operating temperature:	– 30 °C ... + 70 °C
Shock resistance:	Max. 500 m / s² as per IEC 60068-2-27
Storage temperature:	– 40 °C ... + 80 °C
Vibration resistance:	

10 ... 500 Hz, amplitude 1.5 mm p-p according to IEC 60068-2-6

CERTIFICATE

Conformities: CE, 2011 / 65 / EC (RoHS), 2014 / 35 / EU (LVD)

Approbations: CB, CCC, C UL, UL

OTHER

Short Description: Pushbutton Ø 22 mm silver contact, Maintained, 1 C, Screw terminal, Aluminium, Nature

Component layouts:

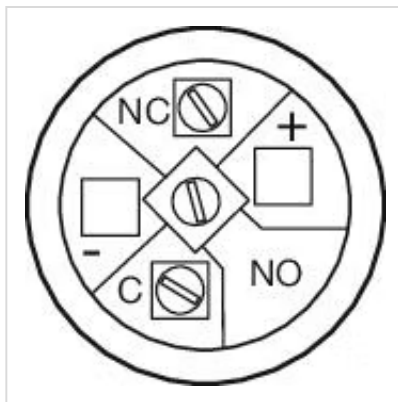

Wiring diagrams:

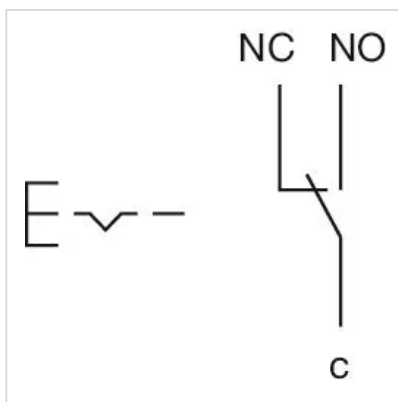

Dimension drawings:

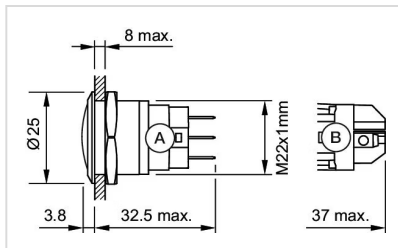

A = Solder terminal
B = Screw terminal

Mounting cut-outs:

