

Pushbutton Ø 22 mm silver contact

82-6571.1000



<https://eao.com/p/82-6571.1000>

Your product:



82-6571.1000

Pushbutton Ø 22 mm silver contact

FRONT

Front bezel shape:	flush
Front bezel material:	Aluminium

MOUNTING

Mounting cut-out:	Ø 22 mm
-------------------	---------

OPERATING-/INDICATION PART

Lens shape:	raised
Lens colour:	Nature
Lens optics:	opaque
Lens illumination:	non illuminative
Lens material:	Aluminium

ELECTRICAL CHARACTERISTICS

Contacts:	1 C
Electrical lifetime:	50 000 cycles of operation
Rated insulation voltage U_i :	250 V
Electric strength:	1500 VAC, 50 Hz 1 minute between life terminals and ground
Rated Operational Voltage U_e :	250 VAC
Thermal current I_{th} :	5 A
Pollution degree:	2, according to EN IEC 60947-1
Switching voltage and switching current:	

according to IEC 60947-5-1 (Silver contacts)	
Service categorie AC-15	
Voltage	Current
24 VAC	1 A
35 VAC	1 A (M12 version)
110 VAC	1 A
220 VAC	0.5 A
Switch rating DC service categorie DC-13 (Silver contacts)	
Voltage	Current
24 VDC	0.7 A
35 VDC	0.5 A (M12 version)
110 VDC	0.2 A
220 VDC	0.1 A

according to UL 508 (Silver contacts)	
cosφ 0,75 ... 0,8	
Voltage	Current
120 VAC	5 A
240 VAC	3 A
24 VAC	1 A

MECHANICAL CHARACTERISTIC

Tightening torque:	0.5 ... 0.6 Nm
Contact material:	Silver
Switching system:	Snap-action switching element
Mechanical lifetime:	1 Mio. cycles of operation
Terminal:	Soldering terminal, 2.8 x 0.5 mm
Operating force:	4 N ... 7 N
Switching action:	Momentary
Operating Travel:	ca. 3 mm
Weight:	0.019 kg

AMBIENT CONDITION

Operating temperature:	– 30 °C ... + 70 °C
Shock resistance:	Max. 500 m / s ² as per IEC 60068-2-27
Storage temperature:	– 40 °C ... + 80 °C
Climate resistance:	Damp heat, 21 days according to IEC 60512-11
Vibration resistance:	10 ... 500 Hz, amplitude 1.5 mm p-p according to IEC 60068-2-6

CERTIFICATE

Conformities:	CE, 2011 / 65 / EC (RoHS), 2014 / 35 / EU (LVD)
----------------------	---

Approbations:

CB, CCC, C UL, UL

OTHER**Short Description:**

Pushbutton Ø 22 mm silver contact, Momentary, 1 C, Soldering terminal, 2.8 x 0.5 mm, Aluminium, Nature

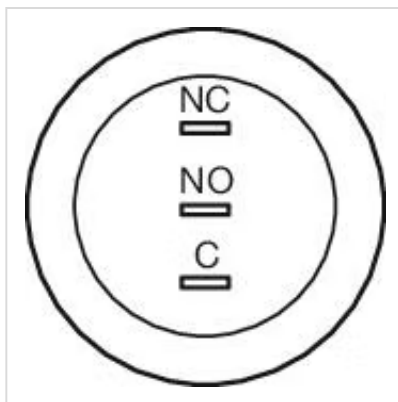
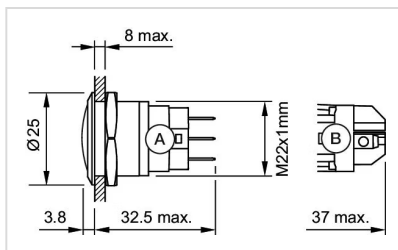
Component layouts:**Dimension drawings:**

A = Solder terminal
B = Screw terminal

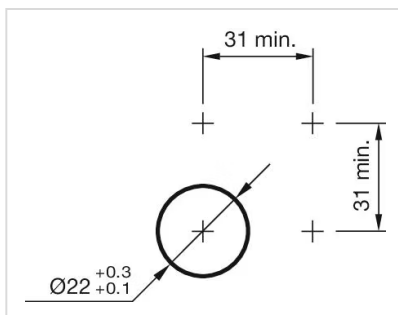
Mounting cut-outs:**Wiring diagrams:**

