

Illuminated pushbutton Ø 22 mm silver contact

82-6551.2134



<https://eao.com/p/82-6551.2134>

Your product:



82-6551.2134

Illuminated pushbutton Ø
22 mm silver contact

FRONT

Front bezel material: Aluminium

Front bezel shape: flush

MOUNTING

Mounting cut-out: Ø 22 mm

OPERATING-/INDICATION PART

Lens illumination: illuminative

Lens optics: opaque

Lens material: Aluminium

Illumination colour: Green

Lens colour: Nature

Lens shape: flush

Shape of illumination: Ring

ELECTRICAL CHARACTERISTICS

Thermal current I_{th}: 5 A

Electrical lifetime: 50 000 cycles of operation

Electric strength: 1500 VAC, 50 Hz 1 minute between life terminals and ground

Pollution degree: 2, according to EN IEC 60947-1

Contacts: 1 C

Rated Operational Voltage U_e: 250 VAC

Rated insulation voltage Ui:	250 V		
Switching voltage and switching current:	according to IEC 60947-5-1 (Silver contacts) Service categorie AC-15		
	Voltage		Current
	24 VAC		1 A
	35 VAC		1 A (M12 versio
	110 VAC		1 A
	220 VAC		0.5 A
	Switch rating DC service categorie DC-13 (Silver contacts)		
	Voltage		Current
	24 VDC		0.7 A
	35 VDC		0.5 A (M12 vers
	110 VDC		0.2 A
	220 VDC		0.1 A
	according to UL 508 (Silver contacts)		
	cosφ 0,75 ... 0,8		
	Voltage		Current
	120 VAC		5 A
	240 VAC		3 A
	24 VAC		1 A
Operating voltage:	24 V AC/DC		

MECHANICAL CHARACTERISTIC

Operating force:	4 N ... 7 N
Weight:	0.018 kg
Mechanical lifetime:	500 000 cycles of operation
Terminal:	Soldering terminal, 2.8 x 0.5 mm
Tightening torque:	0.5 ... 0.6 Nm
Switching system:	Snap-action switching element
Switching action:	Maintained
Operating Travel:	ca. 3 mm
Contact material:	Silver

AMBIENT CONDITION

Storage temperature:	– 40 °C ... + 80 °C
Shock resistance:	Max. 500 m / s ² as per IEC 60068-2-27
Operating temperature:	– 30 °C ... + 70 °C
Climate resistance:	Damp heat, 21 days according to IEC 60512-11
Vibration resistance:	10 ... 500 Hz, amplitude 1.5 mm p-p according to IEC 60068-2-6

CERTIFICATE

Approbations:

CB, CCC, C UL, UL

Conformities:

CE, 2011 / 65 / EC (RoHS), 2014 / 35 / EU (LVD)

OTHER

Kind of illumination:

Single-LED

Short Description:

Illuminated pushbutton Ø 22 mm silver contact, Maintained, 24 V AC/DC, 1 C, Soldering terminal, 2.8 x 0.5 mm, Aluminium, Green, Nature

Dimension drawings:

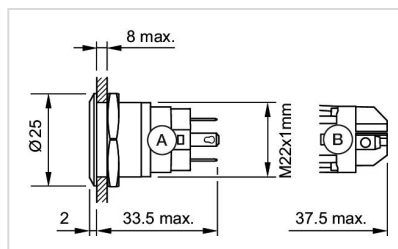

A = Solder terminal
B = Screw terminal

Wiring diagrams:

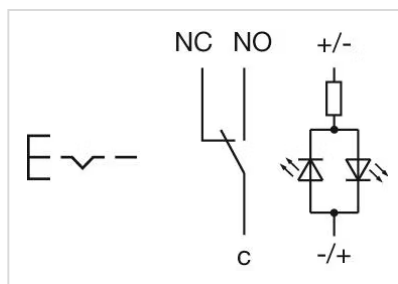

Component layouts:

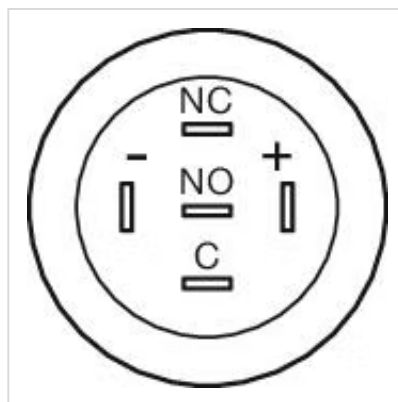

Mounting cut-outs:

