

## Illuminated pushbutton Ø 22 mm silver contact

82-6551.2123



<https://eao.com/p/82-6551.2123>

Your product:

---



82-6551.2123

Illuminated pushbutton Ø  
22 mm silver contact

#### FRONT

**Front bezel material:** Aluminium

**Front bezel shape:** flush

#### MOUNTING

**Mounting cut-out:** Ø 22 mm

#### OPERATING-/INDICATION PART

**Shape of illumination:** Ring

**Lens material:** Aluminium

**Lens optics:** opaque

**Lens shape:** flush

**Lens colour:** Nature

**Illumination colour:** Blue

**Lens illumination:** illuminative

#### ELECTRICAL CHARACTERISTICS

**Rated insulation voltage  $U_i$ :** 250 V

**Electrical lifetime:** 50 000 cycles of operation

**Operating voltage:** 12 V AC/DC

**Contacts:** 1 C

**Electric strength:** 1500 VAC, 50 Hz 1 minute between life terminals and ground

**Pollution degree:** 2, according to EN IEC 60947-1

<b>Thermal current I<sub>th</sub>:</b>	5 A		
<b>Rated Operational Voltage U<sub>e</sub>:</b>	250 VAC		
<b>Switching voltage and switching current:</b>	according to IEC 60947-5-1 (Silver contacts) Service categorie AC-15 Voltage 24 VAC 35 VAC 110 VAC 220 VAC Switch rating DC service categorie DC-13 (Silver contacts) Voltage 24 VDC 35 VDC 110 VDC 220 VDC		Current 1 A 1 A (M12 versio 1 A 0.5 A  Current 0.7 A 0.5 A (M12 vers 0.2 A 0.1 A
	according to UL 508 (Silver contacts) cosφ 0,75 ... 0,8 Voltage 120 VAC 240 VAC 24 VAC		Current   5 A 3 A 1 A

## MECHANICAL CHARACTERISTIC

<b>Mechanical lifetime:</b>	500 000 cycles of operation
<b>Tightening torque:</b>	0.5 ... 0.6 Nm
<b>Contact material:</b>	Silver
<b>Switching system:</b>	Snap-action switching element
<b>Switching action:</b>	Maintained
<b>Operating force:</b>	4 N ... 7 N
<b>Weight:</b>	0.018 kg
<b>Operating Travel:</b>	ca. 3 mm
<b>Terminal:</b>	Soldering terminal, 2.8 x 0.5 mm

## AMBIENT CONDITION

<b>Climate resistance:</b>	Damp heat, 21 days according to IEC 60512-11
<b>Operating temperature:</b>	– 30 °C ... + 70 °C
<b>Storage temperature:</b>	– 40 °C ... + 80 °C
<b>Shock resistance:</b>	Max. 500 m / s <sup>2</sup> as per IEC 60068-2-27
<b>Vibration resistance:</b>	10 ... 500 Hz, amplitude 1.5 mm p-p according to IEC 60068-2-6

## CERTIFICATE

**Approbations:** CB, CCC, C UL, UL

**Conformities:** CE, 2011 / 65 / EC (RoHS), 2014 / 35 / EU (LVD)

## OTHER

**Kind of illumination:** Single-LED

**Short Description:** Illuminated pushbutton Ø 22 mm silver contact, Maintained, 12 V AC/DC, 1 C, Soldering terminal, 2.8 x 0.5 mm, Aluminium, Blue, Nature

**Dimension drawings:**

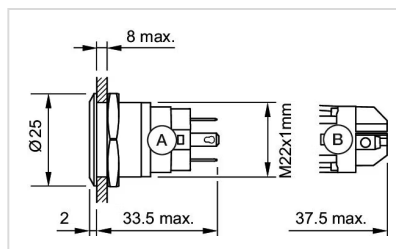

A = Solder terminal  
B = Screw terminal

**Component layouts:**

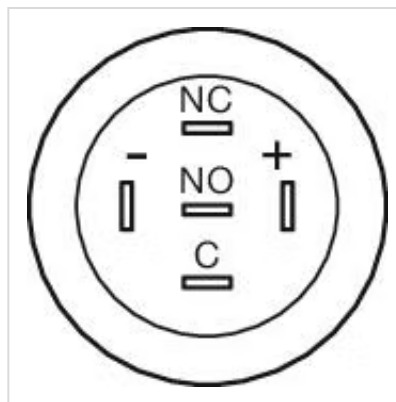

**Mounting cut-outs:**

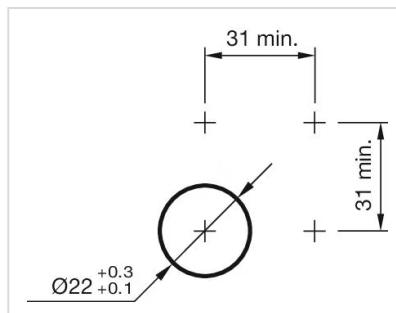

**Wiring diagrams:**

