

Pushbutton Ø 22 mm silver contact

82-6551.2000



<https://eao.com/p/82-6551.2000>

Your product:



82-6551.2000
Pushbutton Ø 22 mm silver contact

FRONT

Front bezel material:	Aluminium
Front bezel shape:	flush

MOUNTING

Mounting cut-out:	Ø 22 mm
-------------------	---------

OPERATING-/INDICATION PART

Lens material:	Aluminium
Lens illumination:	non illuminative
Lens shape:	flush
Lens colour:	Nature
Lens optics:	opaque

ELECTRICAL CHARACTERISTICS

Contacts:	1 C		
Switching voltage and switching current:	according to IEC 60947-5-1 (Silver contacts)		
	Service categorie AC-15		
	Voltage	Current	
	24 VAC	1 A	
	35 VAC	1 A (M12 versio	
	110 VAC	1 A	
	220 VAC	0.5 A	
	Switch rating DC service categorie DC-13 (Silver contacts)		
	Voltage	Current	
	24 VDC	0.7 A	
	35 VDC	0.5 A (M12 vers	
	110 VDC	0.2 A	
	220 VDC	0.1 A	

according to UL 508 (Silver contacts)

$\cos\phi$ 0,75 ... 0,8

Voltage

120 VAC

240 VAC

24 VAC

Current

5 A

3 A

1 A

Electrical lifetime:	50 000 cycles of operation
Thermal current Ith:	5 A
Pollution degree:	2, according to EN IEC 60947-1
Electric strength:	1500 VAC, 50 Hz 1 minute between live terminals and ground
Rated insulation voltage Ui:	250 V
Rated Operational Voltage Ue:	250 VAC

MECHANICAL CHARACTERISTIC

Tightening torque:	0.5 ... 0.6 Nm
Mechanical lifetime:	500 000 cycles of operation
Switching action:	Maintained
Switching system:	Snap-action switching element
Contact material:	Silver
Terminal:	Soldering terminal, 2.8 x 0.5 mm
Operating Travel:	ca. 3 mm
Weight:	0.018 kg
Operating force:	4 N ... 7 N

AMBIENT CONDITION

Climate resistance:	Damp heat, 21 days according to IEC 60512-11
Storage temperature:	- 40 °C ... + 80 °C
Vibration resistance:	10 ... 500 Hz, amplitude 1.5 mm p-p according to IEC 60068-2-6
Operating temperature:	- 30 °C ... + 70 °C
Shock resistance:	Max. 500 m / s ² as per IEC 60068-2-27

CERTIFICATE

Approbations:	CB, CCC, C UL, UL
Conformities:	CE, 2011 / 65 / EC (RoHS), 2014 / 35 / EU (LVD)

OTHER

Short Description:

Pushbutton Ø 22 mm silver contact, Maintained, 1 C, Soldering terminal, 2.8 x 0.5 mm, Aluminium, Nature

Mounting cut-outs:

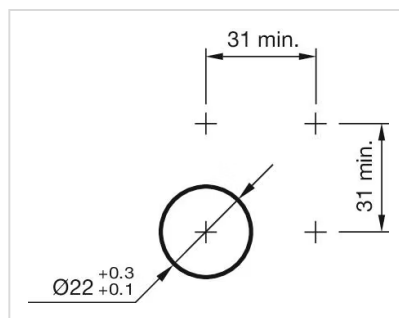

Component layouts:

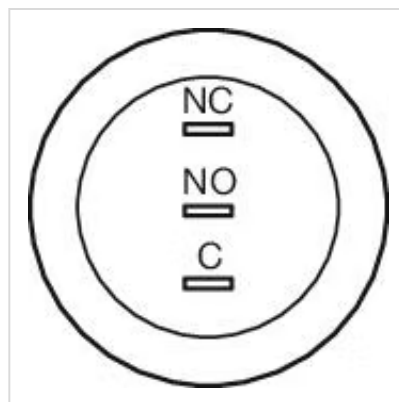

Dimension drawings:

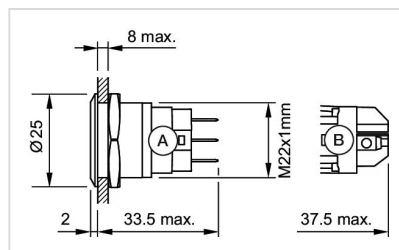

A = Solder terminal
B = Screw terminal

Wiring diagrams:

