

Pushbutton Ø 22 mm silver contact

82-6172.1000



<https://eao.com/p/82-6172.1000>

Your product:



82-6172.1000

Pushbutton Ø 22 mm silver contact

FRONT

Front bezel shape:	flush
Front bezel material:	Stainless steel

MOUNTING

Mounting cut-out:	Ø 22 mm
-------------------	---------

OPERATING-/INDICATION PART

Lens material:	Stainless steel
Lens shape:	raised
Lens colour:	Silver
Lens illumination:	non illuminative
Lens optics:	opaque

ELECTRICAL CHARACTERISTICS

Rated insulation voltage U_i :	250 V
Rated Operational Voltage U_e :	250 VAC
Electric strength:	1500 VAC, 50 Hz 1 minute between life terminals and ground
Thermal current I_{th} :	5 A
Pollution degree:	2, according to EN IEC 60947-1
Contacts:	1 C
Electrical lifetime:	50 000 cycles of operation
Switching voltage and switching current:	

according to IEC 60947-5-1 (Silver contacts)

Service categorie AC-15

Voltage

24 VAC

35 VAC

110 VAC

220 VAC

Current

1 A

1 A (M12 version)

1 A

0.5 A

Switch rating DC service categorie DC-13 (Silver contacts)

Voltage

24 VDC

35 VDC

110 VDC

220 VDC

Current

0.7 A

0.5 A (M12 version)

0.2 A

0.1 A

according to UL 508 (Silver contacts)

$\cos\phi$ 0,75 ... 0,8

Voltage

120 VAC

240 VAC

24 VAC

Current

5 A

3 A

1 A

MECHANICAL CHARACTERISTIC

Weight:	0.019 kg
Tightening torque:	0.5 ... 0.6 Nm, Screw terminal 0.1 Nm
Mechanical lifetime:	1 Mio. cycles of operation
Operating force:	4 N ... 7 N
Terminal:	Screw terminal
Switching system:	Snap-action switching element
Switching action:	Momentary
Contact material:	Silver
Operating Travel:	ca. 3 mm

AMBIENT CONDITION

Vibration resistance:	10 ... 500 Hz, amplitude 1.5 mm p-p according to IEC 60068-2-6
Climate resistance:	Damp heat, 21 days according to IEC 60512-11
Storage temperature:	- 40 °C ... + 80 °C
Operating temperature:	- 30 °C ... + 70 °C
Shock resistance:	Max. 500 m / s ² as per IEC 60068-2-27

CERTIFICATE

Conformities:	CE, 2011 / 65 / EC (RoHS), 2014 / 35 / EU (LVD)
----------------------	---

Approbations:

CB, CCC, C UL, UL

OTHER**Short Description:**

Pushbutton Ø 22 mm silver contact, Momentary, 1 C, Screw terminal, Stainless steel, Silver

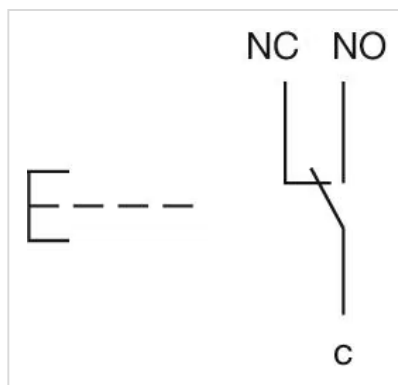
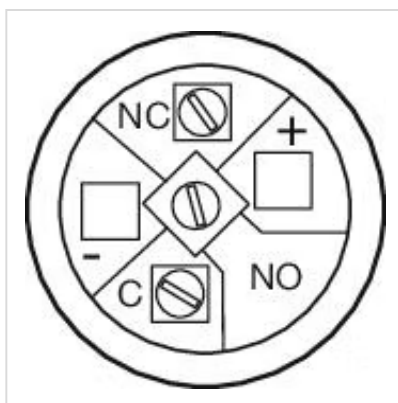
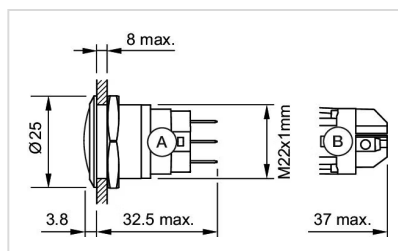
Wiring diagrams:**Component layouts:****Dimension drawings:**

A = Solder terminal
B = Screw terminal

Mounting cut-outs:

