

Pushbutton Ø 22 mm silver contact

82-6171.2000



<https://eao.com/p/82-6171.2000>

Your product:



82-6171.2000
Pushbutton Ø 22 mm silver contact

FRONT

Front bezel shape:	flush
Front bezel material:	Stainless steel

MOUNTING

Mounting cut-out:	Ø 22 mm
-------------------	---------

OPERATING-/INDICATION PART

Lens colour:	Silver
Lens optics:	opaque
Lens shape:	convex
Lens illumination:	non illuminative
Lens material:	Stainless steel

ELECTRICAL CHARACTERISTICS

Electrical lifetime:	50 000 cycles of operation
----------------------	----------------------------

Switching voltage and switching current:	according to IEC 60947-5-1 (Silver contacts)	
	Service categorie AC-15	
	Voltage	Current
	24 VAC	1 A
	35 VAC	1 A (M12 versio
	110 VAC	1 A
	220 VAC	0.5 A
	Switch rating DC service categorie DC-13 (Silver contacts)	
	Voltage	Current
	24 VDC	0.7 A
	35 VDC	0.5 A (M12 vers
	110 VDC	0.2 A
	220 VDC	0.1 A

according to UL 508 (Silver contacts)

$\cos\phi$ 0,75 ... 0,8

Voltage

120 VAC

240 VAC

24 VAC

Current

5 A

3 A

1 A

Rated insulation voltage U_i:	250 V
Contacts:	1 C
Electric strength:	1500 VAC, 50 Hz 1 minute between life terminals and ground
Pollution degree:	2, according to EN IEC 60947-1
Thermal current I_{th}:	5 A
Rated Operational Voltage U_e:	250 VAC

MECHANICAL CHARACTERISTIC

Switching system:	Snap-action switching element
Terminal:	Soldering terminal, 2.8 x 0.5 mm
Tightening torque:	0.5 ... 0.6 Nm
Mechanical lifetime:	500 000 cycles of operation
Contact material:	Silver
Operating force:	4 N ... 7 N
Operating Travel:	ca. 3 mm
Switching action:	Maintained
Weight:	0.019 kg

AMBIENT CONDITION

Operating temperature:	- 30 °C ... + 70 °C
Climate resistance:	Damp heat, 21 days according to IEC 60512-11
Shock resistance:	Max. 500 m / s ² as per IEC 60068-2-27
Vibration resistance:	10 ... 500 Hz, amplitude 1.5 mm p-p according to IEC 60068-2-6
Storage temperature:	- 40 °C ... + 80 °C

CERTIFICATE

Approbations:	CB, CCC, C UL, UL
Conformities:	CE, 2011 / 65 / EC (RoHS), 2014 / 35 / EU (LVD)

OTHER

Short Description:

Pushbutton Ø 22 mm silver contact, Maintained, 1 C, Soldering terminal, 2.8 x 0.5 mm, Stainless steel, Silver

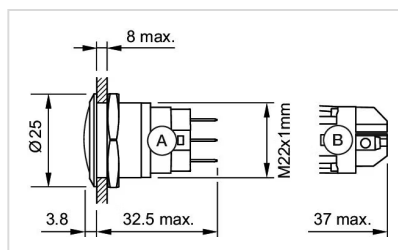
Dimension drawings:

A = Solder terminal
B = Screw terminal

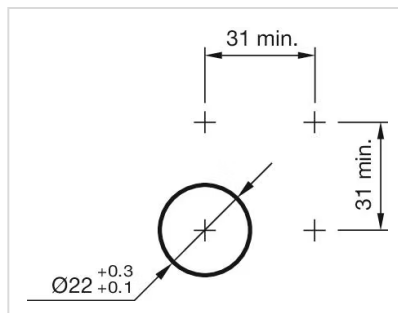
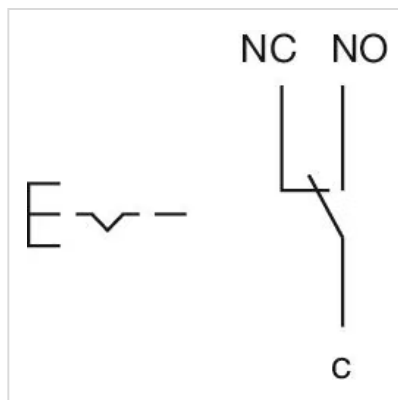
Mounting cut-outs:**Wiring diagrams:****Component layouts:**