

Pushbutton Ø 22 mm silver contact

82-6162.2000.B002



<https://eao.com/p/82-6162.2000.B002>

Your product:



82-6162.2000.B002

Pushbutton Ø 22 mm silver contact

FRONT

Front bezel shape:	flush
Front bezel material:	Stainless steel

MOUNTING

Mounting cut-out:	Ø 22 mm
-------------------	---------

OPERATING-/INDICATION PART

Lens optics:	opaque
Lens colour:	Silver
Lens shape:	raised
Lens material:	Stainless steel
Lens illumination:	non illuminative

ELECTRICAL CHARACTERISTICS

Electric strength:	1500 VAC, 50 Hz 1 minute between life terminals and ground
Rated insulation voltage Ui:	250 V
Rated Operational Voltage Ue:	250 VAC
Pollution degree:	2, according to EN IEC 60947-1
Electrical lifetime:	50 000 cycles of operation
Switching voltage and switching current:	

according to IEC 60947-5-1 (Silver contacts)	
Service categorie AC-15	
Voltage	Current
24 VAC	1 A
35 VAC	1 A (M12 version)
110 VAC	1 A
220 VAC	0.5 A
Switch rating DC service categorie DC-13 (Silver contacts)	
Voltage	Current
24 VDC	0.7 A
35 VDC	0.5 A (M12 version)
110 VDC	0.2 A
220 VDC	0.1 A

according to UL 508 (Silver contacts)	
cosφ 0,75 ... 0,8	
Voltage	Current
120 VAC	5 A
240 VAC	3 A
24 VAC	1 A

Contacts: 1 C

Thermal current I_{th}: 5 A

MECHANICAL CHARACTERISTIC

Switching action: Maintained

Switching system: Snap-action switching element

Weight: 0.02 kg

Operating Travel: ca. 3 mm

Mechanical lifetime: 500 000 cycles of operation

Terminal: Screw terminal

Operating force: 4 N ... 7 N

Contact material: Silver

Tightening torque: 0.5 ... 0.6 Nm, Screw terminal 0.1 Nm

AMBIENT CONDITION

Climate resistance: Damp heat, 21 days according to IEC 60512-11

Vibration resistance: 10 ... 500 Hz, amplitude 1.5 mm p-p according to IEC 60068-2-6

Storage temperature: – 40 °C ... + 80 °C

Operating temperature: – 30 °C ... + 70 °C

Shock resistance: Max. 500 m / s² as per IEC 60068-2-27

CERTIFICATE

Approbations:

CB, CCC, C UL, UL

Conformities:

CE, 2011 / 65 / EC (RoHS), 2014 / 35 / EU (LVD)

OTHER

Symbol:

Standby

Short Description:

Pushbutton Ø 22 mm silver contact, Maintained, 1 C, Screw terminal, Stainless steel, Standby, Silver

Mounting cut-outs:

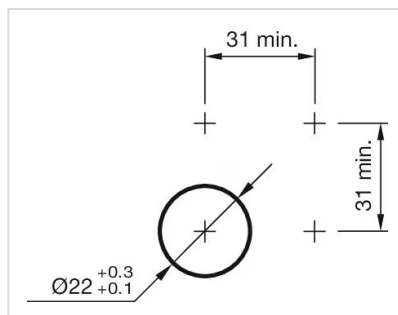

Component layouts:

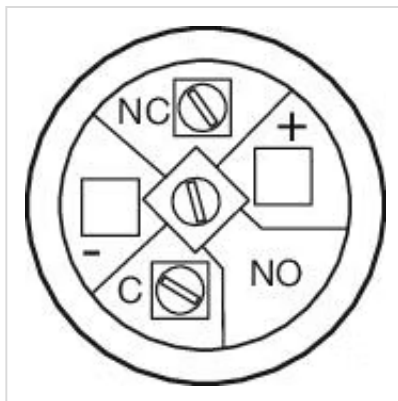

Dimension drawings:

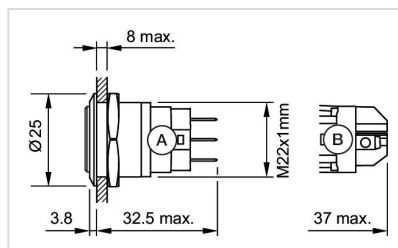

A = Solder terminal
B = Screw terminal

Wiring diagrams:

