

## Pushbutton Ø 22 mm silver contact

82-6162.1000



<https://eao.com/p/82-6162.1000>

Your product:

---



82-6162.1000

Pushbutton Ø 22 mm silver contact

#### FRONT

Front bezel shape:	flush
Front bezel material:	Stainless steel

#### MOUNTING

Mounting cut-out:	Ø 22 mm
-------------------	---------

#### OPERATING-/INDICATION PART

Lens colour:	Silver
Lens illumination:	non illuminative
Lens shape:	flush
Lens optics:	opaque
Lens material:	Stainless steel

#### ELECTRICAL CHARACTERISTICS

Pollution degree:	2, according to EN IEC 60947-1
Contacts:	1 C
Electric strength:	1500 VAC, 50 Hz 1 minute between life terminals and ground
Electrical lifetime:	50 000 cycles of operation
Switching voltage and switching current:	

according to IEC 60947-5-1 (Silver contacts)	
Service categorie AC-15	
Voltage	Current
24 VAC	1 A
35 VAC	1 A (M12 version)
110 VAC	1 A
220 VAC	0.5 A
Switch rating DC service categorie DC-13 (Silver contacts)	
Voltage	Current
24 VDC	0.7 A
35 VDC	0.5 A (M12 version)
110 VDC	0.2 A
220 VDC	0.1 A

according to UL 508 (Silver contacts)	
cosφ 0,75 ... 0,8	
Voltage	Current
120 VAC	5 A
240 VAC	3 A
24 VAC	1 A

<b>Thermal current Ith:</b>	5 A
<b>Rated Operational Voltage Ue:</b>	250 VAC
<b>Rated insulation voltage Ui:</b>	250 V

## MECHANICAL CHARATERISTIC

<b>Terminal:</b>	Screw terminal
<b>Mechanical lifetime:</b>	1 Mio. cycles of operation
<b>Weight:</b>	0.02 kg
<b>Operating force:</b>	4 N ... 7 N
<b>Operating Travel:</b>	ca. 3 mm
<b>Switching action:</b>	Momentary
<b>Switching system:</b>	Snap-action switching element
<b>Contact material:</b>	Silver
<b>Tightening torque:</b>	0.5 ... 0.6 Nm, Screw terminal 0.1 Nm

## AMBIENT CONDITION

<b>Storage temperature:</b>	– 40 °C ... + 80 °C
<b>Operating temperature:</b>	– 30 °C ... + 70 °C
<b>Shock resistance:</b>	Max. 500 m / s <sup>2</sup> as per IEC 60068-2-27
<b>Vibration resistance:</b>	10 ... 500 Hz, amplitude 1.5 mm p-p according to IEC 60068-2-6
<b>Climate resistance:</b>	Damp heat, 21 days according to IEC 60512-11

## CERTIFICATE

### Approbations:

CB, CCC, C UL, UL

### Conformities:

CE, 2011 / 65 / EC (RoHS), 2014 / 35 / EU (LVD)

## OTHER

### Short Description:

Pushbutton Ø 22 mm silver contact, Momentary, 1 C, Screw terminal, Stainless steel, Silver

### Wiring diagrams:

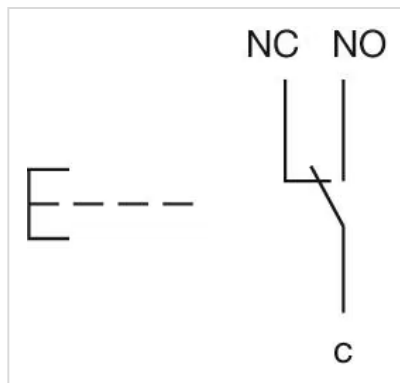

### Mounting cut-outs:

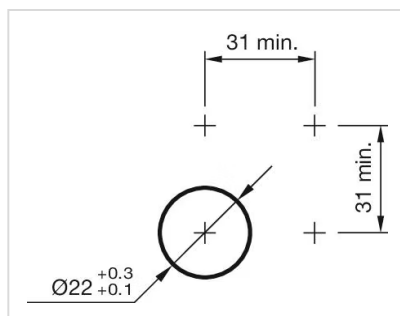

### Component layouts:

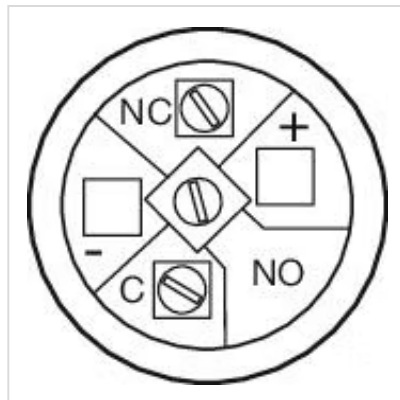

### Dimension drawings:

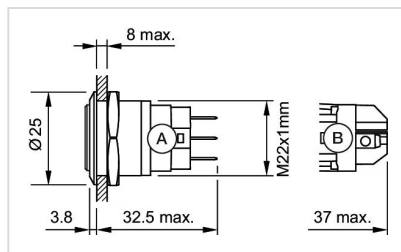

A = Solder terminal  
B = Screw terminal