

Pushbutton Ø 22 mm silver contact

82-6161.2000.B001



<https://eao.com/p/82-6161.2000.B001>

Your product:



82-6161.2000.B001

Pushbutton Ø 22 mm silver contact

FRONT

Front bezel material: Stainless steel

Front bezel shape: flush

MOUNTING

Mounting cut-out: Ø 22 mm

OPERATING-/INDICATION PART

Lens material: Stainless steel

Lens shape: raised

Lens optics: opaque

Lens colour: Silver

Lens illumination: non illuminative

ELECTRICAL CHARACTERISTICS

Electric strength: 1500 VAC, 50 Hz 1 minute between life terminals and ground

Electrical lifetime: 50 000 cycles of operation

Contacts: 1 C

Thermal current I_{th}: 5 A

Rated insulation voltage U_i: 250 V

Switching voltage and switching current:

according to IEC 60947-5-1 (Silver contacts)	
Service categorie AC-15	
Voltage	Current
24 VAC	1 A
35 VAC	1 A (M12 version)
110 VAC	1 A
220 VAC	0.5 A
Switch rating DC service categorie DC-13 (Silver contacts)	
Voltage	Current
24 VDC	0.7 A
35 VDC	0.5 A (M12 version)
110 VDC	0.2 A
220 VDC	0.1 A

according to UL 508 (Silver contacts)	
cosφ 0,75 ... 0,8	
Voltage	Current
120 VAC	5 A
240 VAC	3 A
24 VAC	1 A

Pollution degree:	2, according to EN IEC 60947-1
Rated Operational Voltage Ue:	250 VAC

MECHANICAL CHARATERISTIC

Contact material:	Silver
Terminal:	Soldering terminal, 2.8 x 0.5 mm
Operating Travel:	ca. 3 mm
Switching system:	Snap-action switching element
Operating force:	4 N ... 7 N
Switching action:	Maintained
Mechanical lifetime:	500 000 cycles of operation
Weight:	0.02 kg
Tightening torque:	0.5 ... 0.6 Nm

AMBIENT CONDITION

Storage temperature:	– 40 °C ... + 80 °C
Vibration resistance:	10 ... 500 Hz, amplitude 1.5 mm p-p according to IEC 60068-2-6
Shock resistance:	Max. 500 m / s² as per IEC 60068-2-27
Operating temperature:	– 30 °C ... + 70 °C
Climate resistance:	Damp heat, 21 days according to IEC 60512-11

CERTIFICATE

Approbations: CB, CCC, C UL, UL

Conformities: CE, 2011 / 65 / EC (RoHS), 2014 / 35 / EU (LVD)

OTHER

Symbol: ON/OFF

Short Description: Pushbutton Ø 22 mm silver contact, Maintained, 1 C, Soldering terminal, 2.8 x 0.5 mm, Stainless steel, ON/OFF, Silver

Mounting cut-outs:

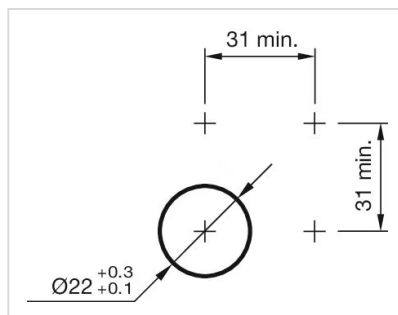

Wiring diagrams:

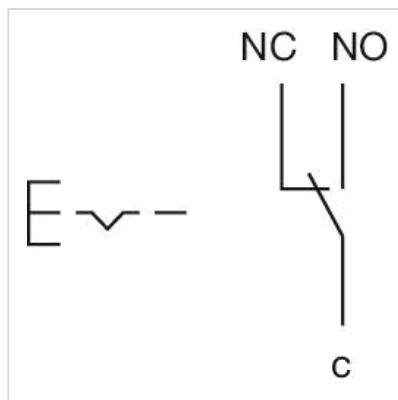

Dimension drawings:

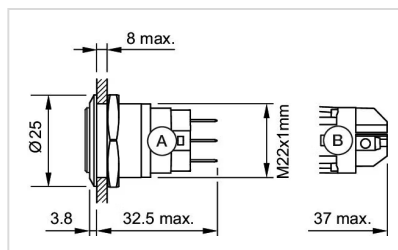

A = Solder terminal
B = Screw terminal

Component layouts:

