

Pushbutton Ø 22 mm silver contact

82-6161.1000.B002



<https://eao.com/p/82-6161.1000.B002>

Your product:



82-6161.1000.B002

Pushbutton Ø 22 mm silver contact

FRONT

Front bezel material: Stainless steel

Front bezel shape: flush

MOUNTING

Mounting cut-out: Ø 22 mm

OPERATING-/INDICATION PART

Lens material: Stainless steel

Lens optics: opaque

Lens shape: flush

Lens colour: Silver

Lens illumination: non illuminative

ELECTRICAL CHARACTERISTICS

Electrical lifetime: 50 000 cycles of operation

Electric strength: 1500 VAC, 50 Hz 1 minute between life terminals and ground

Contacts: 1 C

Rated insulation voltage U_i : 250 V

Thermal current I_{th} : 5 A

Pollution degree: 2, according to EN IEC 60947-1

Switching voltage and switching current:

according to IEC 60947-5-1 (Silver contacts)

Service categorie AC-15

Voltage

24 VAC

35 VAC

110 VAC

220 VAC

Current

1 A

1 A (M12 version)

1 A

0.5 A

Switch rating DC service categorie DC-13 (Silver contacts)

Voltage

24 VDC

35 VDC

110 VDC

220 VDC

Current

0.7 A

0.5 A (M12 version)

0.2 A

0.1 A

according to UL 508 (Silver contacts)

$\cos\phi$ 0,75 ... 0,8

Voltage

120 VAC

240 VAC

24 VAC

Current

5 A

3 A

1 A

Rated Operational Voltage Ue: 250 VAC

MECHANICAL CHARACTERISTIC

Mechanical lifetime: 1 Mio. cycles of operation

Tightening torque: 0.5 ... 0.6 Nm

Weight: 0.02 kg

Switching action: Momentary

Switching system: Snap-action switching element

Operating force: 4 N ... 7 N

Contact material: Silver

Terminal: Soldering terminal, 2.8 x 0.5 mm

Operating Travel: ca. 3 mm

AMBIENT CONDITION

Operating temperature: – 30 °C ... + 70 °C

Storage temperature: – 40 °C ... + 80 °C

Climate resistance: Damp heat, 21 days according to IEC 60512-11

Vibration resistance: 10 ... 500 Hz, amplitude 1.5 mm p-p according to IEC 60068-2-6

Shock resistance: Max. 500 m / s² as per IEC 60068-2-27

CERTIFICATE

Approbations: CB, CCC, C UL, UL

Conformities: CE, 2011 / 65 / EC (RoHS), 2014 / 35 / EU (LVD)

OTHER

Short Description: Pushbutton Ø 22 mm silver contact, Momentary, 1 C, Soldering terminal, 2.8 x 0.5 mm, Stainless steel, Standby, Silver

Symbol: Standby

Component layouts:

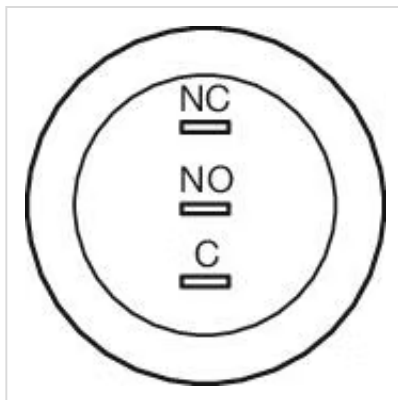

Mounting cut-outs:

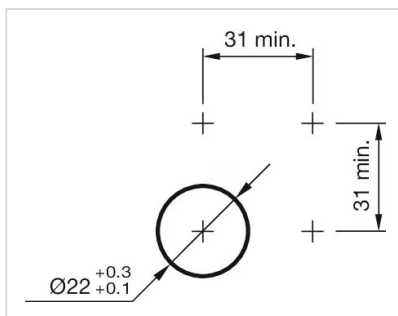

Wiring diagrams:

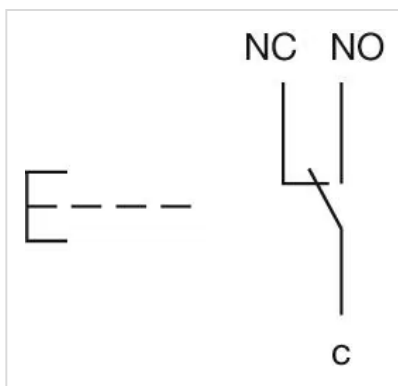

Dimension drawings:

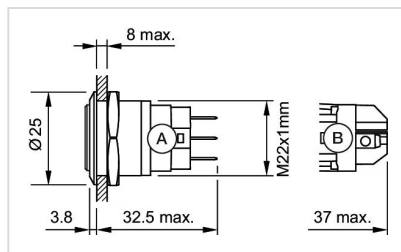

A = Solder terminal
B = Screw terminal