

# Illuminated pushbutton Ø 22 mm silver contact

82-6152.21A4



<https://eao.com/p/82-6152.21A4>

Your product:

---



## 82-6152.21A4

Illuminated pushbutton Ø  
22 mm silver contact

### FRONT

Front bezel shape:	flush
Front bezel material:	Stainless steel

### MOUNTING

Mounting cut-out:	Ø 22 mm
-------------------	---------

### OPERATING-/INDICATION PART

Illumination colour:	Red / Green
Lens material:	Stainless steel
Lens colour:	Silver
Lens shape:	flush
Lens illumination:	illuminative
Lens optics:	opaque
Shape of illumination:	Ring

### ELECTRICAL CHARACTERISTICS

Rated insulation voltage $U_i$ :	250 V
Switching voltage and switching current:	

according to IEC 60947-5-1 (Silver contacts)

Service categorie AC-15

Voltage

24 VAC

35 VAC

110 VAC

220 VAC

Current

1 A

1 A (M12 version)

1 A

0.5 A

Switch rating DC service categorie DC-13 (Silver contacts)

Voltage

24 VDC

35 VDC

110 VDC

220 VDC

Current

0.7 A

0.5 A (M12 version)

0.2 A

0.1 A

according to UL 508 (Silver contacts)

$\cos\phi$  0,75 ... 0,8

Voltage

120 VAC

240 VAC

24 VAC

Current

5 A

3 A

1 A

<b>Rated Operational Voltage Ue:</b>	250 VAC
<b>Operating voltage:</b>	24 V AC/DC
<b>Contacts:</b>	1 C
<b>Thermal current Ith:</b>	5 A
<b>Electrical lifetime:</b>	50 000 cycles of operation
<b>Electric strength:</b>	1500 VAC, 50 Hz 1 minute between life terminals and ground
<b>Pollution degree:</b>	2, according to EN IEC 60947-1

### MECHANICAL CHARACTERISTIC

<b>Operating force:</b>	4 N ... 7 N
<b>Operating Travel:</b>	ca. 3 mm
<b>Switching system:</b>	Snap-action switching element
<b>Mechanical lifetime:</b>	500 000 cycles of operation
<b>Tightening torque:</b>	0.5 ... 0.6 Nm, Screw terminal 0.1 Nm
<b>Switching action:</b>	Maintained
<b>Weight:</b>	0.018 kg
<b>Terminal:</b>	Screw terminal
<b>Contact material:</b>	Silver

### AMBIENT CONDITION

<b>Operating temperature:</b>	- 30 °C ... + 70 °C
<b>Vibration resistance:</b>	

10 ... 500 Hz, amplitude 1.5 mm p-p according to IEC 60068-2-6

**Storage temperature:** - 40 °C ... + 80 °C

**Shock resistance:** Max. 500 m / s<sup>2</sup> as per IEC 60068-2-27

**Climate resistance:** Damp heat, 21 days according to IEC 60512-11

**CERTIFICATE**

**Approbations:** CB, CCC, C UL, UL

**Conformities:** CE, 2011 / 65 / EC (RoHS), 2014 / 35 / EU (LVD)

**OTHER**

**Short Description:** Illuminated pushbutton Ø 22 mm silver contact, Maintained, 24 V AC/DC, 1 C, Screw terminal, Stainless steel, Red / Green, Silver

**Kind of illumination:** Bi-colour-LED

**Wiring diagrams:**

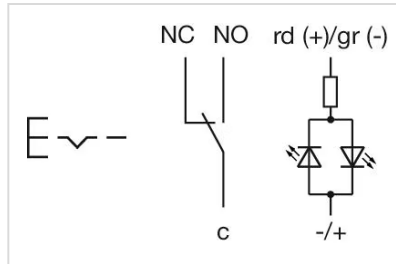

**Dimension drawings:**

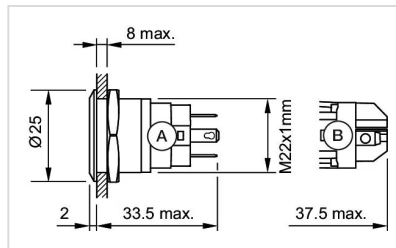

A = Solder terminal  
B = Screw terminal

**Mounting cut-outs:**

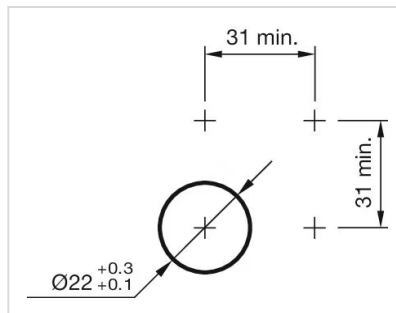

**Component layouts:**

