

Illuminated pushbutton Ø 22 mm silver contact

82-6152.2134.B001



<https://eao.com/p/82-6152.2134.B001>

Your product:



82-6152.2134.B001
Illuminated pushbutton Ø
22 mm silver contact

FRONT

Front bezel material: Stainless steel

Front bezel shape: flush

MOUNTING

Mounting cut-out: Ø 22 mm

OPERATING-/INDICATION PART

Lens colour: Silver

Lens illumination: illuminative

Illumination colour: Green

Shape of illumination: Ring

Lens optics: opaque

Lens shape: flush

Lens material: Stainless steel

ELECTRICAL CHARACTERISTICS

Electrical lifetime: 50 000 cycles of operation

Contacts: 1 C

Rated insulation voltage U_i : 250 V

Operating voltage: 24 V AC/DC

Electric strength: 1500 VAC, 50 Hz 1 minute between life terminals and ground

Switching voltage and switching current:

according to IEC 60947-5-1 (Silver contacts)	
Service categorie AC-15	
Voltage	Current
24 VAC	1 A
35 VAC	1 A (M12 version)
110 VAC	1 A
220 VAC	0.5 A
Switch rating DC service categorie DC-13 (Silver contacts)	
Voltage	Current
24 VDC	0.7 A
35 VDC	0.5 A (M12 version)
110 VDC	0.2 A
220 VDC	0.1 A

according to UL 508 (Silver contacts)	
cosφ 0,75 ... 0,8	
Voltage	Current
120 VAC	5 A
240 VAC	3 A
24 VAC	1 A

Pollution degree:	2, according to EN IEC 60947-1
Thermal current I_{th}:	5 A
Rated Operational Voltage U_e:	250 VAC

MECHANICAL CHARACTERISTIC

Switching system:	Snap-action switching element
Mechanical lifetime:	500 000 cycles of operation
Switching action:	Maintained
Operating force:	4 N ... 7 N
Operating Travel:	ca. 3 mm
Terminal:	Screw terminal
Weight:	0.018 kg
Tightening torque:	0.5 ... 0.6 Nm, Screw terminal 0.1 Nm
Contact material:	Silver

AMBIENT CONDITION

Vibration resistance:	10 ... 500 Hz, amplitude 1.5 mm p-p according to IEC 60068-2-6
Storage temperature:	– 40 °C ... + 80 °C
Climate resistance:	Damp heat, 21 days according to IEC 60512-11
Shock resistance:	Max. 500 m / s ² as per IEC 60068-2-27
Operating temperature:	– 30 °C ... + 70 °C

CERTIFICATE

Approbations:

CB, CCC, C UL, UL

Conformities:

CE, 2011 / 65 / EC (RoHS), 2014 / 35 / EU (LVD)

OTHER

Kind of illumination:

Single-LED

Short Description:

Illuminated pushbutton Ø 22 mm silver contact, Maintained, 24 V AC/DC, 1 C, Screw terminal, Stainless steel, Green, ON/OFF, Silver

Symbol:

ON/OFF

Wiring diagrams:

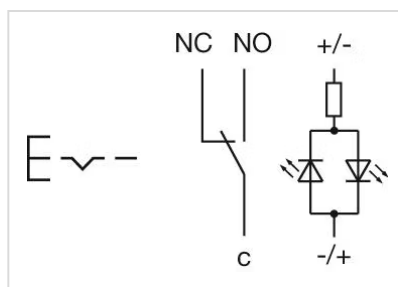

Component layouts:

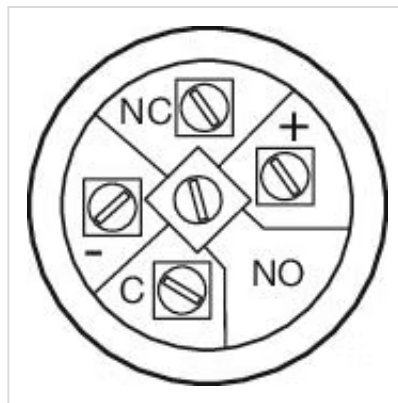

Mounting cut-outs:

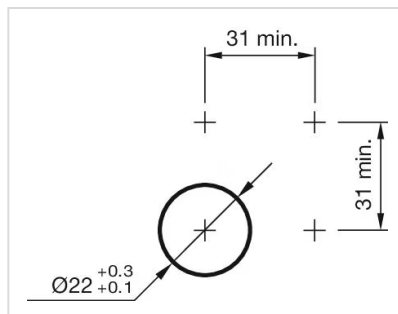

Dimension drawings:

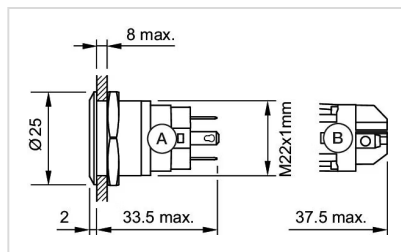

A = Solder terminal
B = Screw terminal