

Illuminated pushbutton Ø 22 mm silver contact

82-6152.2133.B001



<https://eao.com/p/82-6152.2133.B001>

Your product:



82-6152.2133.B001
Illuminated pushbutton Ø
22 mm silver contact

FRONT

Front bezel shape:	flush
Front bezel material:	Stainless steel

MOUNTING

Mounting cut-out:	Ø 22 mm
-------------------	---------

OPERATING-/INDICATION PART

Illumination colour:	Green
Lens colour:	Silver
Lens illumination:	illuminative
Lens material:	Stainless steel
Lens optics:	opaque
Shape of illumination:	Ring
Lens shape:	flush

ELECTRICAL CHARACTERISTICS

Contacts:	1 C
Electrical lifetime:	50 000 cycles of operation
Electric strength:	1500 VAC, 50 Hz 1 minute between life terminals and ground
Pollution degree:	2, according to EN IEC 60947-1
Thermal current I _{th} :	5 A
Operating voltage:	12 V AC/DC

Rated insulation voltage Ui:	250 V		
Switching voltage and switching current:	according to IEC 60947-5-1 (Silver contacts) Service categorie AC-15 Voltage 24 VAC 35 VAC 110 VAC 220 VAC Switch rating DC service categorie DC-13 (Silver contacts) Voltage 24 VDC 35 VDC 110 VDC 220 VDC		
		Current	1 A
			1 A (M12 versio
			1 A
			0.5 A
		Current	0.7 A
			0.5 A (M12 vers
			0.2 A
			0.1 A
	according to UL 508 (Silver contacts) cosφ 0,75 ... 0,8 Voltage 120 VAC 240 VAC 24 VAC		
		Current	5 A
			3 A
			1 A

Rated Operational Voltage Ue: 250 VAC

MECHANICAL CHARATERISTIC

Operating Travel:	ca. 3 mm
Tightening torque:	0.5 ... 0.6 Nm, Screw terminal 0.1 Nm
Weight:	0.018 kg
Terminal:	Screw terminal
Switching action:	Maintained
Operating force:	4 N ... 7 N
Contact material:	Silver
Mechanical lifetime:	500 000 cycles of operation
Switching system:	Snap-action switching element

AMBIENT CONDITION

Storage temperature:	– 40 °C ... + 80 °C
Shock resistance:	Max. 500 m / s ² as per IEC 60068-2-27
Operating temperature:	– 30 °C ... + 70 °C
Climate resistance:	Damp heat, 21 days according to IEC 60512-11
Vibration resistance:	10 ... 500 Hz, amplitude 1.5 mm p-p according to IEC 60068-2-6

CERTIFICATE

Approbations: CB, CCC, C UL, UL

Conformities: CE, 2011 / 65 / EC (RoHS), 2014 / 35 / EU (LVD)

OTHER

Kind of illumination: Single-LED

Symbol: ON/OFF

Short Description: Illuminated pushbutton Ø 22 mm silver contact, Maintained, 12 V AC/DC, 1 C, Screw terminal, Stainless steel, Green, ON/OFF, Silver

Component layouts:

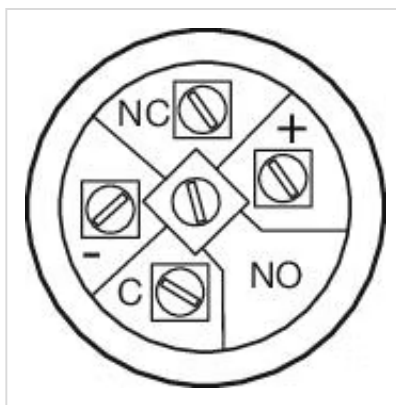

Dimension drawings:

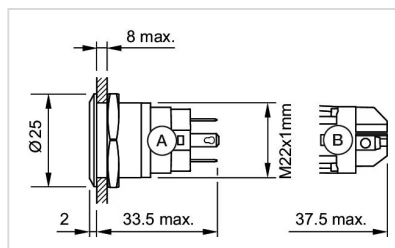

A = Solder terminal
B = Screw terminal

Mounting cut-outs:

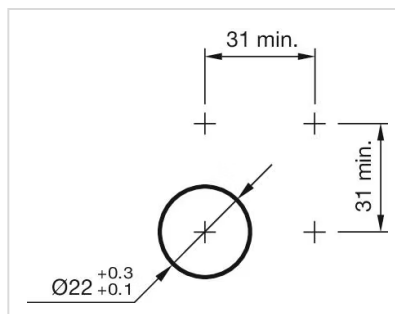

Wiring diagrams:

