

## Illuminated pushbutton Ø 22 mm silver contact

82-6152.2124.B001



<https://eao.com/p/82-6152.2124.B001>

Your product:

---



## 82-6152.2124.B001

### Illuminated pushbutton Ø 22 mm silver contact

#### FRONT

**Front bezel material:** Stainless steel

**Front bezel shape:** flush

#### MOUNTING

**Mounting cut-out:** Ø 22 mm

#### OPERATING-/INDICATION PART

**Illumination colour:** Blue

**Lens shape:** flush

**Lens material:** Stainless steel

**Shape of illumination:** Ring

**Lens illumination:** illuminative

**Lens colour:** Silver

**Lens optics:** opaque

#### ELECTRICAL CHARACTERISTICS

**Electrical lifetime:** 50 000 cycles of operation

**Rated Operational Voltage  $U_e$ :** 250 VAC

**Pollution degree:** 2, according to EN IEC 60947-1

**Rated insulation voltage  $U_i$ :** 250 V

**Electric strength:** 1500 VAC, 50 Hz 1 minute between life terminals and ground

**Operating voltage:** 24 V AC/DC

<b>Thermal current I<sub>th</sub>:</b>	5 A		
<b>Contacts:</b>	1 C		
<b>Switching voltage and switching current:</b>	according to IEC 60947-5-1 (Silver contacts) Service categorie AC-15 Voltage 24 VAC 35 VAC 110 VAC 220 VAC Switch rating DC service categorie DC-13 (Silver contacts) Voltage 24 VDC 35 VDC 110 VDC 220 VDC		
			Current 1 A 1 A (M12 versio 1 A 0.5 A
			Current 0.7 A 0.5 A (M12 vers 0.2 A 0.1 A
	according to UL 508 (Silver contacts) cosφ 0,75 ... 0,8 Voltage 120 VAC 240 VAC 24 VAC		
		Current	5 A 3 A 1 A

## MECHANICAL CHARACTERISTIC

<b>Operating Travel:</b>	ca. 3 mm
<b>Mechanical lifetime:</b>	500 000 cycles of operation
<b>Operating force:</b>	4 N ... 7 N
<b>Switching action:</b>	Maintained
<b>Terminal:</b>	Screw terminal
<b>Tightening torque:</b>	0.5 ... 0.6 Nm, Screw terminal 0.1 Nm
<b>Weight:</b>	0.018 kg
<b>Contact material:</b>	Silver
<b>Switching system:</b>	Snap-action switching element

## AMBIENT CONDITION

<b>Storage temperature:</b>	– 40 °C ... + 80 °C
<b>Climate resistance:</b>	Damp heat, 21 days according to IEC 60512-11
<b>Vibration resistance:</b>	10 ... 500 Hz, amplitude 1.5 mm p-p according to IEC 60068-2-6
<b>Operating temperature:</b>	– 30 °C ... + 70 °C
<b>Shock resistance:</b>	Max. 500 m / s <sup>2</sup> as per IEC 60068-2-27

## CERTIFICATE

**Conformities:** CE, 2011 / 65 / EC (RoHS), 2014 / 35 / EU (LVD)

**Approbations:** CB, CCC, C UL, UL

## OTHER

**Short Description:** Illuminated pushbutton Ø 22 mm silver contact, Maintained, 24 V AC/DC, 1 C, Screw terminal, Stainless steel, Blue, ON/OFF, Silver

**Symbol:** ON/OFF

**Kind of illumination:** Single-LED

**Wiring diagrams:**

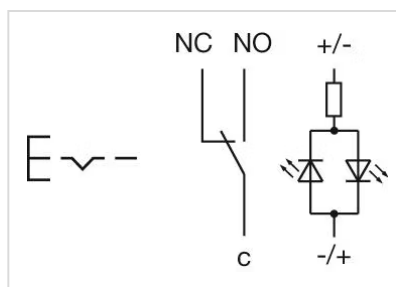

**Mounting cut-outs:**

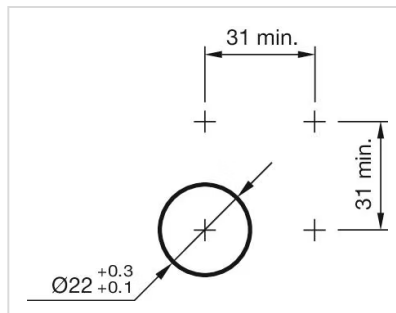

**Dimension drawings:**

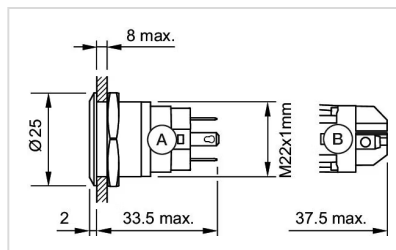

A = Solder terminal  
B = Screw terminal

**Component layouts:**

