

Illuminated pushbutton Ø 22 mm silver contact

82-6151.2113.B001



<https://eao.com/p/82-6151.2113.B001>

Your product:



82-6151.2113.B001
Illuminated pushbutton Ø
22 mm silver contact

FRONT

Front bezel material: Stainless steel

Front bezel shape: flush

MOUNTING

Mounting cut-out: Ø 22 mm

OPERATING-/INDICATION PART

Lens shape: flush

Lens colour: Silver

Lens material: Stainless steel

Lens optics: opaque

Illumination colour: Red

Shape of illumination: Ring

Lens illumination: illuminative

ELECTRICAL CHARACTERISTICS

Electrical lifetime: 50 000 cycles of operation

Operating voltage: 12 V AC/DC

Rated Operational Voltage Ue: 250 VAC

Pollution degree: 2, according to EN IEC 60947-1

Thermal current Ith: 5 A

Rated insulation voltage Ui: 250 V

Switching voltage and switching current:

according to IEC 60947-5-1 (Silver contacts)		
Service categorie AC-15		
Voltage		Current
24 VAC		1 A
35 VAC		1 A (M12 versio
110 VAC		1 A
220 VAC		0.5 A
Switch rating DC service categorie DC-13 (Silver contacts)		
Voltage		Current
24 VDC		0.7 A
35 VDC		0.5 A (M12 vers
110 VDC		0.2 A
220 VDC		0.1 A

according to UL 508 (Silver contacts)

cosφ 0,75 ... 0,8

Voltage	Current
120 VAC	5 A
240 VAC	3 A
24 VAC	1 A

Electric strength:

1500 VAC, 50 Hz 1 minute between life terminals and ground

Contacts:

1 C

MECHANICAL CHARACTERISTIC**Terminal:**

Soldering terminal, 2.8 x 0.5 mm

Tightening torque:

0.5 ... 0.6 Nm

Operating force:

4 N ... 7 N

Weight:

0.018 kg

Switching action:

Maintained

Operating Travel:

ca. 3 mm

Contact material:

Silver

Switching system:

Snap-action switching element

Mechanical lifetime:

500 000 cycles of operation

AMBIENT CONDITION**Vibration resistance:**

10 ... 500 Hz, amplitude 1.5 mm p-p according to IEC 60068-2-6

Storage temperature:

– 40 °C ... + 80 °C

Operating temperature:

– 30 °C ... + 70 °C

Shock resistance:

Max. 500 m / s² as per IEC 60068-2-27

Climate resistance:

Damp heat, 21 days according to IEC 60512-11

CERTIFICATE

Approbations: CB, CCC, C UL, UL

Conformities: CE, 2011 / 65 / EC (RoHS), 2014 / 35 / EU (LVD)

OTHER

Short Description: Illuminated pushbutton Ø 22 mm silver contact, Maintained, 12 V AC/DC, 1 C, Soldering terminal, 2.8 x 0.5 mm, Stainless steel, Red, ON/OFF, Silver

Kind of illumination: Single-LED

Symbol: ON/OFF

Component layouts:

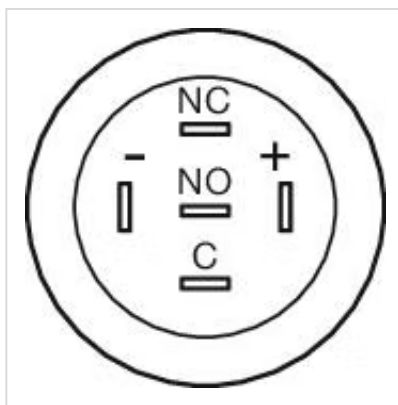

Mounting cut-outs:

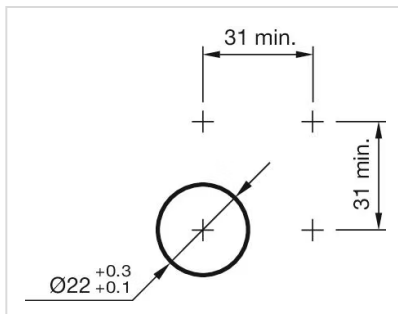

Dimension drawings:

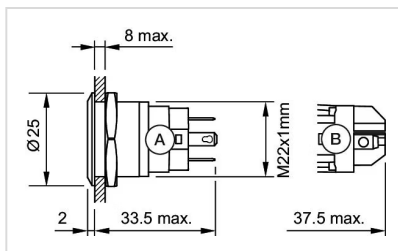

A = Solder terminal
B = Screw terminal

Wiring diagrams:

