

Illuminated pushbutton Ø 22 mm stainless steel 304, with symbol

82-6151.1AA4.B006



<https://eao.com/p/82-6151.1AA4.B006>

Your product:



82-6151.1AA4.B006

Illuminated pushbutton Ø 22 mm
stainless steel 304, with symbol

FRONT

Front bezel material: Stainless steel

MOUNTING

Mounting cut-out: Ø 22 mm

OPERATING-/INDICATION PART

Illumination colour: Red/Green

Lens shape: flush

Lens colour: Silver

Lens optics: opaque

Shape of illumination: Symbol

Lens material: Plastic metalised

Lens illumination: illuminative

ELECTRICAL CHARACTERISTICS

Operating voltage: 24 V DC

Electric strength: 1500 VAC, 50 Hz 1 minute between life terminals and ground

Thermal current I_{th}: 5 A

Rated Operational Voltage U_e: 250 VAC

Electrical lifetime: 50 000 cycles of operation

Contacts: 1 C

Rated insulation voltage U_i: 250 V

Switching voltage and switching current:

according to IEC 60947-5-1 (Silver contacts)		
Service categorie AC-15		
Voltage		Current
24 VAC		1 A
35 VAC		1 A (M12 versio
110 VAC		1 A
220 VAC		0.5 A
Switch rating DC service categorie DC-13 (Silver contacts)		
Voltage		Current
24 VDC		0.7 A
35 VDC		0.5 A (M12 vers
110 VDC		0.2 A
220 VDC		0.1 A

according to UL 508 (Silver contacts)	
$\cos\phi$ 0,75 ... 0,8	
Voltage	Current
120 VAC	5 A
240 VAC	3 A
24 VAC	1 A

Pollution degree: 2, according to EN IEC 60947-1

MECHANICAL CHARACTERISTIC

Operating force:	4 N ... 7 N
Tightening torque:	0.5 ... 0.6 Nm
Mechanical lifetime:	1 Mio. cycles of operation
Switching system:	Snap-action switching element
Operating Travel:	ca. 3 mm
Terminal:	Soldering terminal, 2.8 x 0.5 mm
Switching action:	Momentary
Weight:	0.025 kg
Contact material:	Silver

AMBIENT CONDITION

Vibration resistance:	10 ... 500 Hz, amplitude 1.5 mm p-p according to IEC 60068-2-6
Shock resistance:	Max. 500 m / s ² as per IEC 60068-2-27
Operating temperature:	- 30 °C ... + 70 °C
Climate resistance:	Damp heat, 21 days according to IEC 60512-11
Storage temperature:	- 40 °C ... + 80 °C

CERTIFICATE

Conformities: CE, 2011 / 65 / EC (RoHS), 2014 / 35 / EU (LVD)

Approbations: CB, CCC, C UL, UL

OTHER

Symbol: Door open

Kind of illumination: Bi-colour-LED

Short Description: Illuminated pushbutton Ø 22 mm stainless steel 304, with symbol, Momentary, 24 V DC, 1 C, Soldering terminal, 2.8 x 0.5 mm, Stainless steel, Red/Green, Door open, Silver

Mounting cut-outs:

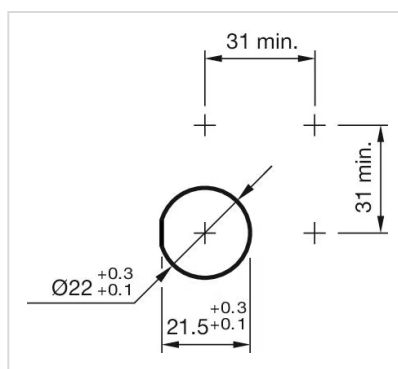

Wiring diagrams:

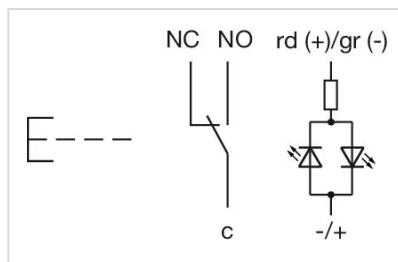

Component layouts:

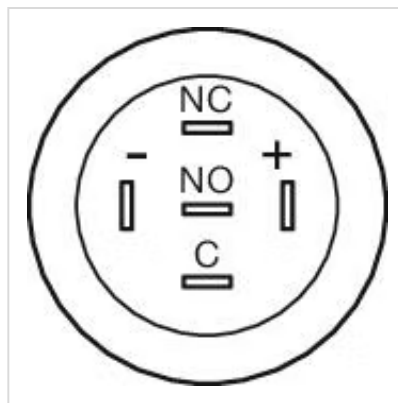

Dimension drawings:

