

Illuminated pushbutton Ø 22 mm stainless steel 304, with symbol

82-6151.1A34.B006



<https://eao.com/p/82-6151.1A34.B006>

Your product:



82-6151.1A34.B006
Illuminated pushbutton Ø 22 mm
stainless steel 304, with symbol

FRONT

Front bezel material: Stainless steel

MOUNTING

Mounting cut-out: Ø 22 mm

OPERATING-/INDICATION PART

Lens illumination: illuminative

Lens optics: opaque

Lens material: Plastic metalised

Lens colour: Silver

Shape of illumination: Symbol

Illumination colour: Blue

Lens shape: flush

ELECTRICAL CHARACTERISTICS

Electrical lifetime: 50 000 cycles of operation

Switching voltage and switching current:	according to IEC 60947-5-1 (Silver contacts)	
	Service categorie AC-15	
	Voltage	Current
	24 VAC	1 A
	35 VAC	1 A (M12 versio
	110 VAC	1 A
	220 VAC	0.5 A
	Switch rating DC service categorie DC-13 (Silver contacts)	
	Voltage	Current
	24 VDC	0.7 A
35 VDC	0.5 A (M12 vers	
110 VDC	0.2 A	
220 VDC	0.1 A	

according to UL 508 (Silver contacts)

$\cos\phi$ 0,75 ... 0,8

Voltage

120 VAC

240 VAC

24 VAC

Current

5 A

3 A

1 A

Thermal current I_{th}:	5 A
Contacts:	1 C
Operating voltage:	24 V DC
Electric strength:	1500 VAC, 50 Hz 1 minute between life terminals and ground
Rated insulation voltage U_i:	250 V
Pollution degree:	2, according to EN IEC 60947-1
Rated Operational Voltage U_e:	250 VAC

MECHANICAL CHARACTERISTIC

Mechanical lifetime:	1 Mio. cycles of operation
Terminal:	Soldering terminal, 2.8 x 0.5 mm
Weight:	0.025 kg
Contact material:	Silver
Switching action:	Momentary
Tightening torque:	0.5 ... 0.6 Nm
Operating force:	4 N ... 7 N
Switching system:	Snap-action switching element
Operating Travel:	ca. 3 mm

AMBIENT CONDITION

Vibration resistance:	10 ... 500 Hz, amplitude 1.5 mm p-p according to IEC 60068-2-6
Shock resistance:	Max. 500 m / s ² as per IEC 60068-2-27
Storage temperature:	- 40 °C ... + 80 °C
Operating temperature:	- 30 °C ... + 70 °C
Climate resistance:	Damp heat, 21 days according to IEC 60512-11

CERTIFICATE

Conformities:	CE, 2011 / 65 / EC (RoHS), 2014 / 35 / EU (LVD)
----------------------	---

Approbations:

CB, CCC, C UL, UL

OTHER**Short Description:**

Illuminated pushbutton Ø 22 mm stainless steel 304, with symbol, Momentary, 24 V DC, 1 C, Soldering terminal, 2.8 x 0.5 mm, Stainless steel, Blue, Door open, Silver

Kind of illumination:

Single-LED

Symbol:

Door open

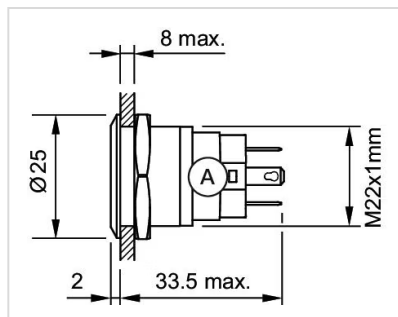
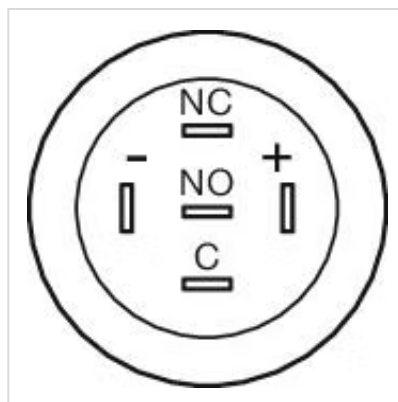
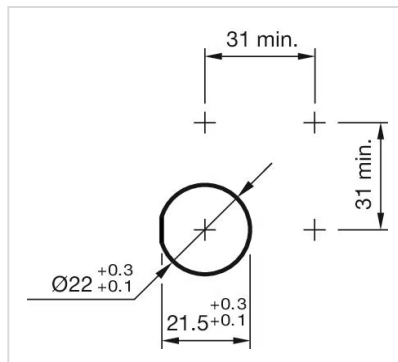
Dimension drawings:**Component layouts:****Mounting cut-outs:****Wiring diagrams:**

