

Illuminated pushbutton Ø 22 mm silver contact

82-6151.1133.B001



<https://eao.com/p/82-6151.1133.B001>

Your product:



82-6151.1133.B001
Illuminated pushbutton Ø
22 mm silver contact

FRONT

Front bezel shape:	flush
Front bezel material:	Stainless steel

MOUNTING

Mounting cut-out:	Ø 22 mm
-------------------	---------

OPERATING-/INDICATION PART

Lens colour:	Silver
Shape of illumination:	Ring
Lens optics:	opaque
Lens shape:	flush
Lens illumination:	illuminative
Illumination colour:	Green
Lens material:	Stainless steel

ELECTRICAL CHARACTERISTICS

Rated insulation voltage U_i :	250 V
Contacts:	1 C
Operating voltage:	12 V AC/DC
Pollution degree:	2, according to EN IEC 60947-1
Electric strength:	1500 VAC, 50 Hz 1 minute between life terminals and ground
Electrical lifetime:	50 000 cycles of operation

Thermal current I_{th}:	5 A		
Switching voltage and switching current:	according to IEC 60947-5-1 (Silver contacts) Service categorie AC-15 Voltage 24 VAC 35 VAC 110 VAC 220 VAC Switch rating DC service categorie DC-13 (Silver contacts) Voltage 24 VDC 35 VDC 110 VDC 220 VDC	Current 1 A 1 A (M12 versio 1 A 0.5 A Current 0.7 A 0.5 A (M12 vers 0.2 A 0.1 A	
	according to UL 508 (Silver contacts) cosφ 0,75 ... 0,8 Voltage 120 VAC 240 VAC 24 VAC	Current 5 A 3 A 1 A	

Rated Operational Voltage U_e: 250 VAC

MECHANICAL CHARACTERISTIC

Tightening torque:	0.5 ... 0.6 Nm
Operating Travel:	ca. 3 mm
Operating force:	4 N ... 7 N
Terminal:	Soldering terminal, 2.8 x 0.5 mm
Switching system:	Snap-action switching element
Mechanical lifetime:	1 Mio. cycles of operation
Weight:	0.018 kg
Switching action:	Momentary
Contact material:	Silver

AMBIENT CONDITION

Climate resistance:	Damp heat, 21 days according to IEC 60512-11
Shock resistance:	Max. 500 m / s ² as per IEC 60068-2-27
Storage temperature:	– 40 °C ... + 80 °C
Vibration resistance:	10 ... 500 Hz, amplitude 1.5 mm p-p according to IEC 60068-2-6
Operating temperature:	– 30 °C ... + 70 °C

CERTIFICATE

Approbations:

CB, CCC, C UL, UL

Conformities:

CE, 2011 / 65 / EC (RoHS), 2014 / 35 / EU (LVD)

OTHER

Short Description:

Illuminated pushbutton Ø 22 mm silver contact, Momentary, 12 V AC/DC, 1 C, Soldering terminal, 2.8 x 0.5 mm, Stainless steel, Green, ON/OFF, Silver

Symbol:

ON/OFF

Kind of illumination:

Single-LED

Mounting cut-outs:

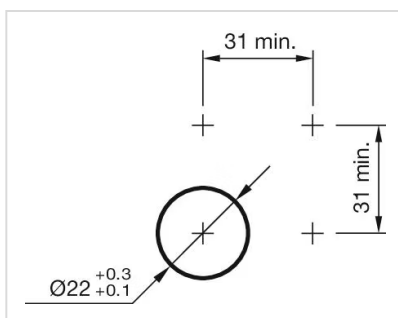

Dimension drawings:

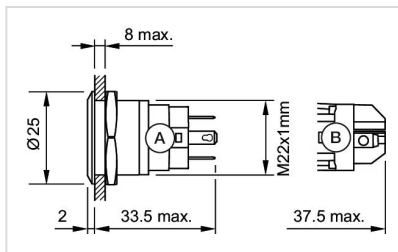

A = Solder terminal
B = Screw terminal

Component layouts:

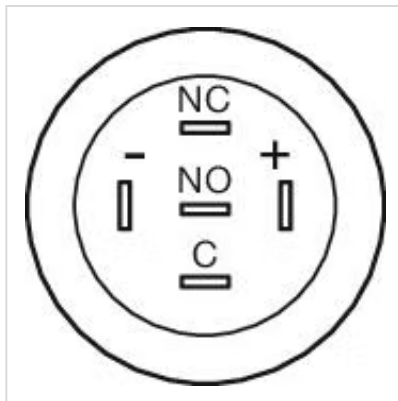

Wiring diagrams:

