

## Illuminated pushbutton Ø 22 mm silver contact

82-6151.1123.B001



<https://eao.com/p/82-6151.1123.B001>

Your product:

---



82-6151.1123.B001  
Illuminated pushbutton Ø  
22 mm silver contact

#### FRONT

**Front bezel material:** Stainless steel

**Front bezel shape:** flush

#### MOUNTING

**Mounting cut-out:** Ø 22 mm

#### OPERATING-/INDICATION PART

**Lens shape:** flush

**Lens colour:** Silver

**Lens optics:** opaque

**Lens material:** Stainless steel

**Shape of illumination:** Ring

**Lens illumination:** illuminative

**Illumination colour:** Blue

#### ELECTRICAL CHARACTERISTICS

**Contacts:** 1 C

**Operating voltage:** 12 V AC/DC

**Switching voltage and switching current:**

according to IEC 60947-5-1 (Silver contacts)	
Service categorie AC-15	
Voltage	Current
24 VAC	1 A
35 VAC	1 A (M12 version)
110 VAC	1 A
220 VAC	0.5 A
Switch rating DC service categorie DC-13 (Silver contacts)	
Voltage	Current
24 VDC	0.7 A
35 VDC	0.5 A (M12 version)
110 VDC	0.2 A
220 VDC	0.1 A

according to UL 508 (Silver contacts)	
cosφ 0,75 ... 0,8	
Voltage	Current
120 VAC	5 A
240 VAC	3 A
24 VAC	1 A

<b>Pollution degree:</b>	2, according to EN IEC 60947-1
<b>Electrical lifetime:</b>	50 000 cycles of operation
<b>Electric strength:</b>	1500 VAC, 50 Hz 1 minute between life terminals and ground
<b>Rated Operational Voltage Ue:</b>	250 VAC
<b>Rated insulation voltage Ui:</b>	250 V
<b>Thermal current Ith:</b>	5 A

## MECHANICAL CHARACTERISTIC

<b>Weight:</b>	0.018 kg
<b>Mechanical lifetime:</b>	1 Mio. cycles of operation
<b>Tightening torque:</b>	0.5 ... 0.6 Nm
<b>Switching system:</b>	Snap-action switching element
<b>Operating force:</b>	4 N ... 7 N
<b>Switching action:</b>	Momentary
<b>Operating Travel:</b>	ca. 3 mm
<b>Terminal:</b>	Soldering terminal, 2.8 x 0.5 mm
<b>Contact material:</b>	Silver

## AMBIENT CONDITION

<b>Vibration resistance:</b>	10 ... 500 Hz, amplitude 1.5 mm p-p according to IEC 60068-2-6
<b>Shock resistance:</b>	Max. 500 m / s <sup>2</sup> as per IEC 60068-2-27
<b>Storage temperature:</b>	

– 40 °C ... + 80 °C

**Operating temperature:**

– 30 °C ... + 70 °C

**Climate resistance:**

Damp heat, 21 days according to IEC 60512-11

## CERTIFICATE

**Approbations:**

CB, CCC, C UL, UL

**Conformities:**

CE, 2011 / 65 / EC (RoHS), 2014 / 35 / EU (LVD)

## OTHER

**Symbol:**

ON/OFF

**Kind of illumination:**

Single-LED

**Short Description:**

Illuminated pushbutton Ø 22 mm silver contact, Momentary, 12 V AC/DC, 1 C, Soldering terminal, 2.8 x 0.5 mm, Stainless steel, Blue, ON/OFF, Silver

**Wiring diagrams:**

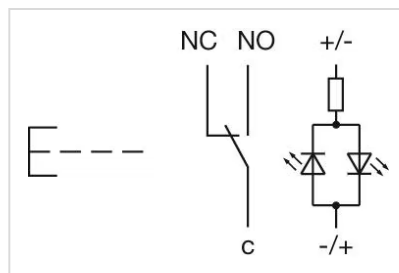

**Mounting cut-outs:**

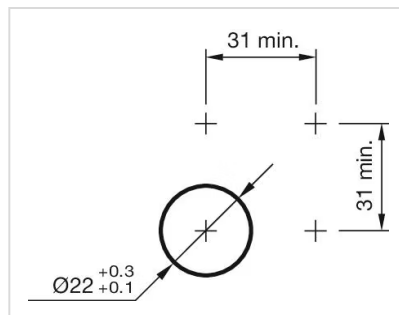

**Component layouts:**



**Dimension drawings:**

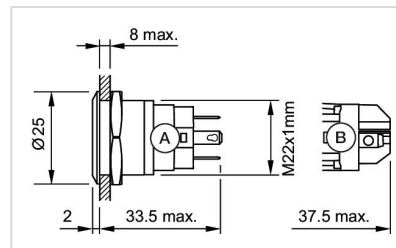

A = Solder terminal  
B = Screw terminal