

Pushbutton Ø 22 mm silver contact

82-6151.1000.B001



<https://eao.com/p/82-6151.1000.B001>

Your product:



82-6151.1000.B001

Pushbutton Ø 22 mm silver contact

FRONT

Front bezel material: Stainless steel

Front bezel shape: flush

MOUNTING

Mounting cut-out: Ø 22 mm

OPERATING-/INDICATION PART

Lens optics: opaque

Lens illumination: non illuminative

Lens material: Stainless steel

Lens shape: flush

Lens colour: Silver

ELECTRICAL CHARACTERISTICS

Electric strength: 1500 VAC, 50 Hz 1 minute between life terminals and ground

Thermal current I_{th}: 5 A

Rated Operational Voltage U_e: 250 VAC

Switching voltage and switching current:

according to IEC 60947-5-1 (Silver contacts)	
Service categorie AC-15	
Voltage	Current
24 VAC	1 A
35 VAC	1 A (M12 version)
110 VAC	1 A
220 VAC	0.5 A
Switch rating DC service categorie DC-13 (Silver contacts)	
Voltage	Current
24 VDC	0.7 A
35 VDC	0.5 A (M12 version)
110 VDC	0.2 A
220 VDC	0.1 A

according to UL 508 (Silver contacts)	
cosφ 0,75 ... 0,8	
Voltage	Current
120 VAC	5 A
240 VAC	3 A
24 VAC	1 A

Pollution degree:	2, according to EN IEC 60947-1
Rated insulation voltage Ui:	250 V
Contacts:	1 C
Electrical lifetime:	50 000 cycles of operation

MECHANICAL CHARACTERISTIC

Mechanical lifetime:	1 Mio. cycles of operation
Switching system:	Snap-action switching element
Switching action:	Momentary
Tightening torque:	0.5 ... 0.6 Nm
Contact material:	Silver
Weight:	0.018 kg
Operating force:	4 N ... 7 N
Operating Travel:	ca. 3 mm
Terminal:	Soldering terminal, 2.8 x 0.5 mm

AMBIENT CONDITION

Shock resistance:	Max. 500 m / s ² as per IEC 60068-2-27
Storage temperature:	– 40 °C ... + 80 °C
Climate resistance:	Damp heat, 21 days according to IEC 60512-11
Operating temperature:	– 30 °C ... + 70 °C
Vibration resistance:	

10 ... 500 Hz, amplitude 1.5 mm p-p according to IEC 60068-2-6

CERTIFICATE

Conformities: CE, 2011 / 65 / EC (RoHS), 2014 / 35 / EU (LVD)

Approbations: CB, CCC, C UL, UL

OTHER

Short Description: Pushbutton Ø 22 mm silver contact, Momentary, 1 C, Soldering terminal, 2.8 x 0.5 mm, Stainless steel, ON/OFF, Silver

Symbol: ON/OFF

Wiring diagrams:

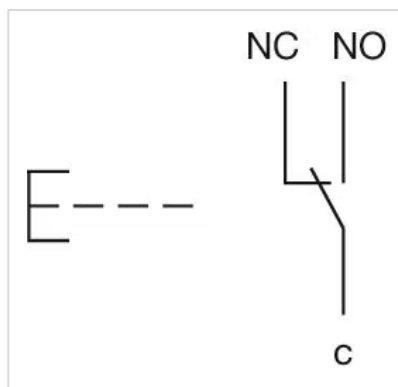

Dimension drawings:

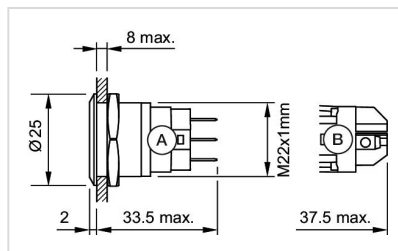

A = Solder terminal
B = Screw terminal

Mounting cut-outs:

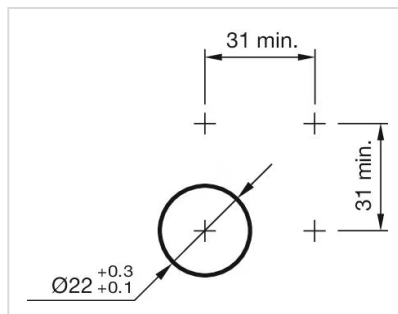

Component layouts:

