

Pushbutton Ø 19 mm silver contact

82-5172.1000



<https://eao.com/p/82-5172.1000>

Your product:



82-5172.1000

Pushbutton Ø 19 mm silver contact

FRONT

Front bezel material: Stainless steel

Front bezel shape: flush

MOUNTING

Mounting cut-out: Ø 19 mm

OPERATING-/INDICATION PART

Lens illumination: non illuminative

Lens optics: opaque

Lens colour: Silver

Lens shape: convex

Lens material: Stainless steel

ELECTRICAL CHARACTERISTICS

Rated Operational Voltage U_e: 250 VAC

Contacts: 1 C

Electric strength: 1500 VAC, 50 Hz 1 minute between life terminals and ground

Electrical lifetime: 50 000 cycles of operation

Thermal current I_{th}: 5 A

Pollution degree: 2, according to EN IEC 60947-1

Rated insulation voltage U_i: 250 V

Switching voltage and switching current:

according to IEC 60947-5-1 (Silver contacts)

Service categorie AC-15

Voltage

24 VAC

35 VAC

110 VAC

220 VAC

Switch rating DC service categorie DC-13 (Silver contacts)

Voltage

24 VDC

35 VDC

110 VDC

220 VDC

Current

1 A

1 A (M12 version)

1 A

0.5 A

Current

0.7 A

0.5 A (M12 version)

0.2 A

0.1 A

according to UL 508 (Silver contacts)

$\cos\phi$ 0,75 ... 0,8

Voltage

120 VAC

240 VAC

24 VAC

Current

5 A

3 A

1 A

MECHANICAL CHARACTERISTIC

Operating Travel:	ca. 3 mm
Contact material:	Silver
Switching action:	Momentary
Terminal:	Screw terminal
Weight:	0.019 kg
Tightening torque:	0.5 ... 0.6 Nm, Screw terminal 0.1 Nm
Mechanical lifetime:	1 Mio. cycles of operation
Switching system:	Snap-action switching element
Operating force:	4 N ... 7 N

AMBIENT CONDITION

Storage temperature:	- 40 °C ... + 80 °C
Vibration resistance:	10 ... 500 Hz, amplitude 1.5 mm p-p according to IEC 60068-2-6
Operating temperature:	- 30 °C ... + 70 °C
Climate resistance:	Damp heat, 21 days according to IEC 60512-11
Shock resistance:	Max. 500 m / s ² as per IEC 60068-2-27

CERTIFICATE

Approbations:	CB, CCC, C UL, UL
----------------------	-------------------

Conformities:

CE, 2011 / 65 / EC (RoHS), 2014 / 35 / EU (LVD)

OTHER**Short Description:**

Pushbutton Ø 19 mm silver contact, Momentary, 1 C, Screw terminal, Stainless steel, Silver

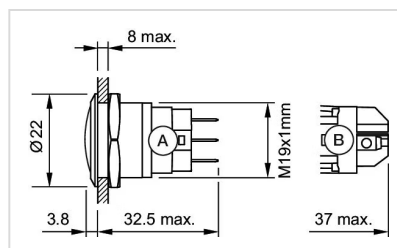
Dimension drawings:

A = Solder terminal
B = Screw terminal

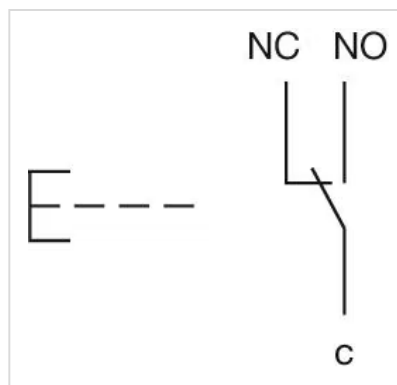
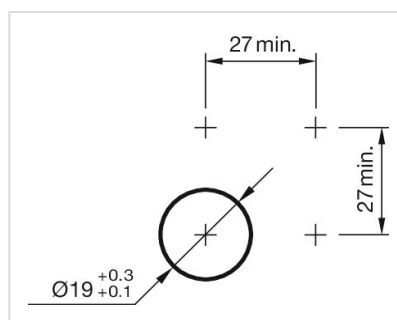
Wiring diagrams:**Mounting cut-outs:****Component layouts:**

