

Illuminated pushbutton Ø 19 mm silver contact

82-5152.2134.B002



<https://eao.com/p/82-5152.2134.B002>

Your product:



82-5152.2134.B002

Illuminated pushbutton Ø 19 mm silver contact

FRONT

Front bezel shape:	flush
Front bezel material:	Stainless steel

MOUNTING

Mounting cut-out:	Ø 19 mm
-------------------	---------

OPERATING-/INDICATION PART

Lens optics:	opaque
Lens colour:	Silver
Illumination colour:	Green
Lens material:	Stainless steel
Shape of illumination:	Ring
Lens illumination:	illuminative
Lens shape:	flush

ELECTRICAL CHARACTERISTICS

Rated Operational Voltage U _e :	250 VAC
Electrical lifetime:	50 000 cycles of operation
Rated insulation voltage U _i :	250 V
Contacts:	1 C
Thermal current I _{th} :	5 A
Pollution degree:	2, according to EN IEC 60947-1

Operating voltage:	24 V DC		
Switching voltage and switching current:	according to IEC 60947-5-1 (Silver contacts)		
	Service categorie AC-15		
	Voltage		Current
	24 VAC		1 A
	35 VAC		1 A (M12 versio
	110 VAC		1 A
	220 VAC		0.5 A
	Switch rating DC service categorie DC-13 (Silver contacts)		
	Voltage		Current
	24 VDC		0.7 A
	35 VDC		0.5 A (M12 vers
	110 VDC		0.2 A
	220 VDC		0.1 A
	according to UL 508 (Silver contacts)		
	cosφ 0,75 ... 0,8		
	Voltage		Current
	120 VAC		5 A
	240 VAC		3 A
	24 VAC		1 A

Electric strength: 1500 VAC, 50 Hz 1 minute between life terminals and ground

MECHANICAL CHARACTERISTIC

Operating force:	4 N ... 7 N
Operating Travel:	ca. 3 mm
Mechanical lifetime:	500 000 cycles of operation
Terminal:	Screw terminal
Switching system:	Snap-action switching element
Tightening torque:	0.5 ... 0.6 Nm, Screw terminal 0.1 Nm
Weight:	0.018 kg
Contact material:	Silver
Switching action:	Maintained

AMBIENT CONDITION

Storage temperature:	– 40 °C ... + 80 °C
Shock resistance:	Max. 500 m / s ² as per IEC 60068-2-27
Climate resistance:	Damp heat, 21 days according to IEC 60512-11
Operating temperature:	– 30 °C ... + 70 °C
Vibration resistance:	10 ... 500 Hz, amplitude 1.5 mm p-p according to IEC 60068-2-6

CERTIFICATE

Conformities: CE, 2011 / 65 / EC (RoHS), 2014 / 35 / EU (LVD)

Approbations: CB, CCC, C UL, UL

OTHER

Symbol: Standby

Short Description: Illuminated pushbutton Ø 19 mm silver contact, Maintained, 24 V DC, 1 C, Screw terminal, Stainless steel, Green, Standby, Silver

Kind of illumination: Single-LED

Wiring diagrams:

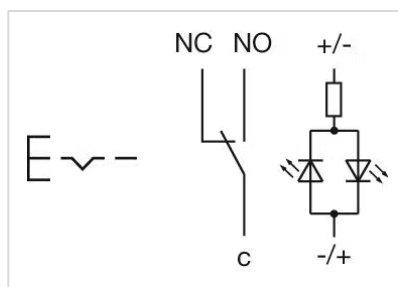

Mounting cut-outs:

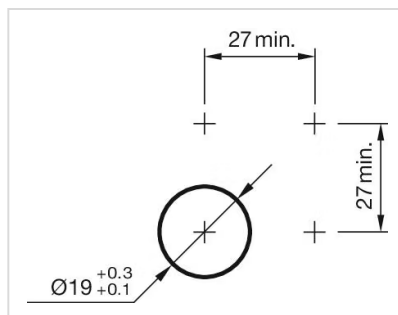

Dimension drawings:

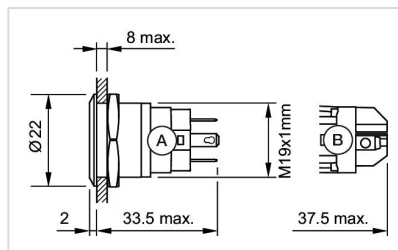

A = Solder terminal
B = Screw terminal

Component layouts:

