

Illuminated pushbutton Ø 19 mm silver contact

82-5152.2133



<https://eao.com/p/82-5152.2133>

Your product:



82-5152.2133

Illuminated pushbutton Ø
19 mm silver contact

FRONT

Front bezel shape:	flush
Front bezel material:	Stainless steel

MOUNTING

Mounting cut-out:	Ø 19 mm
-------------------	---------

OPERATING-/INDICATION PART

Lens optics:	opaque
Illumination colour:	Green
Lens material:	Stainless steel
Lens illumination:	illuminative
Shape of illumination:	Ring
Lens colour:	Silver
Lens shape:	flush

ELECTRICAL CHARACTERISTICS

Electric strength:	1500 VAC, 50 Hz 1 minute between life terminals and ground
Pollution degree:	2, according to EN IEC 60947-1
Operating voltage:	12 V AC/DC
Rated Operational Voltage Ue:	250 VAC
Switching voltage and switching current:	

according to IEC 60947-5-1 (Silver contacts)	
Service categorie AC-15	
Voltage	Current
24 VAC	1 A
35 VAC	1 A (M12 version)
110 VAC	1 A
220 VAC	0.5 A
Switch rating DC service categorie DC-13 (Silver contacts)	
Voltage	Current
24 VDC	0.7 A
35 VDC	0.5 A (M12 version)
110 VDC	0.2 A
220 VDC	0.1 A

according to UL 508 (Silver contacts)	
cosφ 0,75 ... 0,8	
Voltage	Current
120 VAC	5 A
240 VAC	3 A
24 VAC	1 A

Thermal current Ith:	5 A
Contacts:	1 C
Rated insulation voltage Ui:	250 V
Electrical lifetime:	50 000 cycles of operation

MECHANICAL CHARATERISTIC

Terminal:	Screw terminal
Switching action:	Maintained
Tightening torque:	0.5 ... 0.6 Nm, Screw terminal 0.1 Nm
Operating force:	4 N ... 7 N
Switching system:	Snap-action switching element
Contact material:	Silver
Operating Travel:	ca. 3 mm
Mechanical lifetime:	500 000 cycles of operation
Weight:	0.018 kg

AMBIENT CONDITION

Shock resistance:	Max. 500 m / s ² as per IEC 60068-2-27
Operating temperature:	– 30 °C ... + 70 °C
Climate resistance:	Damp heat, 21 days according to IEC 60512-11
Vibration resistance:	10 ... 500 Hz, amplitude 1.5 mm p-p according to IEC 60068-2-6
Storage temperature:	

– 40 °C ... + 80 °C

CERTIFICATE

Conformities:

CE, 2011 / 65 / EC (RoHS), 2014 / 35 / EU (LVD)

Approbations:

CB, CCC, C UL, UL

OTHER

Short Description:

Illuminated pushbutton Ø 19 mm silver contact, Maintained, 12 V AC/DC, 1 C, Screw terminal, Stainless steel, Green, Silver

Kind of illumination:

Single-LED

Mounting cut-outs:

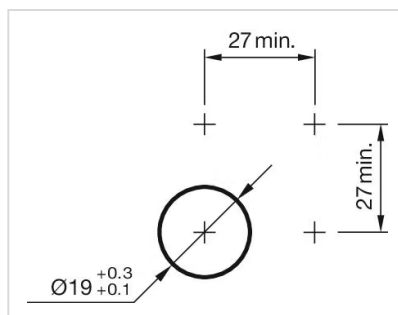

Dimension drawings:

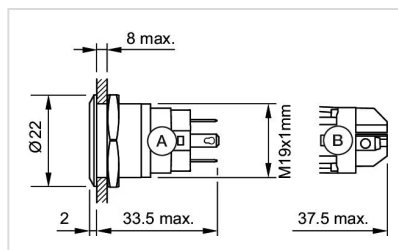

A = Solder terminal
B = Screw terminal

Component layouts:

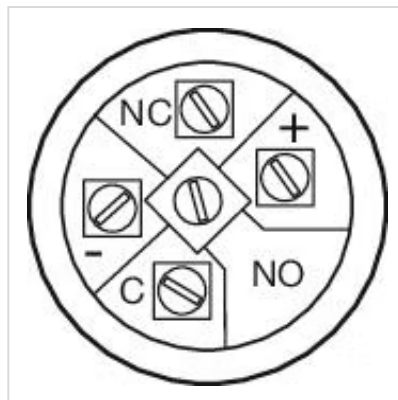

Wiring diagrams:

