

## Illuminated pushbutton Ø 19 mm silver contact

82-5152.2124.B002



<https://eao.com/p/82-5152.2124.B002>

Your product:

---



## 82-5152.2124.B002

### Illuminated pushbutton Ø 19 mm silver contact

#### FRONT

Front bezel shape:	flush
Front bezel material:	Stainless steel

#### MOUNTING

Mounting cut-out:	Ø 19 mm
-------------------	---------

#### OPERATING-/INDICATION PART

Lens shape:	flush
Lens optics:	opaque
Shape of illumination:	Ring
Lens colour:	Silver
Lens illumination:	illuminative
Illumination colour:	Blue
Lens material:	Stainless steel

#### ELECTRICAL CHARACTERISTICS

Pollution degree:	2, according to EN IEC 60947-1
Rated insulation voltage $U_i$ :	250 V
Electrical lifetime:	50 000 cycles of operation
Contacts:	1 C
Rated Operational Voltage $U_e$ :	250 VAC
Operating voltage:	24 V DC

<b>Thermal current I<sub>th</sub>:</b>	5 A		
<b>Switching voltage and switching current:</b>	according to IEC 60947-5-1 (Silver contacts) Service categorie AC-15 Voltage 24 VAC 35 VAC 110 VAC 220 VAC Switch rating DC service categorie DC-13 (Silver contacts) Voltage 24 VDC 35 VDC 110 VDC 220 VDC	Current 1 A 1 A (M12 versio 1 A 0.5 A Current 0.7 A 0.5 A (M12 vers 0.2 A 0.1 A	
	according to UL 508 (Silver contacts) cosφ 0,75 ... 0,8 Voltage 120 VAC 240 VAC 24 VAC	Current 5 A 3 A 1 A	

**Electric strength:** 1500 VAC, 50 Hz 1 minute between life terminals and ground

## MECHANICAL CHARACTERISTIC

<b>Mechanical lifetime:</b>	500 000 cycles of operation
<b>Terminal:</b>	Screw terminal
<b>Weight:</b>	0.018 kg
<b>Tightening torque:</b>	0.5 ... 0.6 Nm, Screw terminal 0.1 Nm
<b>Contact material:</b>	Silver
<b>Switching action:</b>	Maintained
<b>Operating Travel:</b>	ca. 3 mm
<b>Operating force:</b>	4 N ... 7 N
<b>Switching system:</b>	Snap-action switching element

## AMBIENT CONDITION

<b>Storage temperature:</b>	– 40 °C ... + 80 °C
<b>Vibration resistance:</b>	10 ... 500 Hz, amplitude 1.5 mm p-p according to IEC 60068-2-6
<b>Climate resistance:</b>	Damp heat, 21 days according to IEC 60512-11
<b>Shock resistance:</b>	Max. 500 m / s <sup>2</sup> as per IEC 60068-2-27
<b>Operating temperature:</b>	– 30 °C ... + 70 °C

## CERTIFICATE

**Conformities:** CE, 2011 / 65 / EC (RoHS), 2014 / 35 / EU (LVD)

**Approbations:** CB, CCC, C UL, UL

## OTHER

**Short Description:** Illuminated pushbutton Ø 19 mm silver contact, Maintained, 24 V DC, 1 C, Screw terminal, Stainless steel, Blue, Standby, Silver

**Symbol:** Standby

**Kind of illumination:** Single-LED

**Wiring diagrams:**

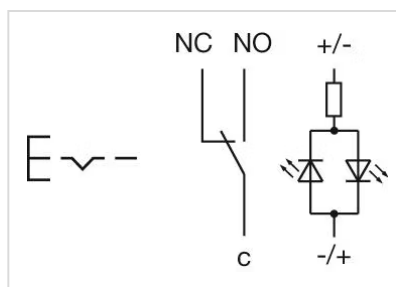

**Component layouts:**

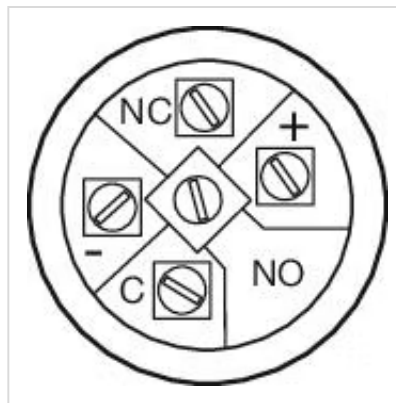

**Mounting cut-outs:**

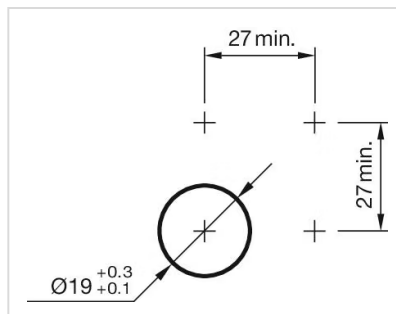

**Dimension drawings:**

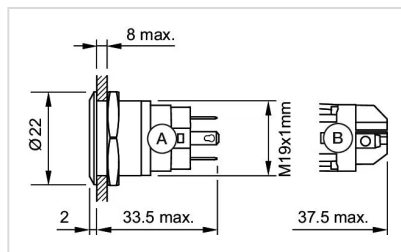

A = Solder terminal  
B = Screw terminal