

Illuminated pushbutton Ø 19 mm silver contact

82-5152.2124.B001



<https://eao.com/p/82-5152.2124.B001>

Your product:



82-5152.2124.B001

Illuminated pushbutton Ø 19 mm silver contact

FRONT

Front bezel shape:	flush
Front bezel material:	Stainless steel

MOUNTING

Mounting cut-out:	Ø 19 mm
-------------------	---------

OPERATING-/INDICATION PART

Lens material:	Stainless steel
Illumination colour:	Blue
Lens colour:	Silver
Lens illumination:	illuminative
Lens shape:	flush
Shape of illumination:	Ring
Lens optics:	opaque

ELECTRICAL CHARACTERISTICS

Operating voltage:	24 V DC
Pollution degree:	2, according to EN IEC 60947-1
Contacts:	1 C
Rated Operational Voltage U _e :	250 VAC
Electric strength:	1500 VAC, 50 Hz 1 minute between life terminals and ground
Electrical lifetime:	50 000 cycles of operation

Rated insulation voltage Ui:	250 V		
Switching voltage and switching current:	according to IEC 60947-5-1 (Silver contacts) Service categorie AC-15		
	Voltage		Current
	24 VAC		1 A
	35 VAC		1 A (M12 versio
	110 VAC		1 A
	220 VAC		0.5 A
	Switch rating DC service categorie DC-13 (Silver contacts)		
	Voltage		Current
	24 VDC		0.7 A
	35 VDC		0.5 A (M12 vers
	110 VDC		0.2 A
	220 VDC		0.1 A
	according to UL 508 (Silver contacts)		
	cosφ 0,75 ... 0,8		
	Voltage		Current
	120 VAC		5 A
	240 VAC		3 A
	24 VAC		1 A
Thermal current Ith:	5 A		

MECHANICAL CHARACTERISTIC

Switching system:	Snap-action switching element
Switching action:	Maintained
Tightening torque:	0.5 ... 0.6 Nm, Screw terminal 0.1 Nm
Terminal:	Screw terminal
Weight:	0.018 kg
Mechanical lifetime:	500 000 cycles of operation
Operating force:	4 N ... 7 N
Contact material:	Silver
Operating Travel:	ca. 3 mm

AMBIENT CONDITION

Operating temperature:	– 30 °C ... + 70 °C
Shock resistance:	Max. 500 m / s ² as per IEC 60068-2-27
Storage temperature:	– 40 °C ... + 80 °C
Vibration resistance:	10 ... 500 Hz, amplitude 1.5 mm p-p according to IEC 60068-2-6
Climate resistance:	Damp heat, 21 days according to IEC 60512-11

CERTIFICATE

Conformities: CE, 2011 / 65 / EC (RoHS), 2014 / 35 / EU (LVD)

Approbations: CB, CCC, C UL, UL

OTHER

Short Description: Illuminated pushbutton Ø 19 mm silver contact, Maintained, 24 V DC, 1 C, Screw terminal, Stainless steel, Blue, ON/OFF, Silver

Kind of illumination: Single-LED

Symbol: ON/OFF

Component layouts:

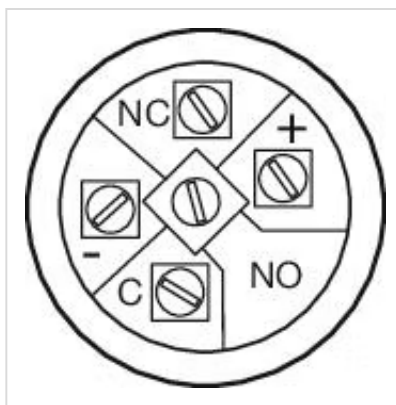

Wiring diagrams:

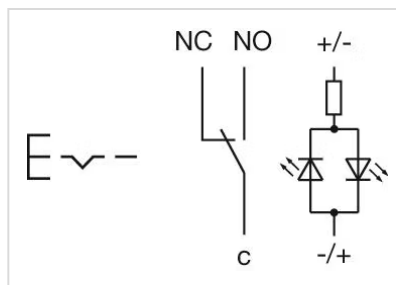

Mounting cut-outs:

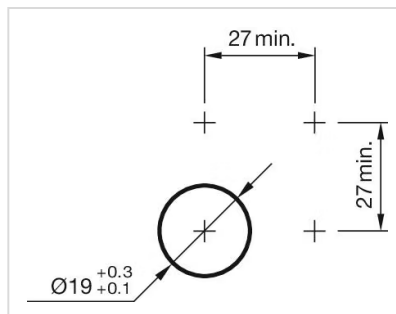

Dimension drawings:

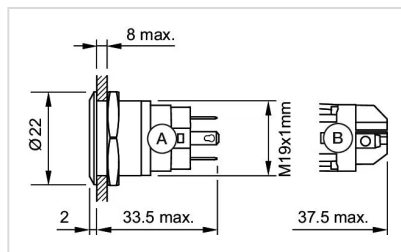

A = Solder terminal
B = Screw terminal