

Illuminated pushbutton Ø 19 mm silver contact

82-5152.2124



<https://eao.com/p/82-5152.2124>

Your product:



82-5152.2124

Illuminated pushbutton Ø
19 mm silver contact

FRONT

Front bezel shape:	flush
Front bezel material:	Stainless steel

MOUNTING

Mounting cut-out:	Ø 19 mm
-------------------	---------

OPERATING-/INDICATION PART

Lens shape:	flush
Shape of illumination:	Ring
Lens optics:	opaque
Lens illumination:	illuminative
Illumination colour:	Blue
Lens material:	Stainless steel
Lens colour:	Silver

ELECTRICAL CHARACTERISTICS

Electrical lifetime:	50 000 cycles of operation
Electric strength:	1500 VAC, 50 Hz 1 minute between life terminals and ground
Operating voltage:	24 V DC
Contacts:	1 C
Rated Operational Voltage Ue:	250 VAC
Pollution degree:	2, according to EN IEC 60947-1

Switching voltage and switching current:

according to IEC 60947-5-1 (Silver contacts)		
Service categorie AC-15		
Voltage		Current
24 VAC		1 A
35 VAC		1 A (M12 versio
110 VAC		1 A
220 VAC		0.5 A
Switch rating DC service categorie DC-13 (Silver contacts)		
Voltage		Current
24 VDC		0.7 A
35 VDC		0.5 A (M12 vers
110 VDC		0.2 A
220 VDC		0.1 A

according to UL 508 (Silver contacts)

$\cos\phi$ 0,75 ... 0,8

Voltage	Current
120 VAC	5 A
240 VAC	3 A
24 VAC	1 A

Rated insulation voltage U_i : 250 V

Thermal current I_{th} : 5 A

MECHANICAL CHARACTERISTIC

Mechanical lifetime: 500 000 cycles of operation

Weight: 0.018 kg

Operating force: 4 N ... 7 N

Switching system: Snap-action switching element

Operating Travel: ca. 3 mm

Tightening torque: 0.5 ... 0.6 Nm, Screw terminal 0.1 Nm

Switching action: Maintained

Terminal: Screw terminal

Contact material: Silver

AMBIENT CONDITION

Shock resistance: Max. 500 m / s² as per IEC 60068-2-27

Storage temperature: – 40 °C ... + 80 °C

Climate resistance: Damp heat, 21 days according to IEC 60512-11

Vibration resistance: 10 ... 500 Hz, amplitude 1.5 mm p-p according to IEC 60068-2-6

Operating temperature: – 30 °C ... + 70 °C

CERTIFICATE

Conformities: CE, 2011 / 65 / EC (RoHS), 2014 / 35 / EU (LVD)

Approbations: CB, CCC, C UL, UL

OTHER

Kind of illumination: Single-LED

Short Description: Illuminated pushbutton Ø 19 mm silver contact, Maintained, 24 V DC, 1 C, Screw terminal, Stainless steel, Blue, Silver

Component layouts:

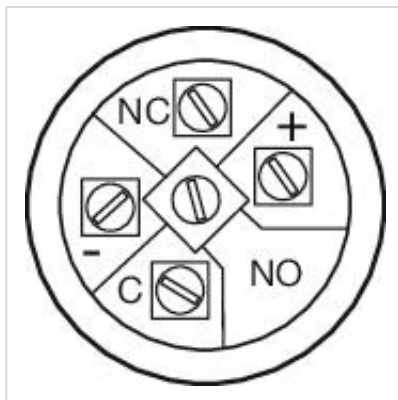

Mounting cut-outs:

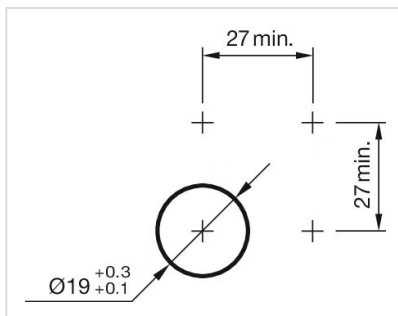

Dimension drawings:

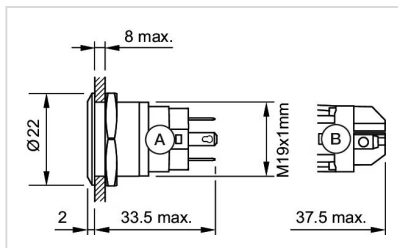

A = Solder terminal
B = Screw terminal

Wiring diagrams:

