

Illuminated pushbutton Ø 19 mm silver contact

82-5152.1113.B001



<https://eao.com/p/82-5152.1113.B001>

Your product:



82-5152.1113.B001

Illuminated pushbutton Ø
19 mm silver contact

FRONT

Front bezel shape:	flush
Front bezel material:	Stainless steel

MOUNTING

Mounting cut-out:	Ø 19 mm
-------------------	---------

OPERATING-/INDICATION PART

Lens illumination:	illuminative
Shape of illumination:	Ring
Lens colour:	Silver
Illumination colour:	Red
Lens optics:	opaque
Lens shape:	flush
Lens material:	Stainless steel

ELECTRICAL CHARACTERISTICS

Contacts:	1 C
Switching voltage and switching current:	

according to IEC 60947-5-1 (Silver contacts)	
Service categorie AC-15	
Voltage	Current
24 VAC	1 A
35 VAC	1 A (M12 version)
110 VAC	1 A
220 VAC	0.5 A
Switch rating DC service categorie DC-13 (Silver contacts)	
Voltage	Current
24 VDC	0.7 A
35 VDC	0.5 A (M12 version)
110 VDC	0.2 A
220 VDC	0.1 A

according to UL 508 (Silver contacts)	
cosφ 0,75 ... 0,8	
Voltage	Current
120 VAC	5 A
240 VAC	3 A
24 VAC	1 A

Rated Operational Voltage Ue:	250 VAC
Pollution degree:	2, according to EN IEC 60947-1
Thermal current Ith:	5 A
Electrical lifetime:	50 000 cycles of operation
Operating voltage:	12 V AC/DC
Electric strength:	1500 VAC, 50 Hz 1 minute between life terminals and ground
Rated insulation voltage Ui:	250 V

MECHANICAL CHARATERISTIC

Weight:	0.018 kg
Terminal:	Screw terminal
Operating force:	4 N ... 7 N
Mechanical lifetime:	1 Mio. cycles of operation
Tightening torque:	0.5 ... 0.6 Nm, Screw terminal 0.1 Nm
Contact material:	Silver
Switching action:	Momentary
Operating Travel:	ca. 3 mm
Switching system:	Snap-action switching element

AMBIENT CONDITION

Operating temperature:	– 30 °C ... + 70 °C
Climate resistance:	

Damp heat, 21 days according to IEC 60512-11

Storage temperature: - 40 °C ... + 80 °C

Vibration resistance: 10 ... 500 Hz, amplitude 1.5 mm p-p according to IEC 60068-2-6

Shock resistance: Max. 500 m / s² as per IEC 60068-2-27

CERTIFICATE

Approbations: CB, CCC, C UL, UL

Conformities: CE, 2011 / 65 / EC (RoHS), 2014 / 35 / EU (LVD)

OTHER

Short Description: Illuminated pushbutton Ø 19 mm silver contact, Momentary, 12 V AC/DC, 1 C, Screw terminal, Stainless steel, Red, ON/OFF, Silver

Symbol: ON/OFF

Kind of illumination: Single-LED

Mounting cut-outs:

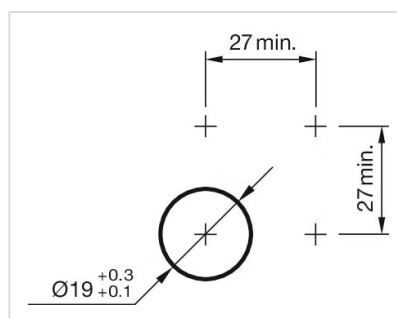

Wiring diagrams:

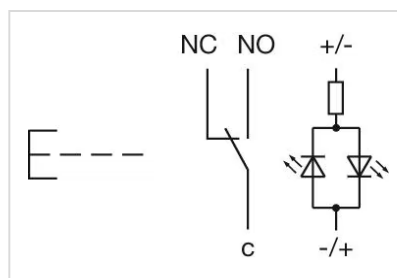

Dimension drawings:

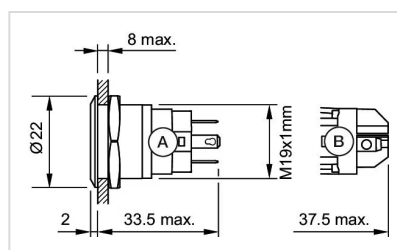

A = Solder terminal
B = Screw terminal

Component layouts:

