

Illuminated pushbutton Ø 19 mm silver contact

82-5152.1113



<https://eao.com/p/82-5152.1113>

Your product:



82-5152.1113

Illuminated pushbutton Ø
19 mm silver contact

FRONT

Front bezel material: Stainless steel

Front bezel shape: flush

MOUNTING

Mounting cut-out: Ø 19 mm

OPERATING-/INDICATION PART

Lens colour: Silver

Shape of illumination: Ring

Lens optics: opaque

Lens material: Stainless steel

Illumination colour: Red

Lens shape: flush

Lens illumination: illuminative

ELECTRICAL CHARACTERISTICS

Rated Operational Voltage U_e: 250 VAC

Rated insulation voltage U_i: 250 V

Electric strength: 1500 VAC, 50 Hz 1 minute between life terminals and ground

Operating voltage: 12 V AC/DC

Contacts: 1 C

Pollution degree: 2, according to EN IEC 60947-1

Switching voltage and switching current:

according to IEC 60947-5-1 (Silver contacts)		
Service categorie AC-15		
Voltage		Current
24 VAC		1 A
35 VAC		1 A (M12 versio
110 VAC		1 A
220 VAC		0.5 A
Switch rating DC service categorie DC-13 (Silver contacts)		
Voltage		Current
24 VDC		0.7 A
35 VDC		0.5 A (M12 vers
110 VDC		0.2 A
220 VDC		0.1 A

according to UL 508 (Silver contacts)

$\cos\phi$ 0,75 ... 0,8	
Voltage	Current
120 VAC	5 A
240 VAC	3 A
24 VAC	1 A

Thermal current I_{th}: 5 A

Electrical lifetime: 50 000 cycles of operation

MECHANICAL CHARACTERISTIC

Weight: 0.018 kg

Operating force: 4 N ... 7 N

Mechanical lifetime: 1 Mio. cycles of operation

Switching system: Snap-action switching element

Contact material: Silver

Switching action: Momentary

Operating Travel: ca. 3 mm

Tightening torque: 0.5 ... 0.6 Nm

Terminal: Screw terminal

AMBIENT CONDITION

Shock resistance: Max. 500 m / s² as per IEC 60068-2-27

Vibration resistance: 10 ... 500 Hz, amplitude 1.5 mm p-p according to IEC 60068-2-6

Operating temperature: – 30 °C ... + 70 °C

Climate resistance: Damp heat, 21 days according to IEC 60512-11

Storage temperature: – 40 °C ... + 80 °C

CERTIFICATE

Approbations: CB, CCC, C UL, UL

Conformities: CE, 2011 / 65 / EC (RoHS), 2014 / 35 / EU (LVD)

OTHER

Kind of illumination: Single-LED

Short Description: Illuminated pushbutton Ø 19 mm silver contact, Momentary, 12 V AC/DC, 1 C, Screw terminal, Stainless steel, Red, Silver

Component layouts:

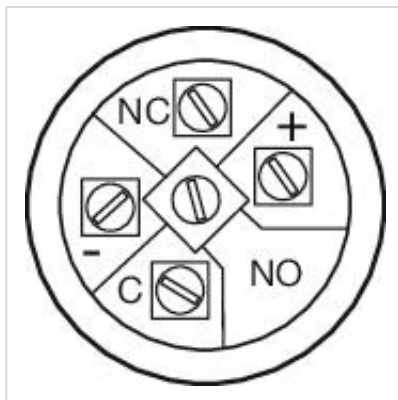

Wiring diagrams:

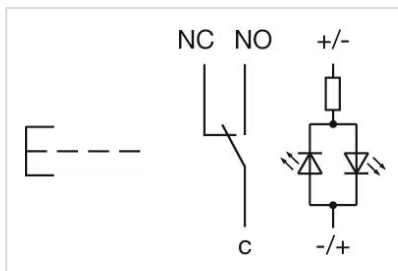

Dimension drawings:

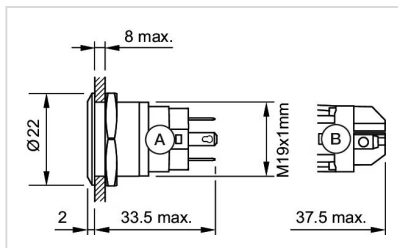

A = Solder terminal
B = Screw terminal

Mounting cut-outs:

