

Illuminated pushbutton Ø 19 mm silver contact

82-5151.2113.B001



<https://eao.com/p/82-5151.2113.B001>

Your product:



82-5151.2113.B001 Illuminated pushbutton Ø 19 mm silver contact

FRONT

Front bezel material: Stainless steel

Front bezel shape: flush

MOUNTING

Mounting cut-out: Ø 19 mm

OPERATING-/INDICATION PART

Lens colour: Silver

Shape of illumination: Ring

Illumination colour: Red

Lens optics: opaque

Lens illumination: illuminative

Lens material: Stainless steel

Lens shape: flush

ELECTRICAL CHARACTERISTICS

Switching voltage and switching current:

according to IEC 60947-5-1 (Silver contacts)

Service categorie AC-15

Voltage

24 VAC

35 VAC

110 VAC

220 VAC

Switch rating DC service categorie DC-13 (Silver contacts)

Voltage

24 VDC

35 VDC

110 VDC

220 VDC

Current

1 A

1 A (M12 versio

1 A

0.5 A

Current

0.7 A

0.5 A (M12 vers

0.2 A

0.1 A

according to UL 508 (Silver contacts)

cosφ 0,75 ... 0,8

Voltage

120 VAC

240 VAC

24 VAC

Current

5 A

3 A

1 A

Electrical lifetime:	50 000 cycles of operation
Contacts:	1 C
Rated insulation voltage Ui:	250 V
Pollution degree:	2, according to EN IEC 60947-1
Thermal current Ith:	5 A
Operating voltage:	12 V AC/DC
Electric strength:	1500 VAC, 50 Hz 1 minute between life terminals and ground
Rated Operational Voltage Ue:	250 VAC

MECHANICAL CHARACTERISTIC

Weight:	0.018 kg
Switching system:	Snap-action switching element
Terminal:	Soldering terminal, 2.8 x 0.5 mm
Operating force:	4 N ... 7 N
Mechanical lifetime:	500 000 cycles of operation
Contact material:	Silver
Tightening torque:	0.5 ... 0.6 Nm
Operating Travel:	ca. 3 mm
Switching action:	Maintained

AMBIENT CONDITION

Operating temperature:	- 30 °C ... + 70 °C
Shock resistance:	Max. 500 m / s ² as per IEC 60068-2-27
Vibration resistance:	10 ... 500 Hz, amplitude 1.5 mm p-p according to IEC 60068-2-6
Storage temperature:	- 40 °C ... + 80 °C
Climate resistance:	Damp heat, 21 days according to IEC 60512-11

CERTIFICATE

Approbations: CB, CCC, C UL, UL

Conformities: CE, 2011 / 65 / EC (RoHS), 2014 / 35 / EU (LVD)

OTHER

Short Description: Illuminated pushbutton Ø 19 mm silver contact, Maintained, 12 V AC/DC, 1 C, Soldering terminal, 2.8 x 0.5 mm, Stainless steel, Red, ON/OFF, Silver

Symbol: ON/OFF

Kind of illumination: Single-LED

Mounting cut-outs:

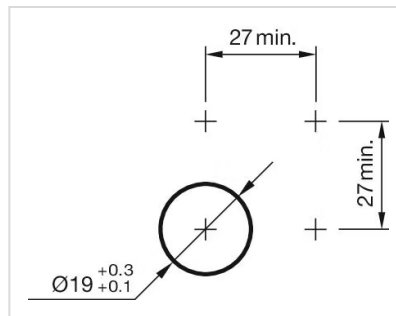

Component layouts:

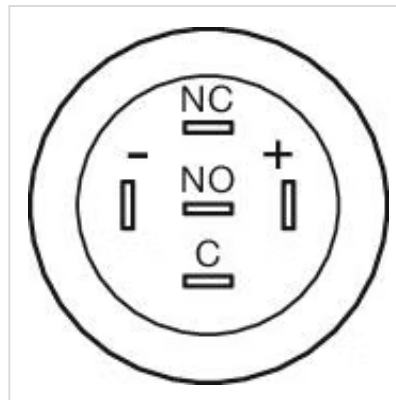

Wiring diagrams:

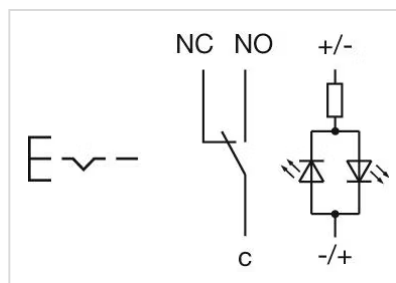

Dimension drawings:

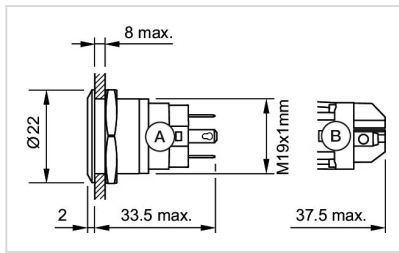

A = Solder terminal
B = Screw terminal