

Illuminated pushbutton Ø 19 mm silver contact

82-5151.1113.B001



<https://eao.com/p/82-5151.1113.B001>

Your product:



82-5151.1113.B001
Illuminated pushbutton Ø
19 mm silver contact

FRONT

Front bezel material:	Stainless steel
Front bezel shape:	flush

MOUNTING

Mounting cut-out:	Ø 19 mm
-------------------	---------

OPERATING-/INDICATION PART

Lens optics:	opaque
Lens shape:	flush
Lens illumination:	illuminative
Lens material:	Stainless steel
Lens colour:	Silver
Illumination colour:	Red
Shape of illumination:	Ring

ELECTRICAL CHARACTERISTICS

Switching voltage and switching current:	according to IEC 60947-5-1 (Silver contacts)	
	Service categorie AC-15	
	Voltage	Current
	24 VAC	1 A
	35 VAC	1 A (M12 versio
	110 VAC	1 A
	220 VAC	0.5 A
	Switch rating DC service categorie DC-13 (Silver contacts)	
	Voltage	Current
	24 VDC	0.7 A
	35 VDC	0.5 A (M12 vers
	110 VDC	0.2 A
	220 VDC	0.1 A

according to UL 508 (Silver contacts)

$\cos\phi$ 0,75 ... 0,8

Voltage

120 VAC

240 VAC

24 VAC

Current

5 A

3 A

1 A

Electric strength:	1500 VAC, 50 Hz 1 minute between life terminals and ground
Thermal current I_{th}:	5 A
Rated Operational Voltage U_e:	250 VAC
Rated insulation voltage U_i:	250 V
Pollution degree:	2, according to EN IEC 60947-1
Electrical lifetime:	50 000 cycles of operation
Contacts:	1 C
Operating voltage:	12 V AC/DC

MECHANICAL CHARACTERISTIC

Weight:	0.018 kg
Contact material:	Silver
Operating force:	4 N ... 7 N
Terminal:	Soldering terminal, 2.8 x 0.5 mm
Switching system:	Snap-action switching element
Operating Travel:	ca. 3 mm
Switching action:	Momentary
Mechanical lifetime:	1 Mio. cycles of operation
Tightening torque:	0.5 ... 0.6 Nm

AMBIENT CONDITION

Operating temperature:	– 30 °C ... + 70 °C
Shock resistance:	Max. 500 m / s ² as per IEC 60068-2-27
Vibration resistance:	10 ... 500 Hz, amplitude 1.5 mm p-p according to IEC 60068-2-6
Climate resistance:	Damp heat, 21 days according to IEC 60512-11
Storage temperature:	– 40 °C ... + 80 °C

CERTIFICATE

Conformities: CE, 2011 / 65 / EC (RoHS), 2014 / 35 / EU (LVD)

Approbations: CB, CCC, C UL, UL

OTHER

Symbol: ON/OFF

Short Description: Illuminated pushbutton Ø 19 mm silver contact, Momentary, 12 V AC/DC, 1 C, Soldering terminal, 2.8 x 0.5 mm, Stainless steel, Red, ON/OFF, Silver

Kind of illumination: Single-LED

Component layouts:

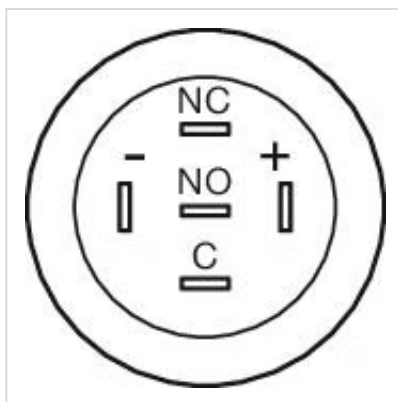

Mounting cut-outs:

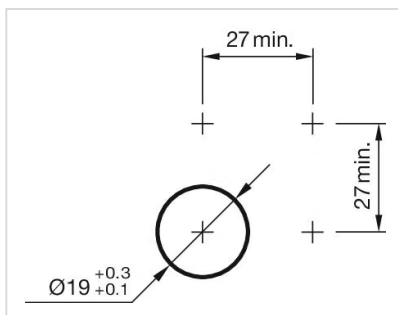

Wiring diagrams:

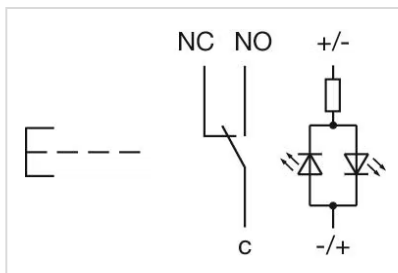

Dimension drawings:

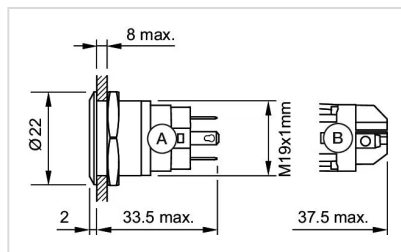

A = Solder terminal
B = Screw terminal