

Pushbutton Ø 16 mm silver contact

82-4552.2000



<https://eao.com/p/82-4552.2000>

Your product:



82-4552.2000

Pushbutton Ø 16 mm silver contact

FRONT

Front bezel shape:	flush
Front bezel material:	Aluminium

MOUNTING

Mounting cut-out:	Ø 16 mm
-------------------	---------

OPERATING-/INDICATION PART

Lens material:	Aluminium
Lens colour:	Nature
Lens optics:	opaque
Lens shape:	flush
Lens illumination:	non illuminative

ELECTRICAL CHARACTERISTICS

Contacts:	1 C
Pollution degree:	2, according to EN IEC 60947-1
Rated Operational Voltage U _e :	250 VAC
Switching voltage and switching current:	

according to IEC 60947-5-1 (Silver contacts)

Service categorie AC-15

Voltage

24 VAC

35 VAC

110 VAC

220 VAC

Current

1 A

1 A (M12 version)

1 A

0.5 A

Switch rating DC service categorie DC-13 (Silver contacts)

Voltage

24 VDC

35 VDC

110 VDC

220 VDC

Current

0.7 A

0.5 A (M12 version)

0.2 A

0.1 A

according to UL 508 (Silver contacts)

$\cos\phi$ 0,75 ... 0,8

Voltage

120 VAC

240 VAC

24 VAC

Current

5 A

3 A

1 A

Rated insulation voltage U_i:	250 V
Thermal current I_{th}:	5 A
Electrical lifetime:	50 000 cycles of operation
Electric strength:	1500 VAC, 50 Hz 1 minute between life terminals and ground

MECHANICAL CHARACTERISTIC

Terminal:	Screw terminal
Switching action:	Maintained
Operating force:	4 N ... 7 N
Operating Travel:	ca. 3 mm
Mechanical lifetime:	500 000 cycles of operation
Tightening torque:	0.5 ... 0.6 Nm, Screw terminal 0.1 Nm
Contact material:	Silver
Switching system:	Snap-action switching element
Weight:	0.018 kg

AMBIENT CONDITION

Vibration resistance:	10 ... 500 Hz, amplitude 1.5 mm p-p according to IEC 60068-2-6
Storage temperature:	- 40 °C ... + 80 °C
Climate resistance:	Damp heat, 21 days according to IEC 60512-11
Operating temperature:	- 30 °C ... + 70 °C
Shock resistance:	

Max. 500 m / s² as per IEC 60068-2-27

CERTIFICATE

Approbations: CB, CCC, C UL, UL

Conformities: CE, 2011 / 65 / EC (RoHS), 2014 / 35 / EU (LVD)

OTHER

Short Description: Pushbutton Ø 16 mm silver contact, Maintained, 1 C, Screw terminal, Aluminium, Nature

Component layouts:

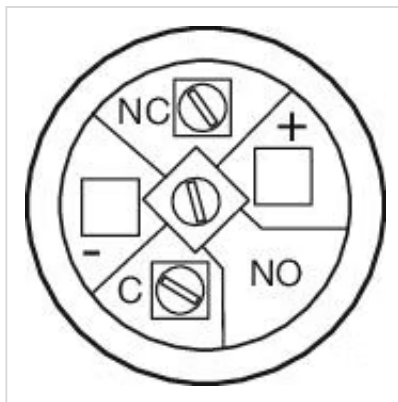

Mounting cut-outs:

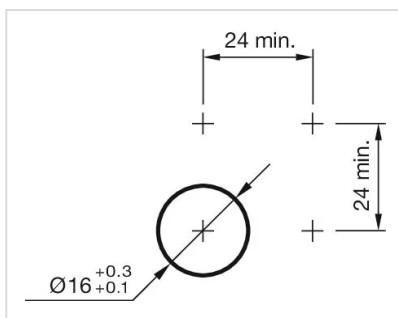

Wiring diagrams:

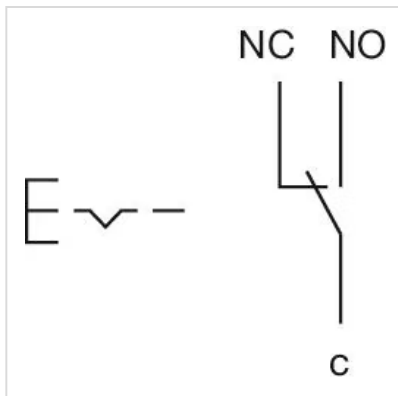

Dimension drawings:

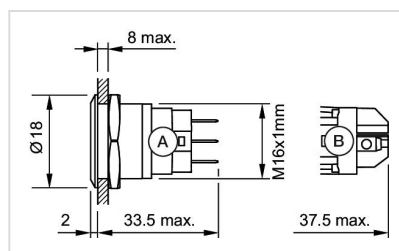

A = Solder terminal

B = Screw terminal