

Pushbutton Ø 16 mm silver contact

82-4551.2000



<https://eao.com/p/82-4551.2000>

Your product:



82-4551.2000

Pushbutton Ø 16 mm silver contact

FRONT

Front bezel material: Aluminium

MOUNTING

Mounting cut-out: Ø 16 mm

OPERATING-/INDICATION PART

Lens shape: flush

Lens colour: Nature

Lens optics: opaque

Lens illumination: non illuminative

Lens material: Aluminium

ELECTRICAL CHARACTERISTICS

Pollution degree: 2, according to EN IEC 60947-1

Rated insulation voltage U_i : 250 V

Contacts: 1 C

Electric strength: 1500 VAC, 50 Hz 1 minute between life terminals and ground

Electrical lifetime: 50 000 cycles of operation

Rated Operational Voltage U_e : 250 VAC

Thermal current I_{th} : 5 A

Switching voltage and switching current:

according to IEC 60947-5-1 (Silver contacts)	
Service categorie AC-15	
Voltage	Current
24 VAC	1 A
35 VAC	1 A (M12 version)
110 VAC	1 A
220 VAC	0.5 A
Switch rating DC service categorie DC-13 (Silver contacts)	
Voltage	Current
24 VDC	0.7 A
35 VDC	0.5 A (M12 version)
110 VDC	0.2 A
220 VDC	0.1 A

according to UL 508 (Silver contacts)	
cosφ 0,75 ... 0,8	
Voltage	Current
120 VAC	5 A
240 VAC	3 A
24 VAC	1 A

MECHANICAL CHARACTERISTIC

Switching action:	Maintained
Terminal:	Soldering terminal, 2.8 x 0.5 mm
Contact material:	Silver
Mechanical lifetime:	500 000 cycles of operation
Weight:	0.018 kg
Operating Travel:	ca. 3 mm
Switching system:	Snap-action switching element
Tightening torque:	0.5 ... 0.6 Nm
Operating force:	4 N ... 7 N

AMBIENT CONDITION

Shock resistance:	Max. 500 m / s ² as per IEC 60068-2-27
Climate resistance:	Damp heat, 21 days according to IEC 60512-11
Operating temperature:	– 30 °C ... + 70 °C
Vibration resistance:	10 ... 500 Hz, amplitude 1.5 mm p-p according to IEC 60068-2-6
Storage temperature:	– 40 °C ... + 80 °C

CERTIFICATE

Conformities:	CE, 2011 / 65 / EC (RoHS), 2014 / 35 / EU (LVD)
----------------------	---

Approbations:

CB, CCC, C UL, UL

OTHER**Short Description:**

Pushbutton Ø 16 mm silver contact, Maintained, 1 C, Soldering terminal, 2.8 x 0.5 mm, Aluminium, Nature

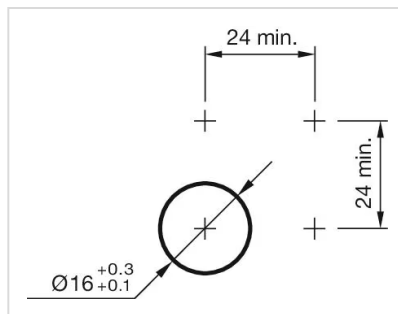
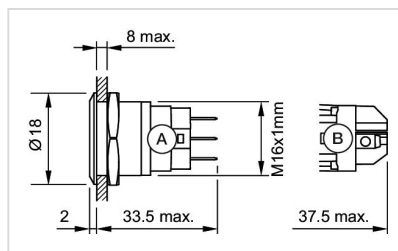
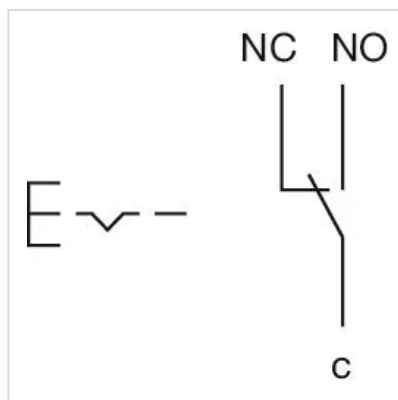
Mounting cut-outs:**Dimension drawings:****Wiring diagrams:****Component layouts:**

