

Pushbutton Ø 16 mm silver contact

82-4162.2000.B002



<https://eao.com/p/82-4162.2000.B002>

Your product:



82-4162.2000.B002

Pushbutton Ø 16 mm silver contact

FRONT

Front bezel material: Stainless steel

Front bezel shape: flush

MOUNTING

Mounting cut-out: Ø 16 mm

OPERATING-/INDICATION PART

Lens illumination: non illuminative

Lens optics: opaque

Lens material: Stainless steel

Lens shape: raised

Lens colour: Silver

ELECTRICAL CHARACTERISTICS

Thermal current I_{th}: 5 A

Rated Operational Voltage U_e: 250 VAC

Contacts: 1 C

Switching voltage and switching current:

according to IEC 60947-5-1 (Silver contacts)	
Service categorie AC-15	
Voltage	Current
24 VAC	1 A
35 VAC	1 A (M12 version)
110 VAC	1 A
220 VAC	0.5 A
Switch rating DC service categorie DC-13 (Silver contacts)	
Voltage	Current
24 VDC	0.7 A
35 VDC	0.5 A (M12 version)
110 VDC	0.2 A
220 VDC	0.1 A

according to UL 508 (Silver contacts)	
cosφ 0,75 ... 0,8	
Voltage	Current
120 VAC	5 A
240 VAC	3 A
24 VAC	1 A

Electrical lifetime:	50 000 cycles of operation
Pollution degree:	2, according to EN IEC 60947-1
Electric strength:	1500 VAC, 50 Hz 1 minute between life terminals and ground
Rated insulation voltage Ui:	250 V

MECHANICAL CHARACTERISTIC

Tightening torque:	0.5 ... 0.6 Nm, Screw terminal 0.1 Nm
Weight:	0.02 kg
Contact material:	Silver
Switching action:	Maintained
Operating Travel:	ca. 3 mm
Mechanical lifetime:	500 000 cycles of operation
Terminal:	Screw terminal
Operating force:	4 N ... 7 N
Switching system:	Snap-action switching element

AMBIENT CONDITION

Storage temperature:	– 40 °C ... + 80 °C
Operating temperature:	– 30 °C ... + 70 °C
Vibration resistance:	10 ... 500 Hz, amplitude 1.5 mm p-p according to IEC 60068-2-6
Climate resistance:	Damp heat, 21 days according to IEC 60512-11
Shock resistance:	

Max. 500 m / s² as per IEC 60068-2-27

CERTIFICATE

Approbations: CB, CCC, C UL, UL

Conformities: CE, 2011 / 65 / EC (RoHS), 2014 / 35 / EU (LVD)

OTHER

Symbol: Standby

Short Description: Pushbutton Ø 16 mm silver contact, Maintained, 1 C, Screw terminal, Stainless steel, Standby, Silver

Component layouts:

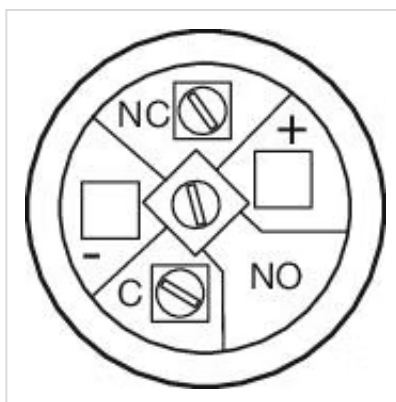

Dimension drawings:

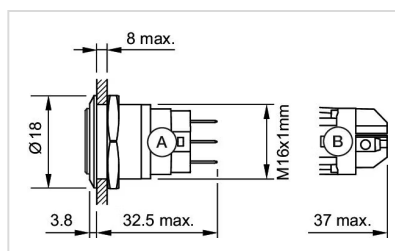

A = Solder terminal
B = Screw terminal

Mounting cut-outs:

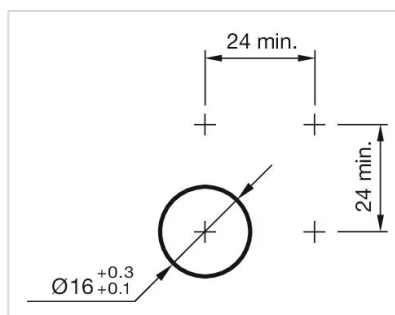

Wiring diagrams:

