

## Pushbutton Ø 16 mm silver contact

82-4161.1000.B002



<https://eao.com/p/82-4161.1000.B002>

Your product:



82-4161.1000.B002  
Pushbutton Ø 16 mm silver contact

FRONT

Front bezel shape:	flush
Front bezel material:	Stainless steel

MOUNTING

Mounting cut-out:	Ø 16 mm
-------------------	---------

OPERATING-/INDICATION PART

Lens illumination:	non illuminative
Lens colour:	Silver
Lens material:	Stainless steel
Lens shape:	raised
Lens optics:	opaque

ELECTRICAL CHARACTERISTICS

<b>Rated Operational Voltage U<sub>e</sub>:</b>	250 VAC		
<b>Switching voltage and switching current:</b>	according to IEC 60947-5-1 (Silver contacts)		
	Service categorie AC-15		
	Voltage	Current	
	24 VAC	1 A	
	35 VAC	1 A (M12 versio	
	110 VAC	1 A	
	220 VAC	0.5 A	
	Switch rating DC service categorie DC-13 (Silver contacts)		
	Voltage	Current	
	24 VDC	0.7 A	
	35 VDC	0.5 A (M12 vers	
	110 VDC	0.2 A	
	220 VDC	0.1 A	

according to UL 508 (Silver contacts)

$\cos\phi$  0,75 ... 0,8

Voltage

120 VAC

240 VAC

24 VAC

Current

5 A

3 A

1 A

<b>Contacts:</b>	1 C
<b>Electrical lifetime:</b>	50 000 cycles of operation
<b>Thermal current I<sub>th</sub>:</b>	5 A
<b>Rated insulation voltage U<sub>i</sub>:</b>	250 V
<b>Electric strength:</b>	1500 VAC, 50 Hz 1 minute between life terminals and ground
<b>Pollution degree:</b>	2, according to EN IEC 60947-1

## MECHANICAL CHARACTERISTIC

<b>Contact material:</b>	Silver
<b>Weight:</b>	0.02 kg
<b>Terminal:</b>	Soldering terminal, 2.8 x 0.5 mm
<b>Mechanical lifetime:</b>	1 Mio. cycles of operation
<b>Switching action:</b>	Momentary
<b>Switching system:</b>	Snap-action switching element
<b>Operating force:</b>	4 N ... 7 N
<b>Tightening torque:</b>	0.5 ... 0.6 Nm
<b>Operating Travel:</b>	ca. 3 mm

## AMBIENT CONDITION

<b>Shock resistance:</b>	Max. 500 m / s <sup>2</sup> as per IEC 60068-2-27
<b>Storage temperature:</b>	- 40 °C ... + 80 °C
<b>Climate resistance:</b>	Damp heat, 21 days according to IEC 60512-11
<b>Vibration resistance:</b>	10 ... 500 Hz, amplitude 1.5 mm p-p according to IEC 60068-2-6
<b>Operating temperature:</b>	- 30 °C ... + 70 °C

## CERTIFICATE

<b>Approbations:</b>	CB, CCC, C UL, UL
<b>Conformities:</b>	CE, 2011 / 65 / EC (RoHS), 2014 / 35 / EU (LVD)

## OTHER

### Short Description:

Pushbutton Ø 16 mm silver contact, Momentary, 1 C, Soldering terminal, 2.8 x 0.5 mm, Stainless steel, Standby, Silver

### Symbol:

Standby

### Dimension drawings:

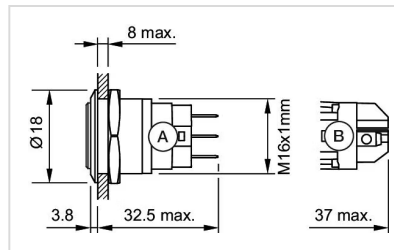

A = Solder terminal

B = Screw terminal

### Wiring diagrams:

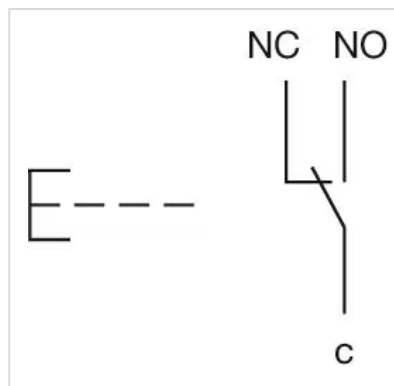

### Mounting cut-outs:

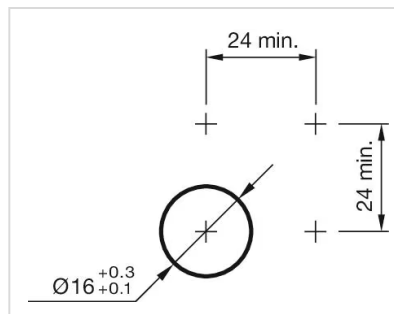

### Component layouts:

