

Illuminated pushbutton Ø 16 mm silver contact

82-4152.21A4



<https://eao.com/p/82-4152.21A4>

Your product:



82-4152.21A4

Illuminated pushbutton Ø 16 mm silver contact

FRONT

Front bezel material: Stainless steel

Front bezel shape: flush

MOUNTING

Mounting cut-out: Ø 16 mm

OPERATING-/INDICATION PART

Illumination colour: Red / Green

Lens colour: Silver

Lens material: Stainless steel

Lens illumination: illuminative

Lens optics: opaque

Shape of illumination: Ring

Lens shape: flush

ELECTRICAL CHARACTERISTICS

Thermal current I_{th}: 5 A

Pollution degree: 2, according to EN IEC 60947-1

Switching voltage and switching current:

according to IEC 60947-5-1 (Silver contacts)

Service categorie AC-15

Voltage

24 VAC

35 VAC

110 VAC

220 VAC

Current

1 A

1 A (M12 version)

1 A

0.5 A

Switch rating DC service categorie DC-13 (Silver contacts)

Voltage

24 VDC

35 VDC

110 VDC

220 VDC

Current

0.7 A

0.5 A (M12 version)

0.2 A

0.1 A

according to UL 508 (Silver contacts)

$\cos\phi$ 0,75 ... 0,8

Voltage

120 VAC

240 VAC

24 VAC

Current

5 A

3 A

1 A

Electrical lifetime:	50 000 cycles of operation
Operating voltage:	24 V AC/DC
Rated Operational Voltage U_e:	250 VAC
Electric strength:	1500 VAC, 50 Hz 1 minute between life terminals and ground
Rated insulation voltage U_i:	250 V
Contacts:	1 C

MECHANICAL CHARACTERISTIC

Terminal:	Screw terminal
Contact material:	Silver
Operating force:	4 N ... 7 N
Operating Travel:	ca. 3 mm
Switching action:	Maintained
Switching system:	Snap-action switching element
Mechanical lifetime:	500 000 cycles of operation
Weight:	0.018 kg
Tightening torque:	0.5 ... 0.6 Nm, Screw terminal 0.1 Nm

AMBIENT CONDITION

Shock resistance:	Max. 500 m / s ² as per IEC 60068-2-27
Storage temperature:	- 40 °C ... + 80 °C
Climate resistance:	

Damp heat, 21 days according to IEC 60512-11

Vibration resistance: 10 ... 500 Hz, amplitude 1.5 mm p-p according to IEC 60068-2-6

Operating temperature: - 30 °C ... + 70 °C

CERTIFICATE

Conformities: CE, 2011 / 65 / EC (RoHS), 2014 / 35 / EU (LVD)

Approbations: CB, CCC, C UL, UL

OTHER

Short Description: Illuminated pushbutton Ø 16 mm silver contact, Maintained, 24 V AC/DC, 1 C, Screw terminal, Stainless steel, Red / Green, Silver

Kind of illumination: Bi-colour-LED

Component layouts:

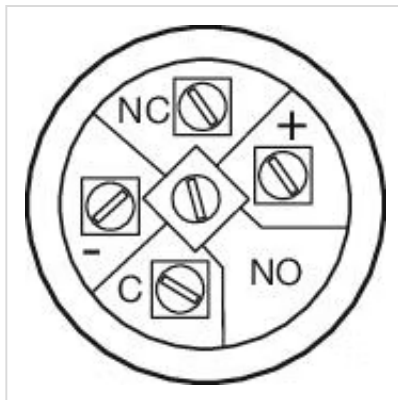

Dimension drawings:

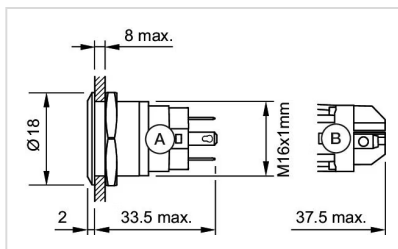

A = Solder terminal
B = Screw terminal

Mounting cut-outs:

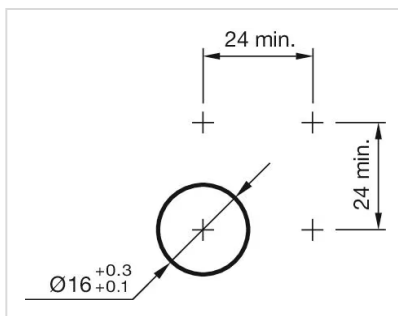

Wiring diagrams:

