

Illuminated pushbutton Ø 16 mm silver contact

82-4152.2134



<https://eao.com/p/82-4152.2134>

Your product:



82-4152.2134
Illuminated pushbutton Ø
16 mm silver contact

FRONT

Front bezel material: Stainless steel

Front bezel shape: flush

MOUNTING

Mounting cut-out: Ø 16 mm

OPERATING-/INDICATION PART

Lens colour: Silver

Lens shape: flush

Lens material: Stainless steel

Lens illumination: illuminative

Shape of illumination: Ring

Illumination colour: Green

Lens optics: opaque

ELECTRICAL CHARACTERISTICS

Rated Operational Voltage U_e: 250 VAC

Switching voltage and switching current:

according to IEC 60947-5-1 (Silver contacts)

Service categorie AC-15

Voltage

24 VAC

35 VAC

110 VAC

220 VAC

Current

1 A

1 A (M12 version)

1 A

0.5 A

Switch rating DC service categorie DC-13 (Silver contacts)

Voltage

24 VDC

35 VDC

110 VDC

220 VDC

Current

0.7 A

0.5 A (M12 version)

0.2 A

0.1 A

according to UL 508 (Silver contacts)

cos ϕ 0,75 ... 0,8

Voltage

120 VAC

240 VAC

24 VAC

Current

5 A

3 A

1 A

Electric strength:	1500 VAC, 50 Hz 1 minute between life terminals and ground
Electrical lifetime:	50 000 cycles of operation
Thermal current I_{th}:	5 A
Operating voltage:	24 V AC/DC
Contacts:	1 C
Pollution degree:	2, according to EN IEC 60947-1
Rated insulation voltage U_i:	250 V

MECHANICAL CHARACTERISTIC

Operating Travel:	ca. 3 mm
Terminal:	Screw terminal
Switching action:	Maintained
Switching system:	Snap-action switching element
Contact material:	Silver
Tightening torque:	0.5 ... 0.6 Nm, Screw terminal 0.1 Nm
Operating force:	4 N ... 7 N
Weight:	0.018 kg
Mechanical lifetime:	500 000 cycles of operation

AMBIENT CONDITION

Operating temperature:	- 30 °C ... + 70 °C
Storage temperature:	

- 40 °C ... + 80 °C

Vibration resistance: 10 ... 500 Hz, amplitude 1.5 mm p-p according to IEC 60068-2-6

Climate resistance: Damp heat, 21 days according to IEC 60512-11

Shock resistance: Max. 500 m / s² as per IEC 60068-2-27

CERTIFICATE

Approbations: CB, CCC, C UL, UL

Conformities: CE, 2011 / 65 / EC (RoHS), 2014 / 35 / EU (LVD)

OTHER

Kind of illumination: Single-LED

Short Description: Illuminated pushbutton Ø 16 mm silver contact, Maintained, 24 V AC/DC, 1 C, Screw terminal, Stainless steel, Green, Silver

Wiring diagrams:

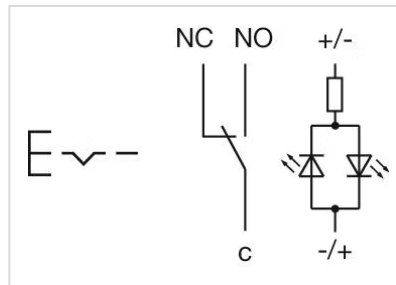

Dimension drawings:

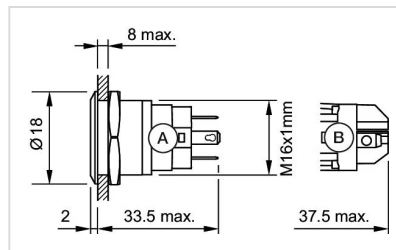

A = Solder terminal
B = Screw terminal

Component layouts:



Mounting cut-outs:

