

Illuminated pushbutton Ø 16 mm silver contact

82-4152.1133



<https://eao.com/p/82-4152.1133>

Your product:



82-4152.1133

Illuminated pushbutton Ø
16 mm silver contact

FRONT

Front bezel material: Stainless steel

Front bezel shape: flush

MOUNTING

Mounting cut-out: Ø 16 mm

OPERATING-/INDICATION PART

Shape of illumination: Ring

Lens material: Stainless steel

Illumination colour: Green

Lens optics: opaque

Lens shape: flush

Lens illumination: illuminative

Lens colour: Silver

ELECTRICAL CHARACTERISTICS

Operating voltage: 12 V AC/DC

Rated Operational Voltage U_e: 250 VAC

Pollution degree: 2, according to EN IEC 60947-1

Thermal current I_{th}: 5 A

Electric strength: 1500 VAC, 50 Hz 1 minute between life terminals and ground

Contacts: 1 C

Electrical lifetime:	50 000 cycles of operation		
Switching voltage and switching current:	according to IEC 60947-5-1 (Silver contacts) Service categorie AC-15 Voltage 24 VAC 35 VAC 110 VAC 220 VAC Switch rating DC service categorie DC-13 (Silver contacts) Voltage 24 VDC 35 VDC 110 VDC 220 VDC		
		Current	1 A
			1 A (M12 versio
			1 A
			0.5 A
		Current	0.7 A
			0.5 A (M12 vers
			0.2 A
			0.1 A
	according to UL 508 (Silver contacts) cos ϕ 0,75 ... 0,8 Voltage 120 VAC 240 VAC 24 VAC		
		Current	5 A
			3 A
			1 A

Rated insulation voltage Ui: 250 V

MECHANICAL CHARATERISTIC

Contact material:	Silver
Switching action:	Momentary
Switching system:	Snap-action switching element
Tightening torque:	0.5 ... 0.6 Nm, Screw terminal 0.1 Nm
Operating Travel:	ca. 3 mm
Mechanical lifetime:	1 Mio. cycles of operation
Terminal:	Screw terminal
Operating force:	4 N ... 7 N
Weight:	0.018 kg

AMBIENT CONDITION

Vibration resistance:	10 ... 500 Hz, amplitude 1.5 mm p-p according to IEC 60068-2-6
Shock resistance:	Max. 500 m / s ² as per IEC 60068-2-27
Operating temperature:	– 30 °C ... + 70 °C
Storage temperature:	– 40 °C ... + 80 °C
Climate resistance:	Damp heat, 21 days according to IEC 60512-11

CERTIFICATE

Approbations: CB, CCC, C UL, UL

Conformities: CE, 2011 / 65 / EC (RoHS), 2014 / 35 / EU (LVD)

OTHER

Kind of illumination: Single-LED

Short Description: Illuminated pushbutton Ø 16 mm silver contact, Momentary, 12 V AC/DC, 1 C, Screw terminal, Stainless steel, Green, Silver

Mounting cut-outs:

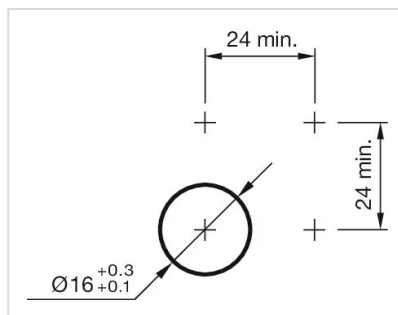

Dimension drawings:

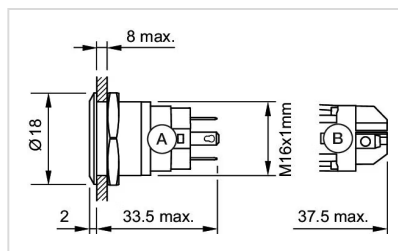

A = Solder terminal
B = Screw terminal

Component layouts:

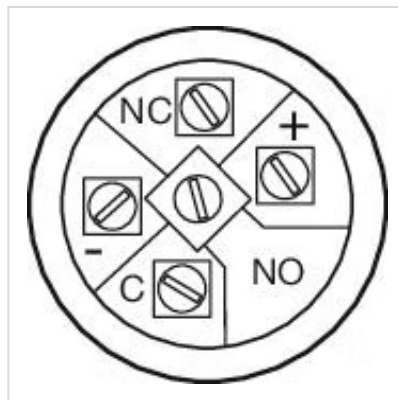

Wiring diagrams:

