

Illuminated pushbutton Ø 16 mm silver contact

82-4152.1114



<https://eao.com/p/82-4152.1114>

Your product:



82-4152.1114

Illuminated pushbutton Ø 16 mm silver contact

FRONT

Front bezel material: Stainless steel

MOUNTING

Mounting cut-out: Ø 16 mm

OPERATING-/INDICATION PART

Lens optics: opaque

Shape of illumination: Ring

Lens colour: Silver

Illumination colour: Red

Lens illumination: illuminative

Lens shape: flush

Lens material: Stainless steel

ELECTRICAL CHARACTERISTICS

Pollution degree: 2, according to EN IEC 60947-1

Rated insulation voltage U_i : 250 V

Contacts: 1 C

Operating voltage: 24 V AC/DC

Switching voltage and switching current:

according to IEC 60947-5-1 (Silver contacts)	
Service categorie AC-15	
Voltage	Current
24 VAC	1 A
35 VAC	1 A (M12 version)
110 VAC	1 A
220 VAC	0.5 A
Switch rating DC service categorie DC-13 (Silver contacts)	
Voltage	Current
24 VDC	0.7 A
35 VDC	0.5 A (M12 version)
110 VDC	0.2 A
220 VDC	0.1 A

according to UL 508 (Silver contacts)	
cosφ 0,75 ... 0,8	
Voltage	Current
120 VAC	5 A
240 VAC	3 A
24 VAC	1 A

Rated Operational Voltage Ue:	250 VAC
Thermal current Ith:	5 A
Electrical lifetime:	50 000 cycles of operation
Electric strength:	1500 VAC, 50 Hz 1 minute between life terminals and ground

MECHANICAL CHARACTERISTIC

Tightening torque:	0.5 ... 0.6 Nm, Screw terminal 0.1 Nm
Contact material:	Silver
Mechanical lifetime:	1 Mio. cycles of operation
Switching action:	Momentary
Operating force:	4 N ... 7 N
Operating Travel:	ca. 3 mm
Terminal:	Screw terminal
Weight:	0.018 kg
Switching system:	Snap-action switching element

AMBIENT CONDITION

Shock resistance:	Max. 500 m / s ² as per IEC 60068-2-27
Climate resistance:	Damp heat, 21 days according to IEC 60512-11
Operating temperature:	- 30 °C ... + 70 °C
Storage temperature:	- 40 °C ... + 80 °C
Vibration resistance:	

10 ... 500 Hz, amplitude 1.5 mm p-p according to IEC 60068-2-6

CERTIFICATE

Conformities: CE, 2011 / 65 / EC (RoHS), 2014 / 35 / EU (LVD)

Approbations: CB, CCC, C UL, UL

OTHER

Kind of illumination: Single-LED

Short Description: Illuminated pushbutton Ø 16 mm silver contact, Momentary, 24 V AC/DC, 1 C, Screw terminal, Stainless steel, Red, Silver

Dimension drawings:

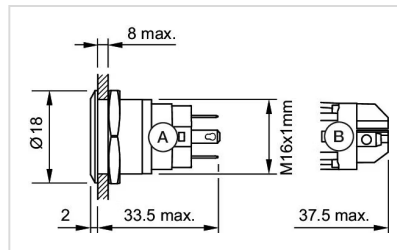

Wiring diagrams:

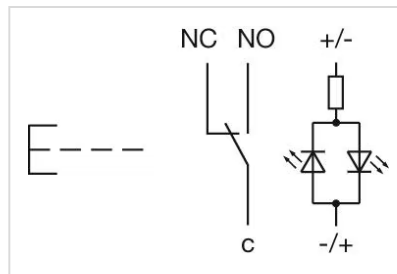

Mounting cut-outs:

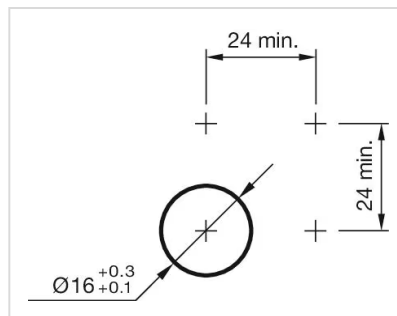

Component layouts:

