



Image may differ from product. See technical specification for details.

7013 CD/P4A

Super-precision, high-capacity, single row angular contact ball bearing

These super-precision, high-capacity, single row angular contact ball bearings, with 15° contact angle, accommodate radial and axial loads acting simultaneously, where the axial load acts in one direction only. They are designed to accommodate heavy loads at relatively high speeds under low to moderate operating temperatures.

- Very high running accuracy
- Very high load carrying capacity
- Relatively high speed and stiffness



Thanks for your interest in SKF super-precision bearings! We are constantly seeking to improve how we serve our site visitors with the best content and would be grateful if you can spare a moment to answer 3 short questions. Thank You!

[Next](#)

Overview

Dimensions

Bore diameter	65 mm
Outside diameter	100 mm
Width	18 mm
Contact angle	15 °

Properties

Contact type	Normal contact (two-point contact)
Number of rows	1
Ring type	One-piece inner and outer rings
Design	High-capacity D
Universal matching bearing	No
Matched arrangement	No
Matched condition (axial clearance/ preload)	Not applicable
Tolerance class	P4A
Material, bearing	Bearing steel
Coating	Without
Sealing	Without
Lubricant	None

Performance

Basic dynamic load rating	41.6 kN
Basic static load rating	37.5 kN
Attainable speed for grease lubrication	14 000 r/min
Attainable speed for oil-air lubrication	22 000 r/min

Logistics

Product net weight	0.42 kg
eClass code	23-05-08-04
UNSPSC code	31171531

Thanks for your interest in SKF super-precision bearings! We are constantly seeking to improve how we serve our site visitors with the best content and would be grateful if you can spare a moment to answer 3 short questions. Thank You!

Universal matching bearing(s)

No

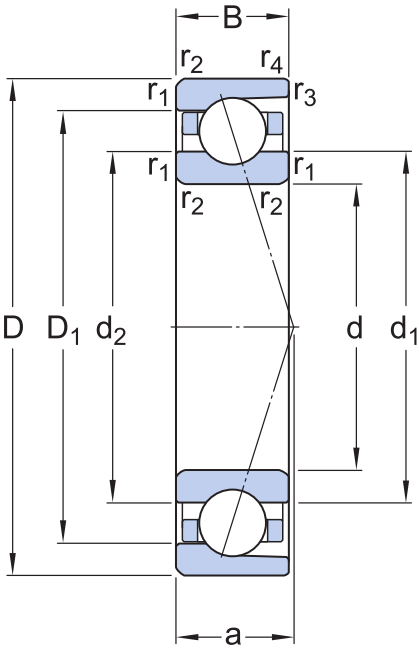

Dimensions

d	65 mm	Bore diameter
D	100 mm	Outside diameter
B	18 mm	Width
d ₁	75.8 mm	Shoulder diameter of inner ring (large side face)
d ₂	75.8 mm	Shoulder diameter of inner ring (small side face)
D ₁	89.2 mm	Shoulder diameter of outer ring (large side face)
r _{1,2}	min. 1.1 mm	Chamfer dimension
r _{3,4}	min. 0.6 mm	Chamfer dimension
a	20.1 mm	Distance from side face to pressure point

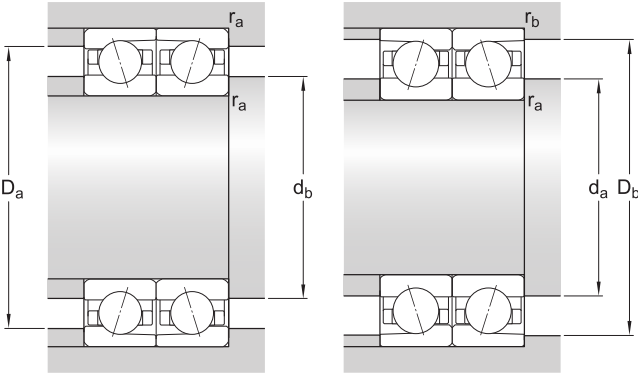

Abutment dimensions

d _a	min. 71 mm	Diameter of shaft abutment
d _b	min. 71 mm	Diameter of shaft abutment
D _a	max. 94 mm	Diameter of housing abutment
D _b	max. 96.8 mm	Diameter of housing abutment
r _a	max. 1 mm	Radius of fillet
r _b	max. 0.6 mm	Radius of fillet

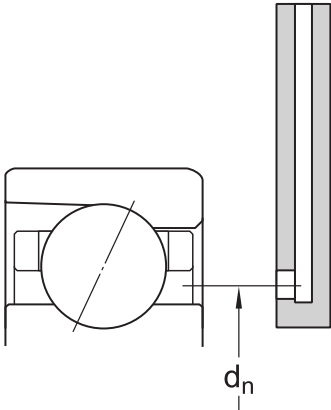

Thanks for your interest in SKF super-precision bearings! We are constantly seeking to improve how we serve our site visitors with the best content and would be grateful if you can spare a moment to answer 3 short questions. Thank You!

Basic dynamic load rating	C	41.6 kN
Basic static load rating	C ₀	37.5 kN
Fatigue load limit	P _u	1.6 kN
Attainable speed for grease lubrication		14 000 r/min
Attainable speed for oil-air lubrication		22 000 r/min
Contact angle	α	15 °
Ball diameter	D _w	11.112 mm
Number of rows	i	1
Number of balls (per bearing)	z	20
Reference grease quantity (per bearing)	G _{ref}	5.7 cm ³

PRELOAD AND STIFFNESS (BACK-TO-BACK, FACE-TO-FACE)

Preload, class A	G _A	160 N
Axial stiffnes for preload A (sets of two brgs back to back or face to face)		74 N/μm
Preload, class B	G _B	320 N
Axial stiffness for preload B (sets of two brgs back-to-back or face-to-face)		101 N/μm
Preload, class C	G _C	640 N
Axial stiffness for preload C (sets of two brgs back-to-back or face-to-face)		143 N/μm
Preload, class D	G _D	1 280 N
Axial stiffness for preload D (sets of two brgs back-to-back or face-to-face)		207 N/μm

CORRECTION FACTORS FOR PRELOAD CALCULATION

Correction factor dependent on bearing series and size	f	1.13
Correction factor dependent on contact angle	f ₁	1
Correction factor, preload class A	f _{2A}	1
Correction factor, preload class B	f _{2B}	1.02
Correction factor, preload class C	f _{2C}	1.05

Thanks for your interest in SKF super-precision bearings! We are constantly seeking to improve how we serve our site visitors with the best content and would be grateful if you can spare a moment to answer 3 short questions. Thank You!

Correction factor, preload class D	f_{2D}	1.09
Correction factor for hybrid bearings	f_{HC}	1

FACTORS FOR EQUIVALENT BEARING LOAD CALCULATION

Calculation factor for equivalent loads	f_0	15.6
Additional factors for equivalent loads	Refer to Notes 1 and 2 below	

Mass

Mass	0.43 kg
------	---------

Compatible products

Aftermarket replacement

Super-precision, high-capacity, universally matchable single row angular contact ball bearing	7013 CDGA/P4A
---	-------------------------------

Thanks for your interest in SKF super-precision bearings! We are constantly seeking to improve how we serve our site visitors with the best content and would be grateful if you can spare a moment to answer 3 short questions. Thank You!